

F.A. RTE.	SECTION	COUNTY	TOTAL SHEETS	SHEET NO.
55	2006-032 BY	WILL	505	31
STA. 667+00		TO STA. 697+00		
FED. ROAD DIST. NO. 1		ILLINOIS FED. AID PROJECT		
ALIGN-06 OF 16				

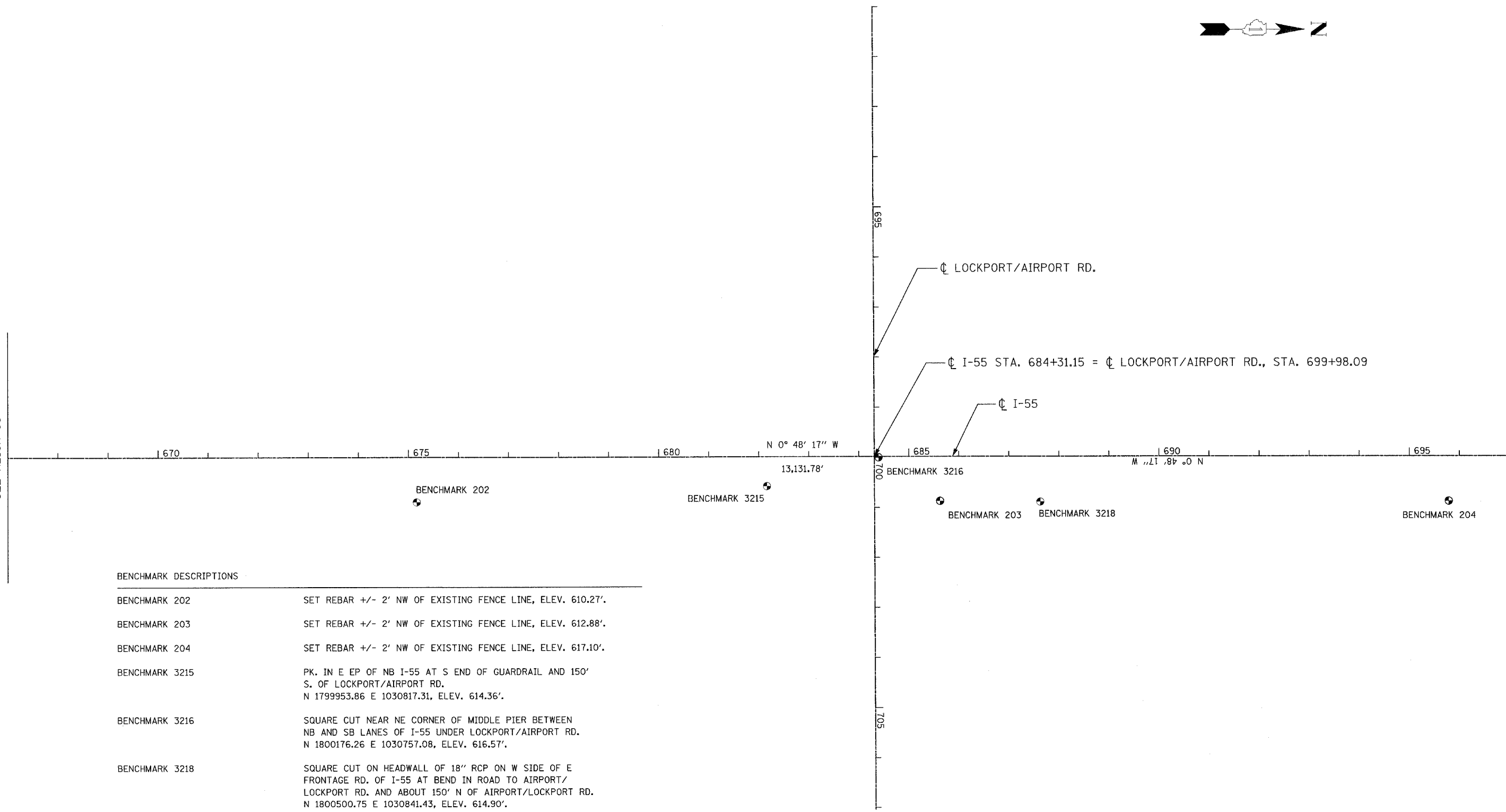

MATCH LINE STA. 667+00
SEE ALIGN-05

MATCH LINE STA. 697+00
SEE ALIGN-07



BENCHMARK DESCRIPTIONS

BENCHMARK 202	SET REBAR +/- 2' NW OF EXISTING FENCE LINE, ELEV. 610.27'.
BENCHMARK 203	SET REBAR +/- 2' NW OF EXISTING FENCE LINE, ELEV. 612.88'.
BENCHMARK 204	SET REBAR +/- 2' NW OF EXISTING FENCE LINE, ELEV. 617.10'.
BENCHMARK 3215	PK. IN E EP OF NB I-55 AT S END OF GUARDRAIL AND 150' S. OF LOCKPORT/AIRPORT RD. N 1799953.86 E 1030817.31, ELEV. 614.36'.
BENCHMARK 3216	SQUARE CUT NEAR NE CORNER OF MIDDLE PIER BETWEEN NB AND SB LANES OF I-55 UNDER LOCKPORT/AIRPORT RD. N 1800176.26 E 1030757.08, ELEV. 616.57'.
BENCHMARK 3218	SQUARE CUT ON HEADWALL OF 18" RCP ON W SIDE OF E FRONTAGE RD. OF I-55 AT BEND IN ROAD TO AIRPORT/LOCKPORT RD. AND ABOUT 150' N OF AIRPORT/LOCKPORT RD. N 1800500.75 E 1030841.43, ELEV. 614.90'.

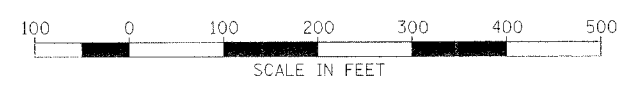

REVISIONS	
NAME	DATE

ILLINOIS DEPARTMENT OF TRANSPORTATION
 FAI ROUTE 55
 US 30 (PLAINFIELD ROAD) TO LILY CACHE SLOUGH

ALIGNMENT, TIES AND BENCHMARKS

SCALE: 1"=100'
 DATE: 06-30-06

DRAWN BY ALR
 CHECKED BY RH