

F.A.P. RTE.	SECTION	COUNTY	TOTAL SHEETS	SHEET NO.
55	2006-032 BY	WILL	505	59
STA. 622+00		TO STA. 637+00		
FED. ROAD DIST. NO. 1		ILLINOIS FED. AID PROJECT		
		PLN-04 OF 11		

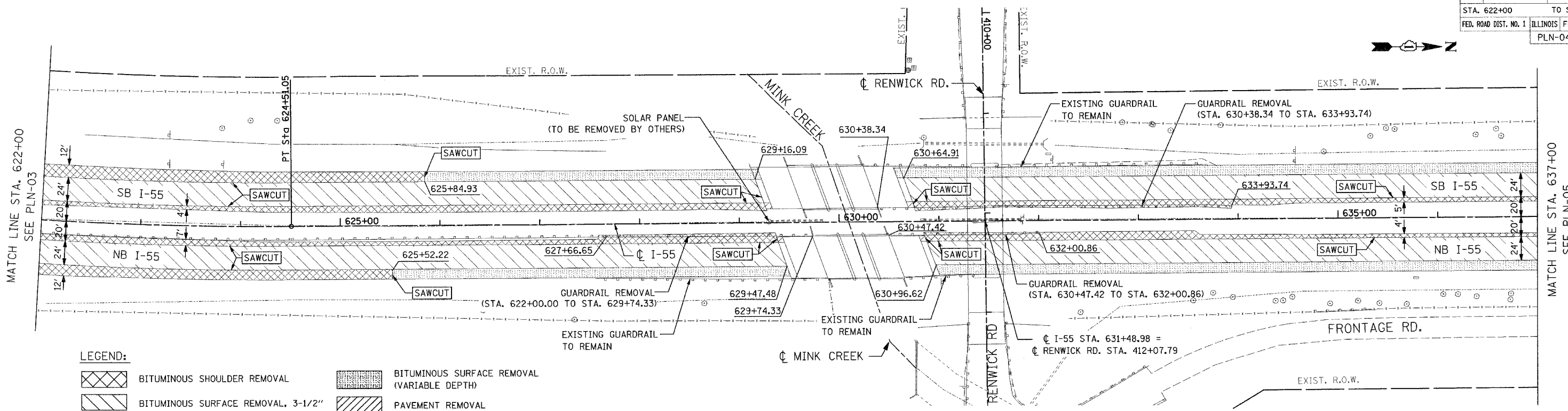

LEGEND:

- BITUMINOUS SHOULDER REMOVAL
- BITUMINOUS SURFACE REMOVAL, 3-1/2"
- BITUMINOUS SURFACE REMOVAL (VARIABLE DEPTH)
- PAVEMENT REMOVAL

EXISTING CONDITION

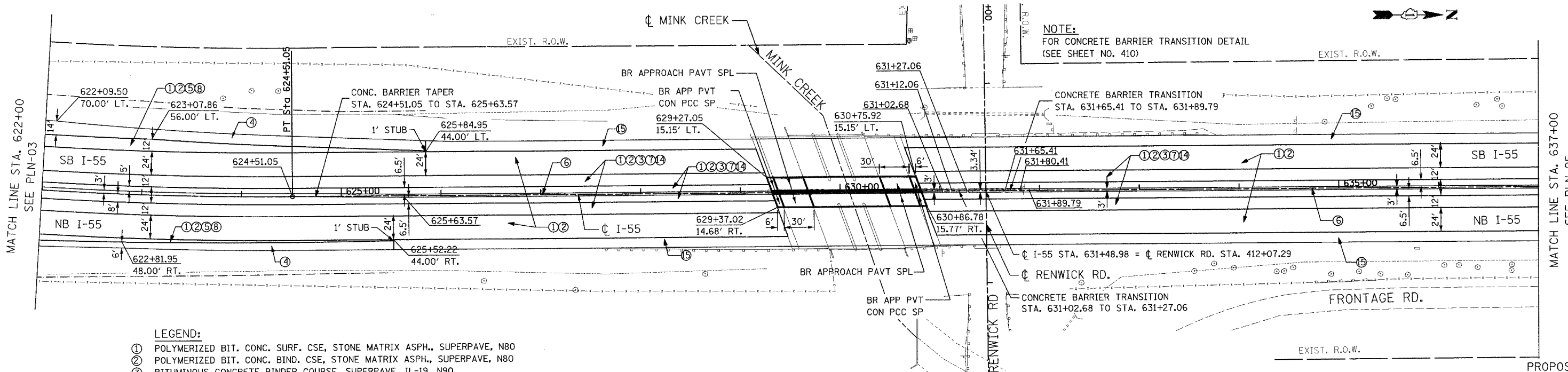

LEGEND:

- ① POLYMERIZED BIT. CONC. SURF. CSE, STONE MATRIX ASPH., SUPERPAVE, N80
- ② POLYMERIZED BIT. CONC. BIND. CSE, STONE MATRIX ASPH., SUPERPAVE, N80
- ③ BITUMINOUS CONCRETE BINDER COURSE, SUPERPAVE, IL-19, N90
- ④ BITUMINOUS CONCRETE BINDER COURSE, SUPERPAVE, IL-19, N70
- ⑤ P.C.C. BASE COURSE, 10-1/2"
- ⑥ CONCRETE BARRIER DOUBLE FACE, 42" HEIGHT
- ⑦ AGGREGATE SUBGRADE, 12"
- ⑧ SUB-BASE GRANULAR MATERIAL, TYPE B, 6"
- ⑨ BITUMINOUS BASE COURSE, SUPERPAVE, N50, 2-1/2"
- ⑩ BITUMINOUS CONCRETE SURFACE COURSE, SUPERPAVE, MIX "D", N70

NOTE:
FOR MINK CREEK BRIDGE DETAILS
(SEE SHEET NO. 374 TO SHEET NO. 389)

REVISIONS	
NAME	DATE
M. HALDEMAN	07/28/06

ILLINOIS DEPARTMENT OF TRANSPORTATION
FAI ROUTE 55
US 30 (PLAINFIELD ROAD) TO LILY CACHE SLOUGH

EXISTING AND PROPOSED
ROADWAY PLAN

SCALE: 1" = 50'
DATE: 07-21-06
DRAWN BY: ALR
CHECKED BY: DM

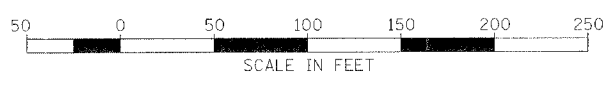

PROPOSED CONDITION

FINAL