

F.A. RTE.	SECTION	COUNTY	TOTAL SHEETS	SHEET NO.
55	2006-032 BY	WILL	505	92
STA. 787+00	TO STA. 802+00			
FED. ROAD DIST. NO. ILLINOIS FED. AID PROJECT				

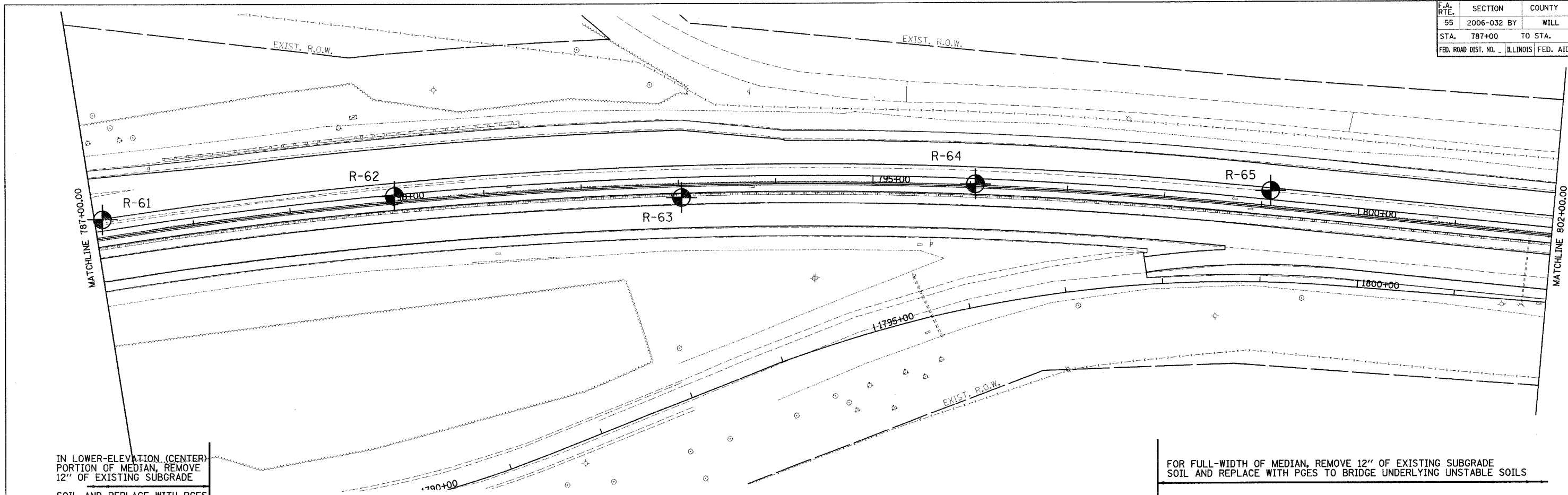

IN LOWER-ELEVATION (CENTER) PORTION OF MEDIAN, REMOVE 12" OF EXISTING SUBGRADE SOIL AND REPLACE WITH PGES TO BRIDGE UNDERLYING UNSTABLE SOILS

FOR FULL-WIDTH OF MEDIAN, REMOVE 12" OF EXISTING SUBGRADE SOIL AND REPLACE WITH PGES TO BRIDGE UNDERLYING UNSTABLE SOILS

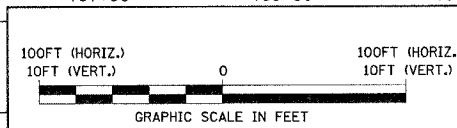
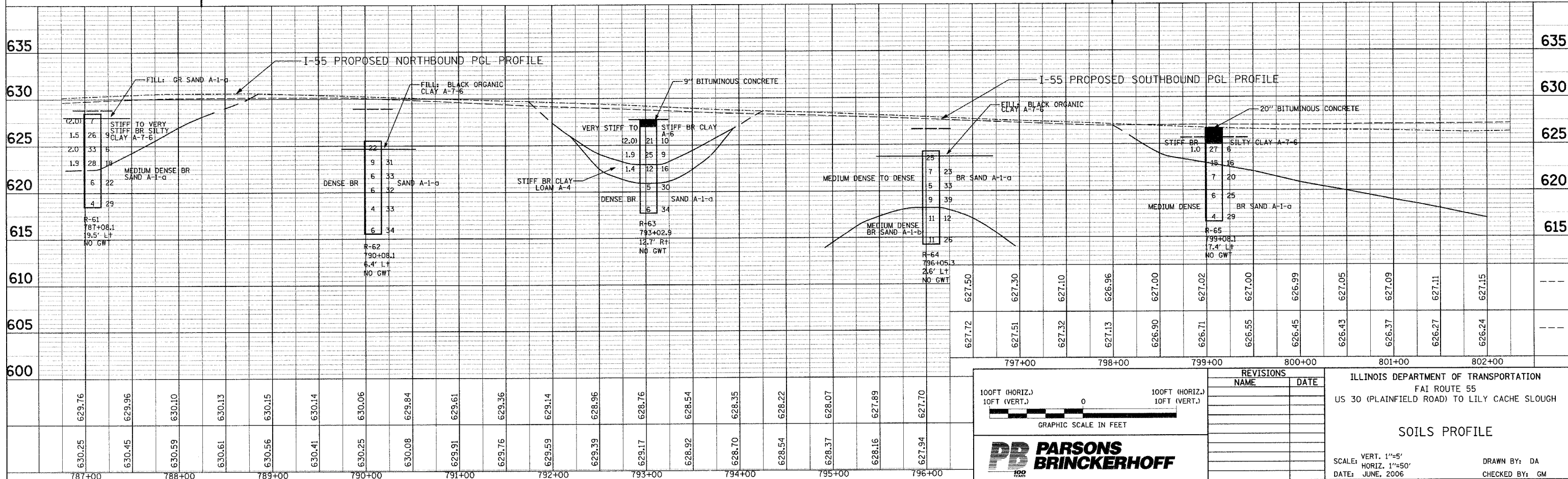

REVISIONS	NAME	DATE

ILLINOIS DEPARTMENT OF TRANSPORTATION
 FAI ROUTE 55
 US 30 (PLAINFIELD ROAD) TO LILY CACHE SLOUGH

SOILS PROFILE

SCALE: VERT. 1"=5'
 HORIZ. 1"=50'
 DATE: JUNE, 2006

DRAWN BY: DA
 CHECKED BY: GM