

F.A. RTE.	SECTION	COUNTY	TOTAL SHEETS	SHEET NO.
55	2006-032 BY	WILL	505	99
STA. 892+00 TO STA. 907+00		FED. AID PROJECT		

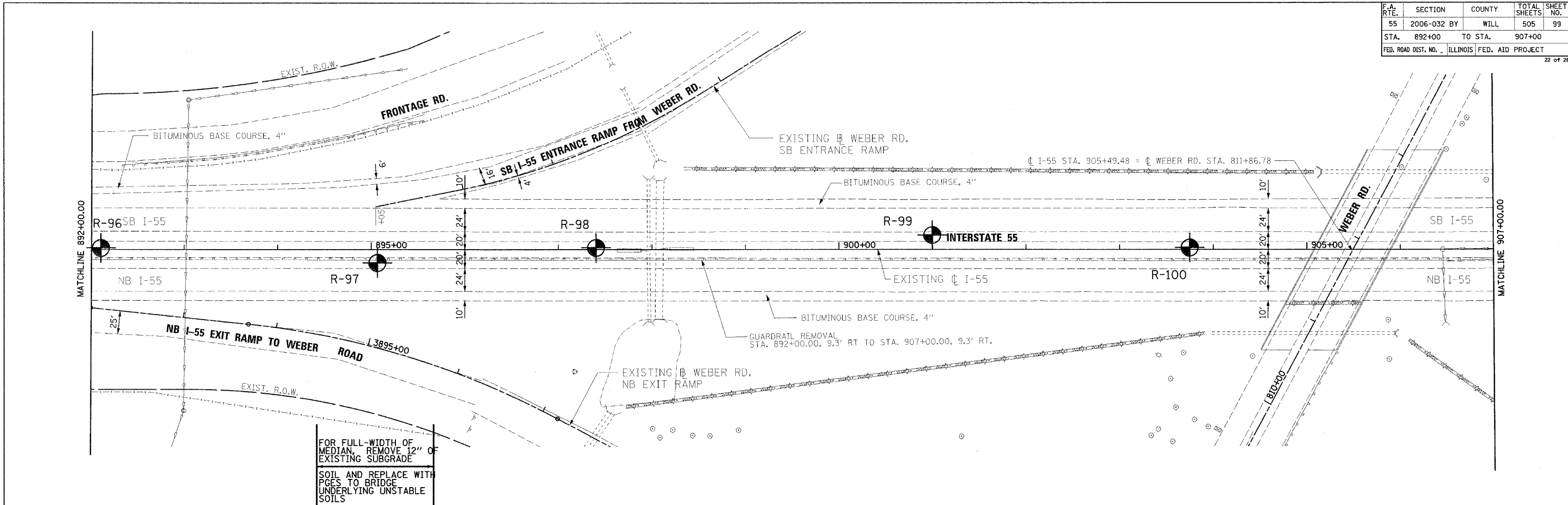

FOR FULL-WIDTH OF MEDIAN, REMOVE 12" OF EXISTING SUBGRADE SOIL AND REPLACE WITH PGES TO BRIDGE UNDERLYING UNSTABLE SOILS

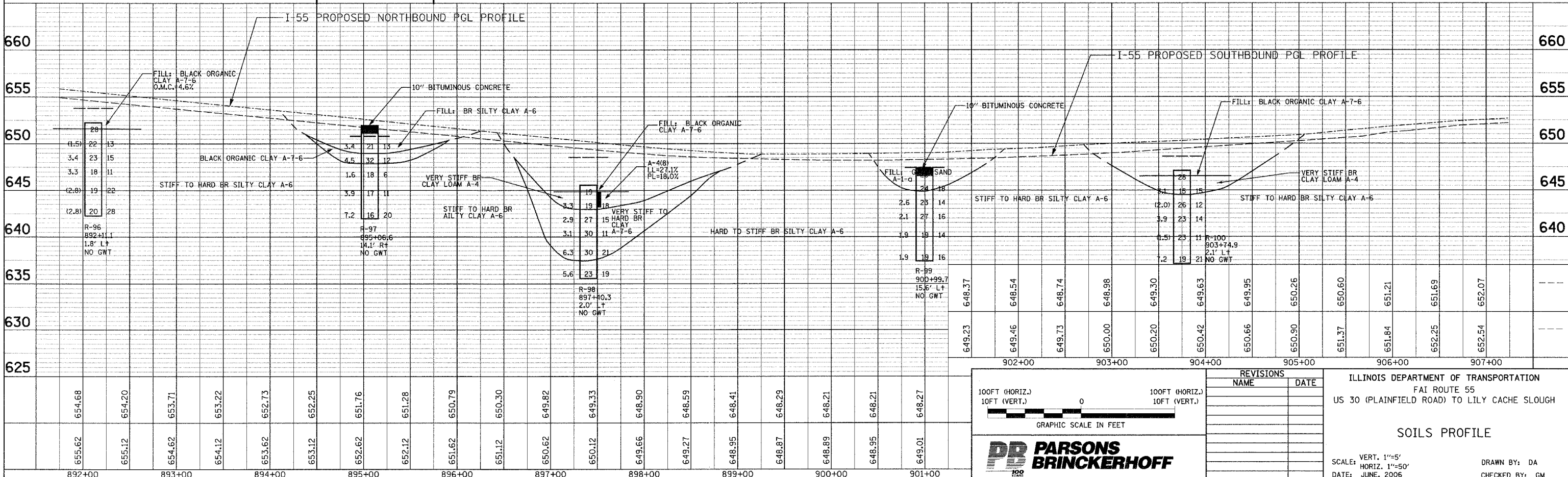

100FT (HORIZ.)  
10FT (VERT.)

GRAPHIC SCALE IN FEET

**PARSONS BRINCKERHOFF**

ILLINOIS DEPARTMENT OF TRANSPORTATION  
FAI ROUTE 55  
US 30 (PLAINFIELD ROAD) TO LILY CACHE SLOUGH

SOILS PROFILE

SCALE: VERT. 1"=5'  
HORIZ. 1"=50'  
DATE: JUNE, 2006

DRAWN BY: DA  
CHECKED BY: GM