

F.A.P. RTE.	SECTION	COUNTY	TOTAL SHEETS	SHEET NO.
55	2006-032 BY	WILL	505	104
STA.		TO STA.		
FED. ROAD DIST. NO.		ILLINOIS	FED. AID PROJECT	
		MOT-TYP-03 OF 05		

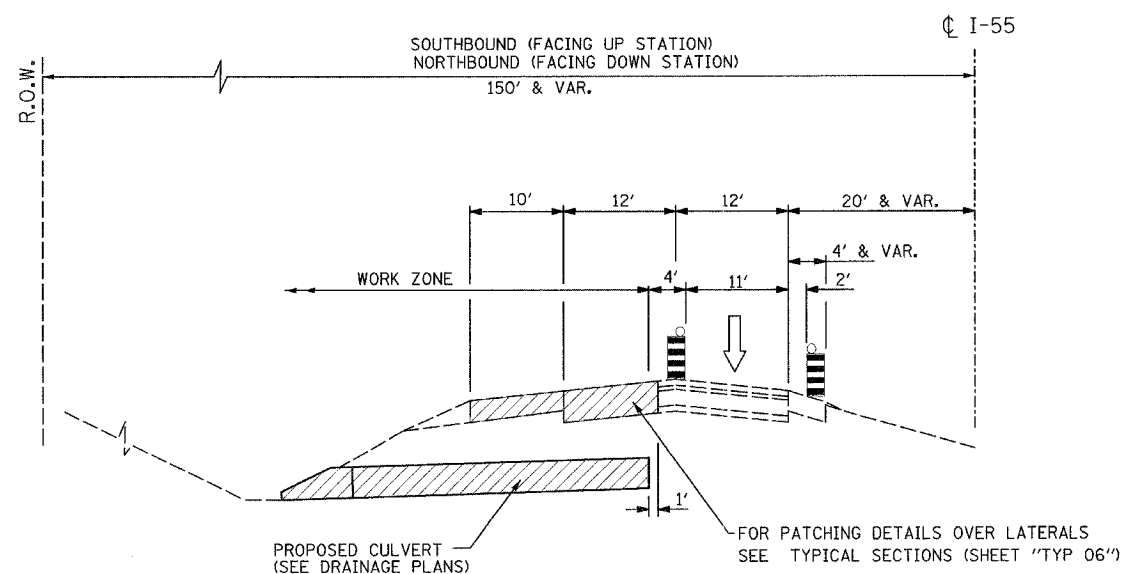

PRE-STAGE, PHASE I  
STORM SEWER LATERALS CONSTRUCTION

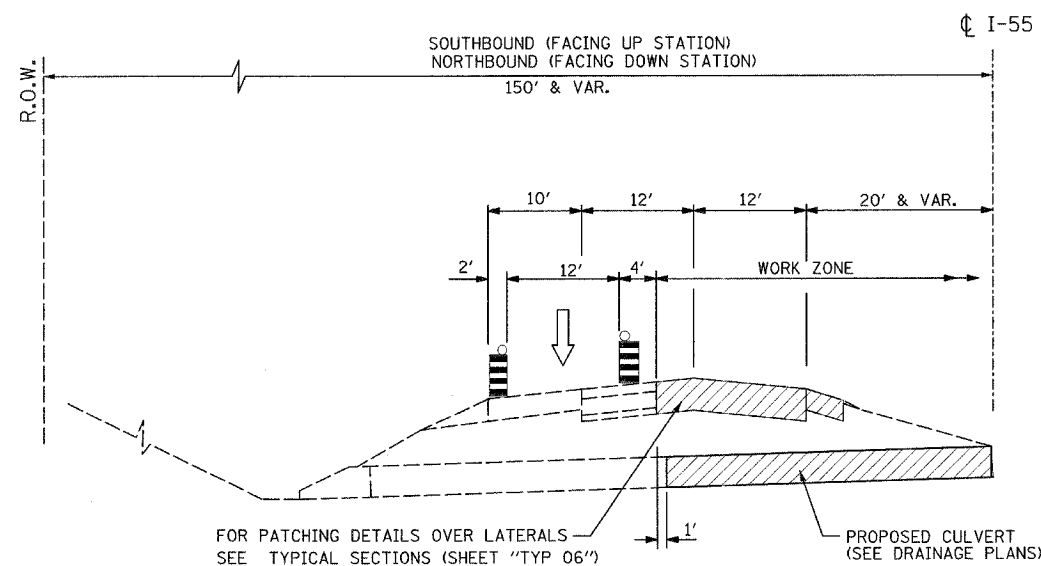

PRE-STAGE, PHASE II  
STORM SEWER LATERALS CONSTRUCTION

LEGEND

- ① PVMT MARKING TAPE, TYPE III 4" (WHITE)
- ② PVMT MARKING TAPE, TYPE III 5" SKIP-DASH (30FT/10FT)
- ③ PVMT MARKING TAPE, TYPE III 4" (YELLOW)
- ④ BITUMINOUS CONCRETE SURFACE COURSE, SUPERPAVE, MIX "D", N90, 1 3/4"
- ⑤ BITUMINOUS BASE COURSE, SUPERPAVE, N90, 10 1/4"
- ⑥ EXISTING AGGREGATE SHOULDER
- ⑦ AGGREGATE SHOULDER, TYPE B
- ▨ VERTICAL PANELS OR VERTICAL BARRICADES AT 100' IN CURVES AND 200' IN TANGENTS
- ⊞ DRUMS W/ STEADY BURN LIGHTS AT 50' C-C IN TAPERS AND 100' C-C IN TANGENTS
- ▨ WORK ZONE
- ↑ TRAFFIC FLOW ARROW
- ⚡ TEMPORARY CONCRETE BARRIER

NOTE:  
STORM SEWER LATERAL CONSTRUCTION SHALL BE COMPLETED DURING OFF-PEAK HOURS AS APPROVED BY THE ENGINEER. HIGHWAY STANDARDS 701400 AND 701404 SHALL APPLY.

PRE-STAGE

REVISIONS	
NAME	DATE
D. MELNIK	08/01/06

ILLINOIS DEPARTMENT OF TRANSPORTATION  
FAI ROUTE 55  
US 30 (PLAINFIELD ROAD) TO LILY CACHE SLOUGH

SUGGESTED STAGES OF  
CONSTRUCTION AND TRAFFIC  
CONTROL GENERAL NOTES

SCALE: NONE  
DATE: 06-30-06

DRAWN BY: DM  
CHECKED BY: DVS

