

F.A.I. RTE.	SECTION	COUNTY	TOTAL SHEETS	SHEET NO.
55	2006-032 BY	WILL	505	203
STA.	TO STA.			
FED. ROAD DIST. NO.	ILLINOIS FED. AID PROJECT			

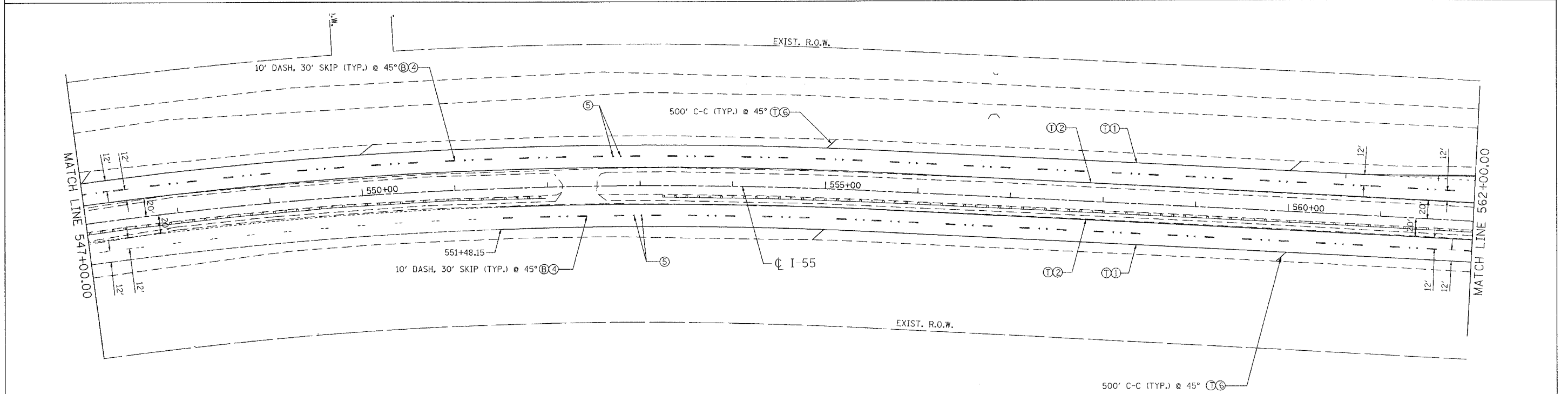

PAVEMENT MARKING LEGEND

- | | | |
|-------------------------------------|--|-----------------------------|
| ① PAVEMENT MARKING LINE 4" (WHITE) | ⑥ PAVEMENT MARKING LINE 12" (WHITE) | Ⓣ THERMOPLASTIC (EXTRUDED) |
| ② PAVEMENT MARKING LINE 4" (YELLOW) | ⑦ PAVEMENT MARKING LINE 12" (YELLOW) | Ⓟ POLYUREA |
| ③ PAVEMENT MARKING LINE 8" (WHITE) | ⑧ RAISED REFLECTIVE PAVEMENT MARKER (SINGLE, ONE-WAY, CRYSTAL MARKERS @ 40' C-C) | Ⓟ PREFORMED PLASTIC, TYPE B |
| ④ PAVEMENT MARKING LINE 5" (WHITE) | ⑨ RAISED REFLECTIVE PAVEMENT MARKER (DOUBLE, ONE-WAY, CRYSTAL MARKERS @ 80' C-C) | |

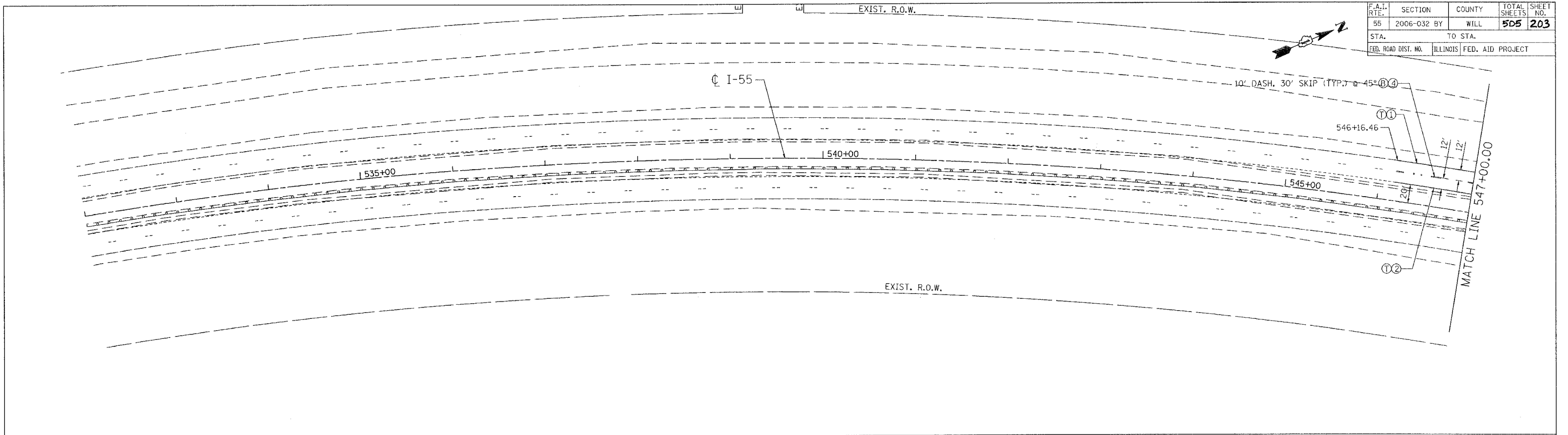

DATE 06/22/2006
EXP. 11/30/2007

MORCOM, N.V., INC.
CONSULTING ENGINEERS
CHICAGO, ILLINOIS

REVISIONS	
NAME	DATE

ILLINOIS DEPARTMENT OF TRANSPORTATION
FAI ROUTE 55
US 30 (PLAINFIELD ROAD) TO LILY CACHE SLOUGH

PAVEMENT MARKING AND SIGNING PLANS
FAI 55
STA. 532+00.00 TO STA. 562+00.00

SCALE: 1"=50'
DATE 07/05/06
DRAWN BY MW
CHECKED BY DDH

TENG
TENG & ASSOCIATES, INC.
ENGINEERS/ARCHITECTS/PLANNERS
CHICAGO, ILLINOIS

PLOT DATE = 07/05/06
 FILE NAME = MFILE
 PLOT SCALE = AS SHOWN
 USER NAME = MURPHY