

F.A.P. RTE.	SECTION	COUNTY	TOTAL SHEETS	SHEET NO.
55	2006-032 BY	WILL	\$TOT\$	252
STA.		TO STA.		
FED. ROAD DIST. NO. ILLINOIS FED. AID PROJECT				
P-XX-XXX-XX				

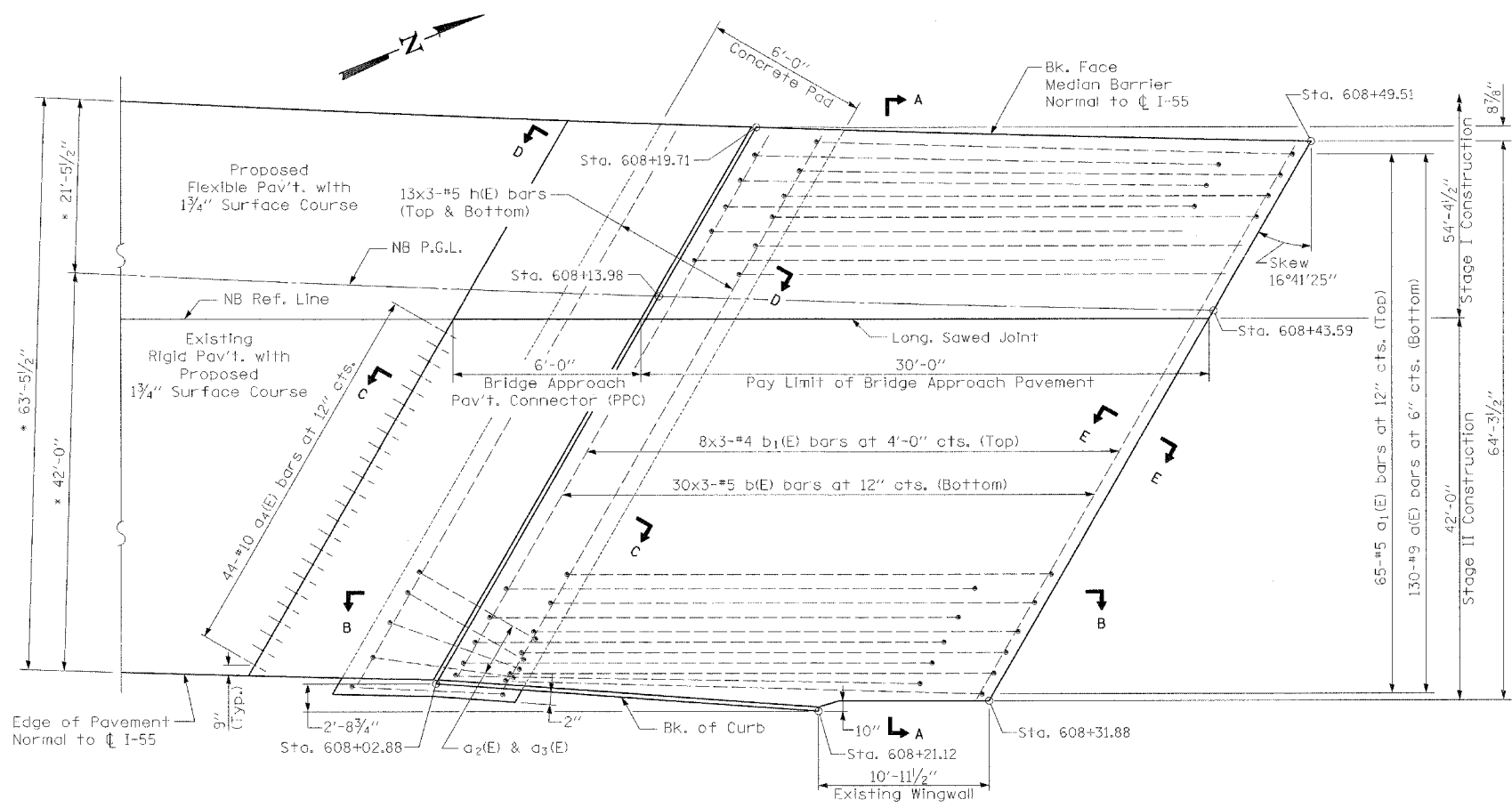

**I-55 OVER EJ&E R.R.
SOUTH BRIDGE APPROACH PAVEMENT PLAN**
(See Section A-A for Dimensions not shown)

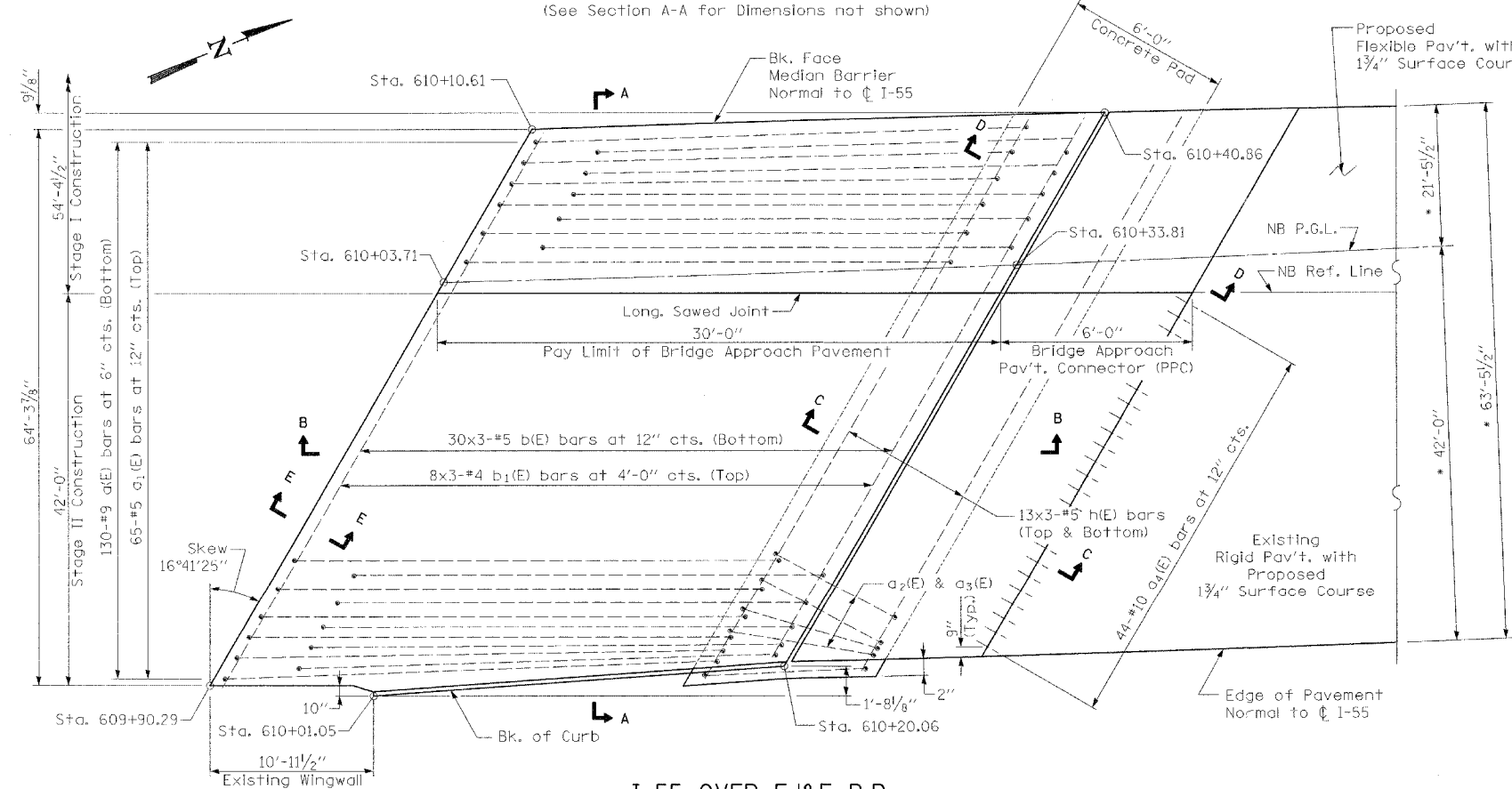

**I-55 OVER EJ&E R.R.
NORTH BRIDGE APPROACH PAVEMENT PLAN**
(See Section A-A for Dimensions not shown)

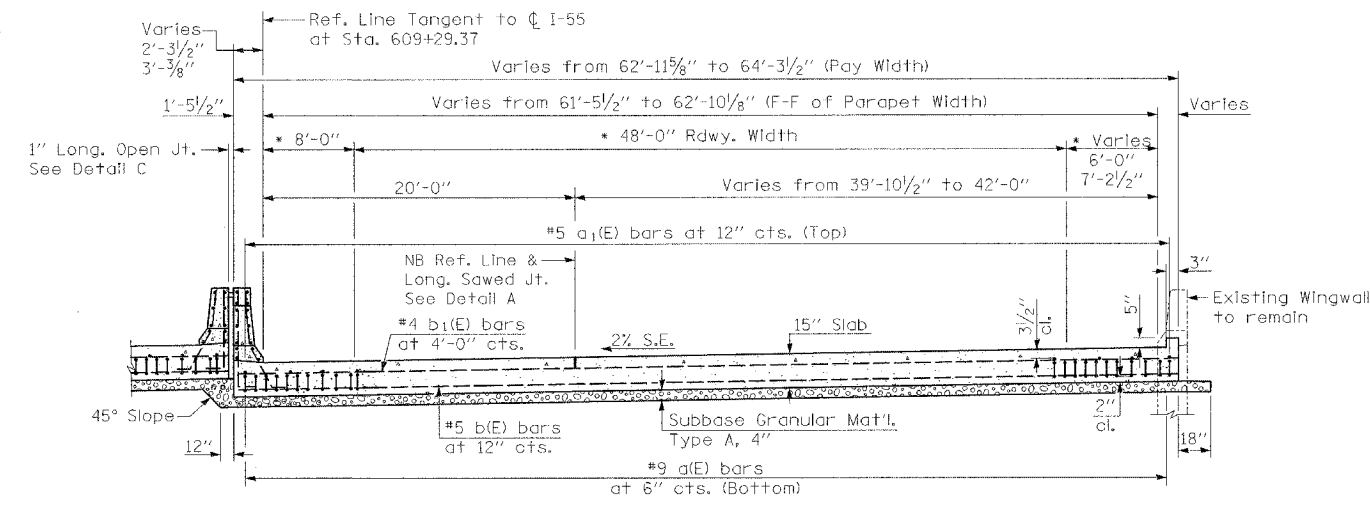

SECTION A-A - SOUTH END
* Designates radial dimensions normal to C I-55

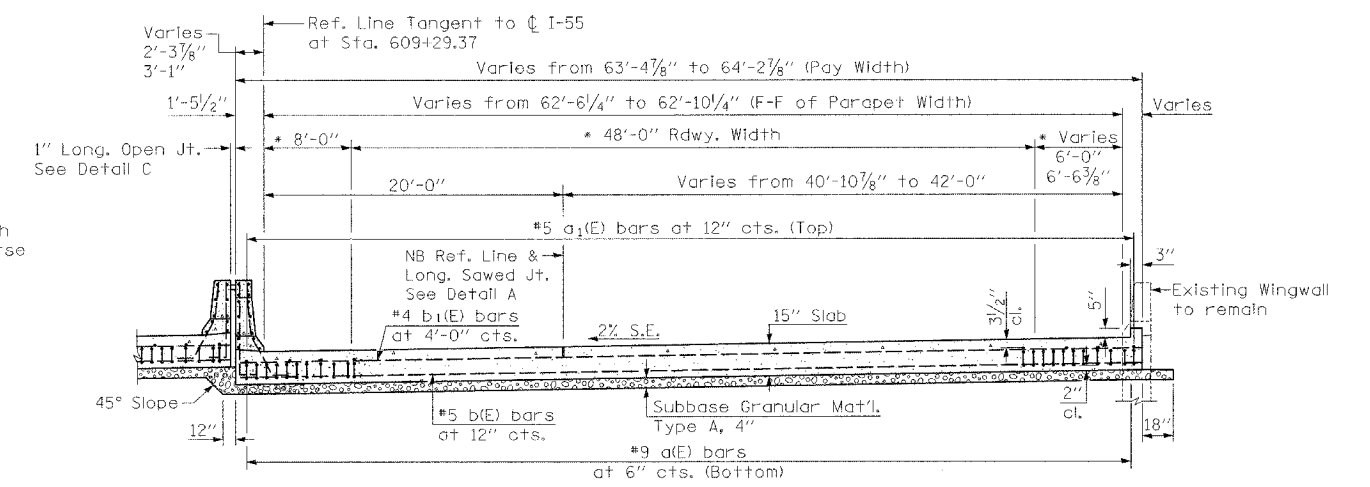

SECTION A-A - NORTH END
* Designates radial dimensions normal to C I-55

GENERAL NOTES

- THICKNESS--"t"=Thickness of Pavement.
- For Profiles, see Roadway Plans.
- For Wingwall Details, See Bridge Plans.
- If two or more lane widths are poured at a time, a longitudinal sawed joint may be used at the lane edges. See Detail A.
- Reinforcement Bars designated "E" shall be Epoxy Coated.
- Approach Pavement Concrete Median Barriers shall be constructed and paid for in accordance with Sections 503 and 508 of the IDOT Standard Specifications.
- Protective Coat shall be applied to the Top and Traffic Faces of the Median Barriers.

DESIGN STRESSES

fy = 60,000 P.S.I.
fc = 3,500 P.S.I.
n = 8.5

REVISIONS	
NAME	DATE

ILLINOIS DEPARTMENT OF TRANSPORTATION
FAI ROUTE 55
US 30 (PLAINFIELD ROAD) TO LILY CACHE SLOUGH
I-55 OVER EJ&E R.R.
NB BRIDGE APPROACH PAVEMENT
PLAN & SECTIONS
STANDARD 420401 (SPECIAL)
SCALE: NONE DRAWN BY SBC
DATE: 06-30-06 CHECKED BY JOZ

