

F.A. RTE.		SECTION		COUNTY		TOTAL SHEETS		SHEET NO.	
55		2006-032 BY		WIL-L		505		419A	
STA.				TO STA.					
FED. ROAD DIST. NO.		ILLINOIS		FED. AID PROJECT					

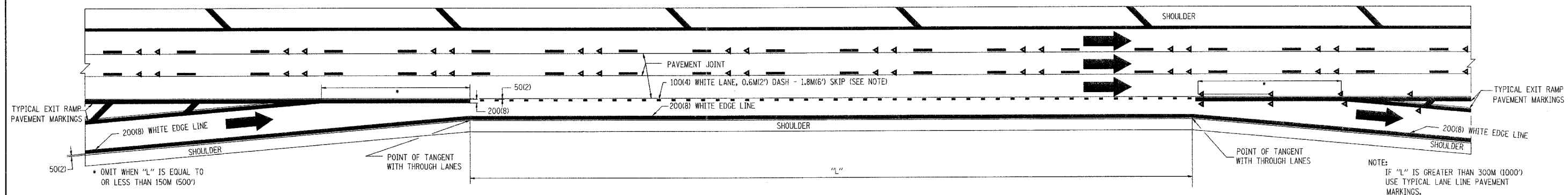

**TYPICAL ENTRANCE/EXIT RAMP COMBINATION PAVEMENT MARKINGS**

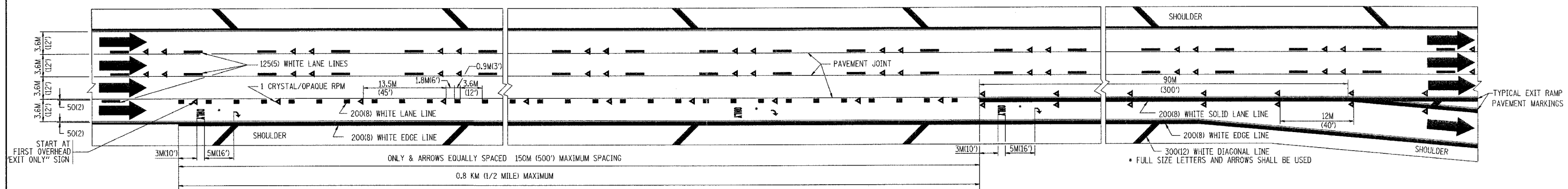

**TYPICAL EXIT ONLY LANE PAVEMENT MARKINGS**

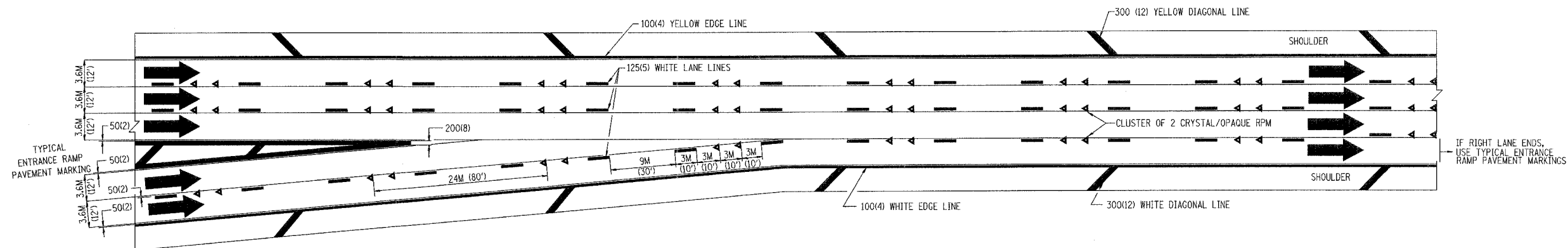

**TYPICAL TWO LANE ENTRANCE RAMP PAVEMENT MARKINGS**

PLOT DATE = 3/1/2006  
 FILE NAME = K:\dwt\p01\p012.dgn  
 PLOT SCALE = 5/8"=1' IN.  
 USER NAME = jaygo

REVISIONS	
NAME	DATE
DWS	1/90
DWS	5/91

ILLINOIS DEPARTMENT OF TRANSPORTATION  
**MULTI-LANE FREEWAY  
 PAVEMENT MARKING  
 DETAILS**

SCALE: NONE  
 DATE: 3/1/2006

DRAWN BY C.A.D.D.  
 CHECKED BY