

F.A.I.	SECTION	COUNTY	TOTAL SHEETS	SHEET NO.
94/90	*	COOK	565	77
STA.		TO STA.		
FED. ROAD DIST. NO.	ILLINOIS	FED. AID PROJECT		

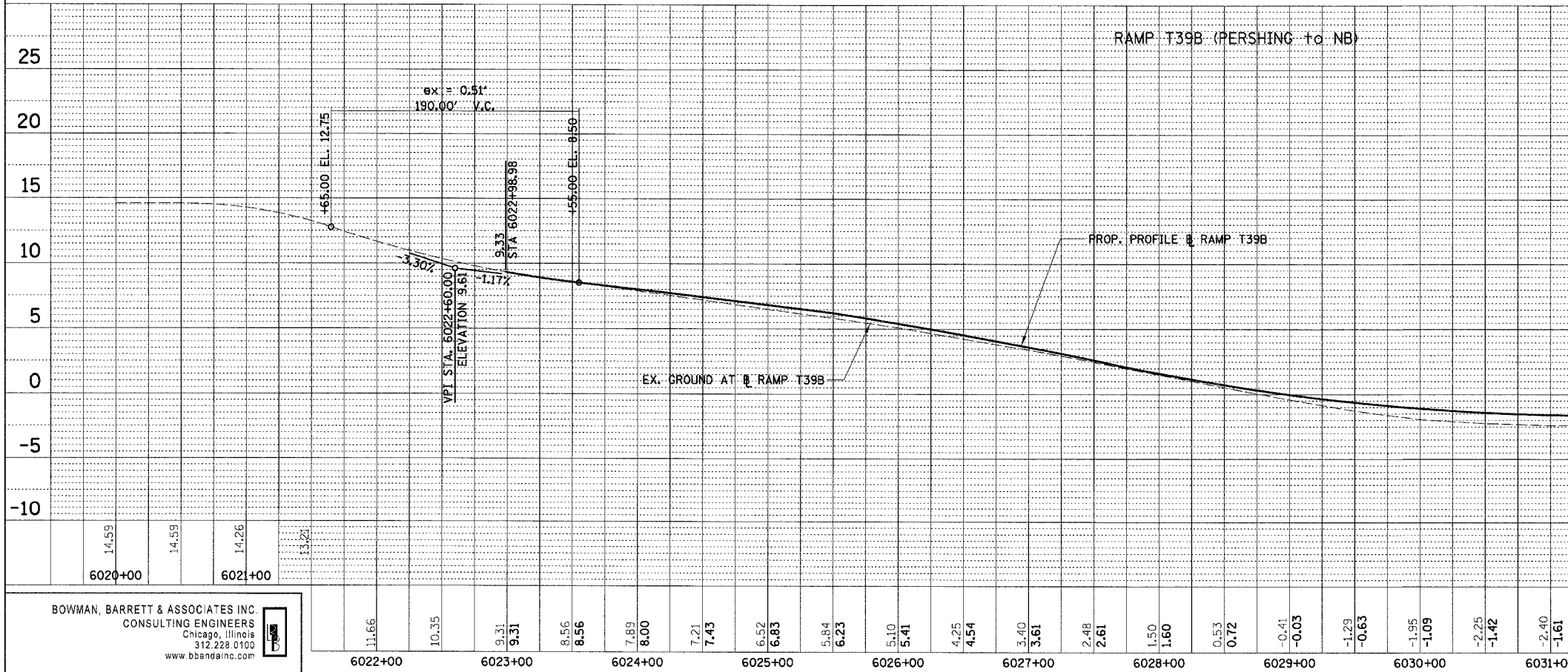
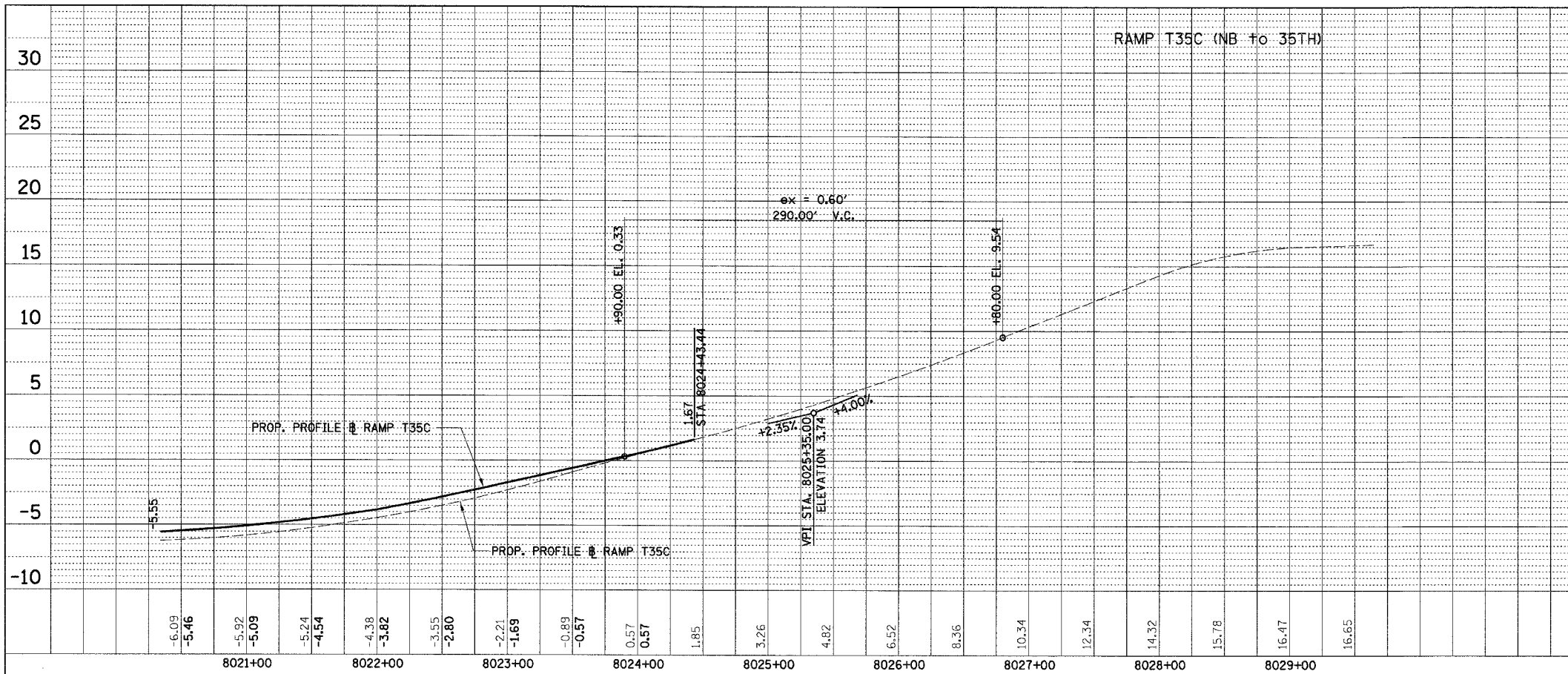

PLAN	DATE	BY
REVISION		
NOTE BOOK		
ALIGNMENT CHECKED		
PROF. FILE NAME		

PLAN	DATE	BY
REVISION		
NOTE BOOK		
ALIGNMENT CHECKED		
PROF. FILE NAME		

BOWMAN, BARRETT & ASSOCIATES INC.
CONSULTING ENGINEERS
Chicago, Illinois
312.228.0100
www.bbnaandinc.com

6032+00	6033+00	PRO-12
ILLINOIS DEPARTMENT OF TRANSPORTATION		
F.A.I. 94/90 (DAN RYAN EXPRESSWAY)		
GARFIELD BLVD TO 31ST STREET (NB LOCAL LANES)		
PROFILES - RAMPS T35C AND T39B		
1" = 5' VERT		
SCALE: 1 1/2" = 50' HORIZ		
DATE: 06/09/06		
DRAWN BY: JDC		CHECKED BY: RS

R:\62301\DWG\PROFILES\62301-77.DWG 5/7/2006 12:29:49 PM