

F.A.I.	SECTION	COUNTY	TOTAL SHEETS	SHEET NO.
94/90	*	COOK	565	92
STA.	TO STA.			
FED. ROAD DIST. NO.	ILLINOIS	FED. AID PROJECT		
62301	(2021-922 PT2 ETC	2324.6-1P)	R-10	

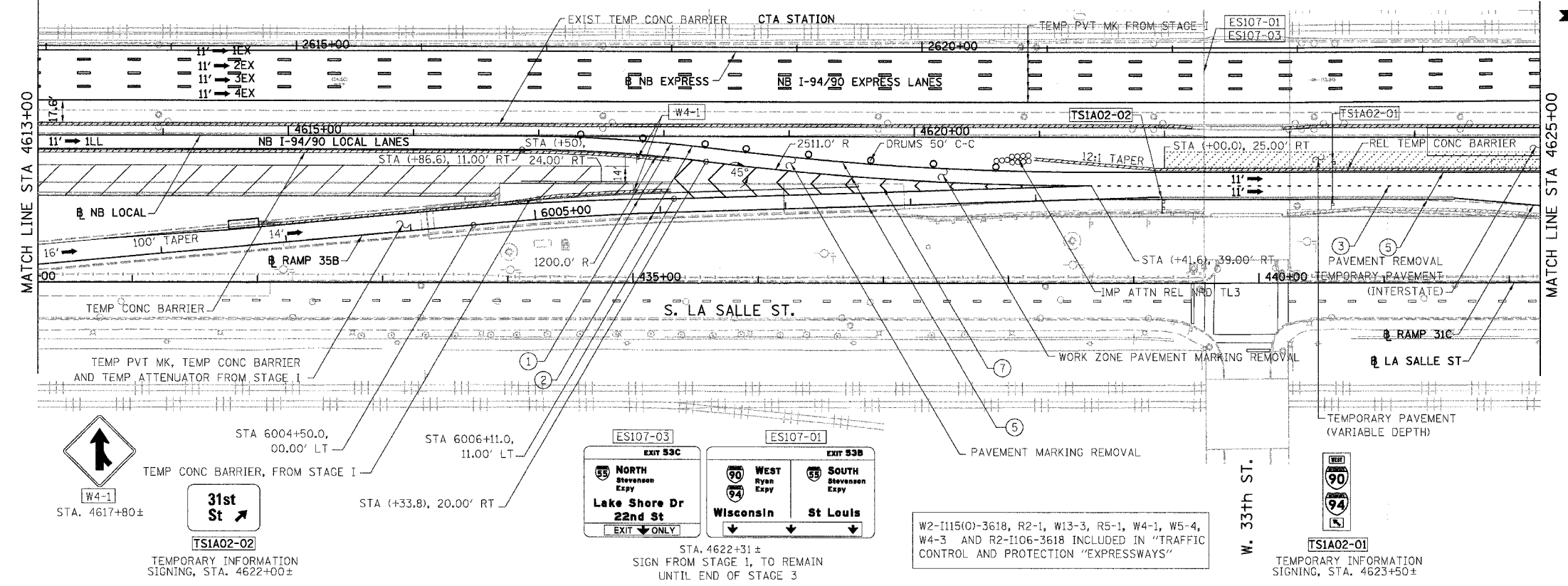

- LEGEND:**
- 1 → LANE NUMBER AND DIRECTION OF TRAFFIC
  - ▨ WORK AREA
  - ▨ TEMPORARY PAVEMENT
  - ∞ DRUMS 50' C-C
  - DRUM OR BARRICADE TYPE II WITH STEADY BURNING LIGHT
  - ⊥ BARRICADE TYPE III
  - ▨ TEMPORARY CONCRETE BARRIER
  - ① LINE 4" (YELLOW EDGE)
  - ② LINE 4" (WHITE EDGE)
  - ③ LINE 4" (SKIP DASH, 6' SKIP - 2' DASH, WHITE)
  - ④ LINE 5" (SKIP DASH, 30' SKIP - 10' DASH, WHITE)
  - ⑤ LINE 8" (WHITE GORE LINE)
  - ⑥ LINE 8" (SKIP DASH, 12' SKIP - 3' DASH, WHITE)
  - ⑦ LINE 12" (DIAGONAL, 30' C-C, WHITE)
  - ⑧ LETTERS AND SYMBOLS
  - ES-XXX-XX EXISTING OVERHEAD OR CANTILEVER SIGNS
  - GS-XXX-XX EXISTING POST MOUNTED SIGNS
  - TS-XXX-XX TEMPORARY SIGNS
  - +XX.XX STATION PROVIDED FROM THE ± SB I-90/94 EXPRESS LANES
  - (+XX.XX) STATION PROVIDED FROM THE ± SB I-90/94 LOCAL LANES

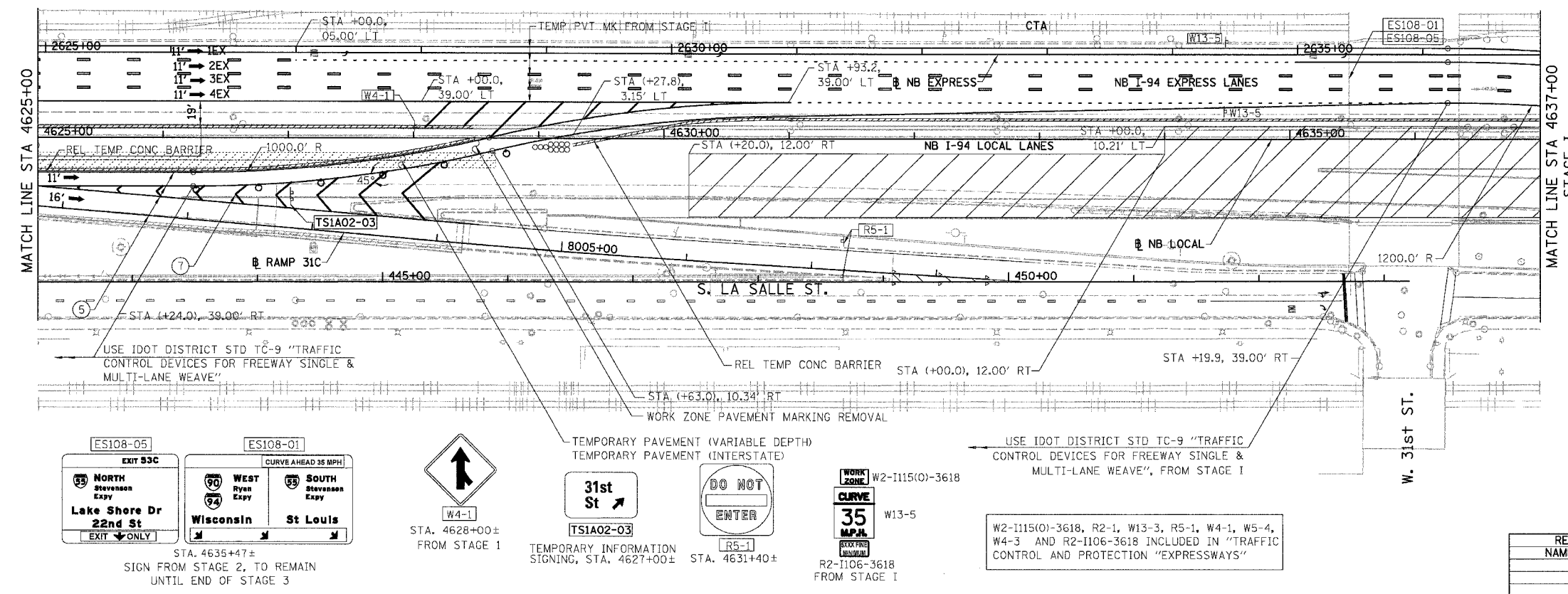

- NOTES:**
- SEE SHEET MOTTS-01 FOR TYPICAL SECTIONS.
  - SEE TEMPORARY SIGN PANEL SHEETS FOR DETAILS.

BOWMAN, BARRETT & ASSOCIATES INC.  
CONSULTING ENGINEERS  
Chicago, Illinois  
312.228.0100  
www.bbainc.com

NB I-94/90 EXPRESS LANES TEMPORARY PAVEMENT MARKINGS WERE INSTALLED IN STAGE I, UNLESS OTHERWISE SPECIFIED IN SUBSTAGE IA.  
CROSS OVER RAMPS TEMPORARY PAVEMENT MARKINGS INSTALLED IN SUBSTAGE IA TO REMAIN TO NEXT STAGE, UNLESS OTHERWISE SPECIFIED IN STAGE 2.

REVISIONS	
NAME	DATE

MOT-IA02  
ILLINOIS DEPARTMENT OF TRANSPORTATION  
F.A.I. 94/90 (DAN RYAN EXPRESSWAY)  
GARFIELD BLVD TO 31ST STREET (NB LOCAL LANES)  
SUGGESTED STAGES OF CONSTRUCTION  
AND TRAFFIC CONTROL  
SUBSTAGE IA  
SCALE: 1"=50'  
DATE: 06/09/06  
DRAWN BY: RA  
CHECKED BY: RS