

F.A.I.	SECTION	COUNTY	TOTAL SHEETS	SHEET NO.
94/90	*	COOK	565	105
STA.	TO STA.			
FED. ROAD DIST. NO.	ILLINOIS	FED. AID PROJECT		
62301		*12021-922 PT2 ETC 2324.6-1P) R-10		

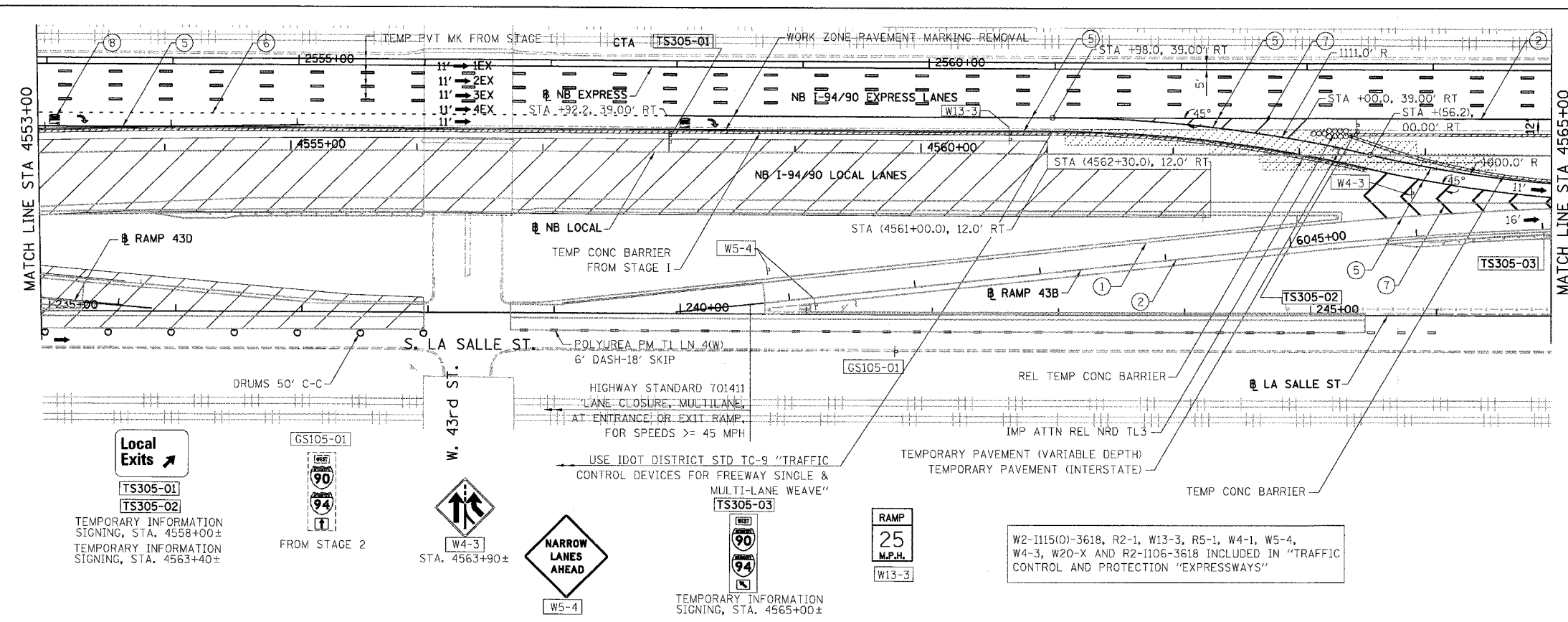

**LEGEND:**

- 1 → LANE NUMBER AND DIRECTION OF TRAFFIC
- ▨ WORK AREA
- ▨ TEMPORARY PAVEMENT
- ∞ IMPACT ATTENUATORS, TEMPORARY (NON-REDIRECTIVE), TEST LEVEL 3
- DRUM OR BARRICADE TYPE II WITH STEADY BURNING LIGHT
- ⊥ BARRICADE TYPE III
- ▨ TEMPORARY CONCRETE BARRIER
- ① LINE 4" (YELLOW EDGE)
- ② LINE 4" (WHITE EDGE)
- ③ LINE 4" (SKIP DASH, 6' SKIP - 2' DASH, WHITE)
- ④ LINE 5" (SKIP DASH, 30' SKIP - 10' DASH, WHITE)
- ⑤ LINE 8" (WHITE GORE LINE)
- ⑥ LINE 8" (SKIP DASH, 12' SKIP - 3' DASH, WHITE)
- ⑦ LINE 12" (DIAGONAL, 30' C-C, WHITE)
- ⑧ LETTERS AND SYMBOLS

ES-XXX-XX EXISTING OVERHEAD OR CANTILEVER SIGNS  
GS-XXX-XX EXISTING POST MOUNTED SIGNS  
TS-XXX-XX TEMPORARY SIGNS

+XX.XX STATION PROVIDED FROM THE ± SB I-90/94 EXPRESS LANES  
+XX.XX STATION PROVIDED FROM THE ± SB I-90/94 LOCAL LANES

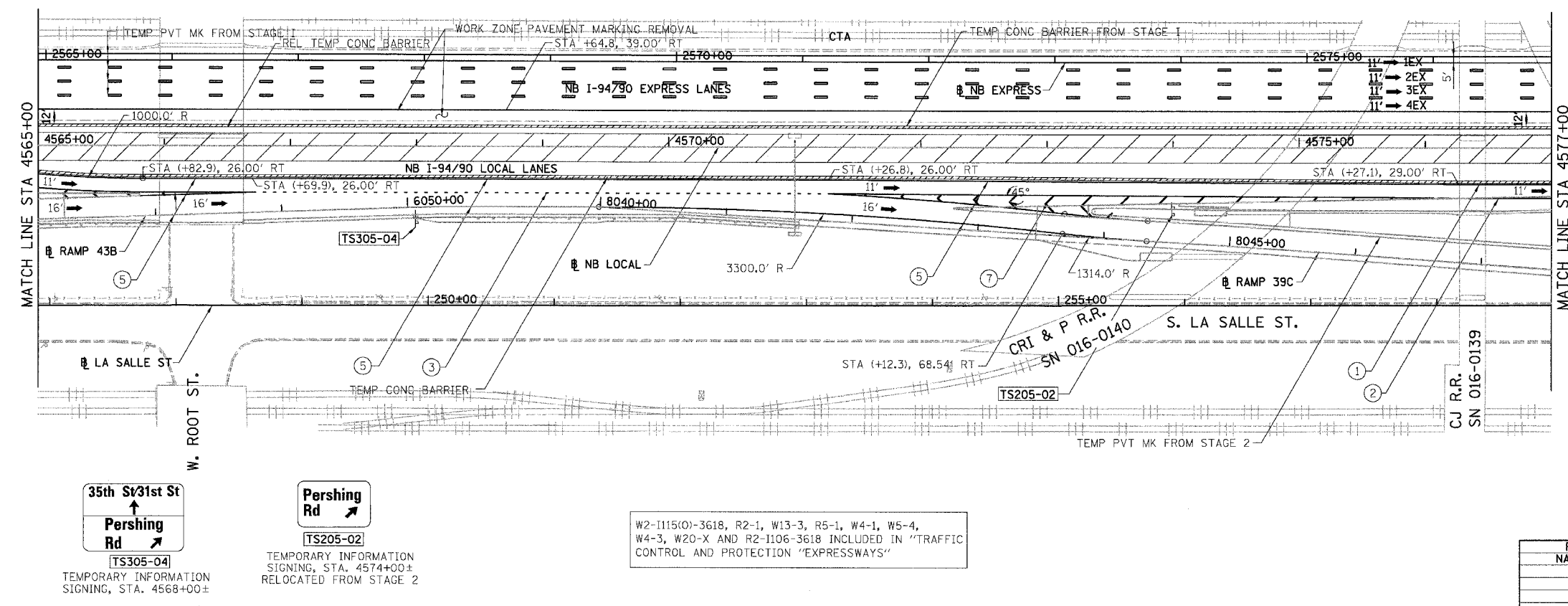

**NOTES:**

- SEE SHEET MOTTS-01 FOR TYPICAL SECTIONS.
- SEE TEMPORARY SIGN PANEL SHEETS FOR DETAILS.

0 50' 100'

MOT-305

ILLINOIS DEPARTMENT OF TRANSPORTATION  
F.A.I. 94/90 (DAN RYAN EXPRESSWAY)  
GARFIELD BLVD TO 31ST STREET (NB LOCAL LANES)  
SUGGESTED STAGES OF CONSTRUCTION  
AND TRAFFIC CONTROL  
STAGE 3

SCALE: 1"=50'  
DATE: 06/09/06  
DRAWN BY: RA  
CHECKED BY: RS

REVISIONS	NAME	DATE

BOWMAN, BARRETT & ASSOCIATES INC.  
CONSULTING ENGINEERS  
Chicago, Illinois  
312.228.0100  
www.bbainc.com

NB I-94/90 EXPRESS LANES TEMPORARY PAVEMENT MARKINGS WERE INSTALLED IN STAGES I, 2 AND SUBSTAGE IA, UNLESS OTHERWISE SPECIFIED IN STAGE 3.  
CROSS OVER RAMP, TEMPORARY PAVEMENT MARKINGS INSTALLED IN STAGE 2 TO REMAIN TO END OF SUBSTAGE 3A, UNLESS OTHERWISE SPECIFIED IN STAGE 3.

W2-1115(0)-3618, R2-1, W13-3, R5-1, W4-1, W5-4,  
W4-3, W20-X AND R2-1106-3618 INCLUDED IN "TRAFFIC  
CONTROL AND PROTECTION "EXPRESSWAYS"

6/7/2006 10:05 PM