

F.A.I. RTE.	SECTION	COUNTY	TOTAL SHEETS	SHEET NO.
90/94	*	COOK	565	298
STA. 1494+50.00		TO STA. 1506+50.00		
FED. ROAD DIST. NO. 1		ILLINOIS	FED. AID PROJECT	
62301		* (2021-922 PT2 ETC 2324.6-1P) R-10		

**NOTES:**

- SEE DRAWINGS EI-100 AND EI-101 FOR ELECTRICAL SYMBOLS AND ABBREVIATIONS.
- SEE DRAWINGS EI-102, EI-103, AND EI-104 FOR TYPICAL HANDHOLE INSTALLATION DETAILS.
- THE CONTRACTOR SHALL LOCATE THE EXISTING CONDUIT STUB-OUT INSTALLED IN IDOT CONTRACT NO. 62300 AND CONNECT THE PROPOSED CONDUIT.
- EXTEND CONDUIT STUB-OUT 2' BEYOND THE SIGN STRUCTURE FOUNDATION. CAP FOR FUTURE USE.
- PROVIDE A 3" RGS CONDUIT TO EDGE OF LANE PAVEMENT FOR DETECTOR LOOP WIRING. DETECTOR LOOPS WILL BE SAW CUT IN LOCAL LANES IN CONTRACT 62583. COORDINATE EXACT CONDUIT LOCATION WITH THE CONTRACT 62583.
- PROVIDE A SLEEVE FOR A 3" CNC CONDUIT INSTALLED IN CONTRACT 62583.
- UNLESS NOTED OTHERWISE, ALL ITEMS AND WORK SHOWN IN HEAVY LINE WEIGHT ON THIS DRAWING ARE PROPOSED NEW ITEMS AND WORK.

P:\p465\elect\9-contra 15 & 19\contract 15\STV1450352.dwg

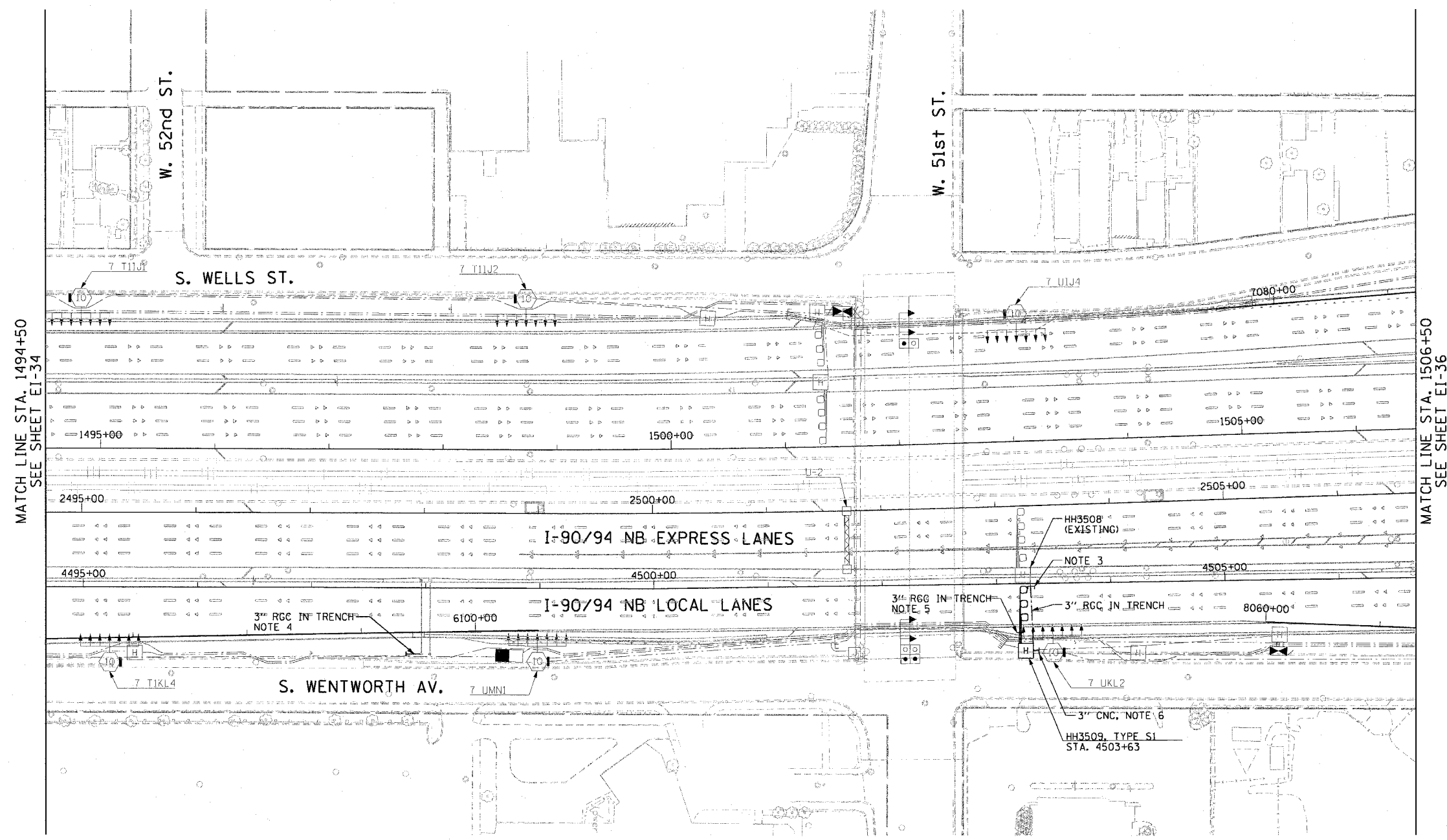

MATCH LINE STA. 1494+50  
SEE SHEET EI-34

MATCH LINE STA. 1506+50  
SEE SHEET EI-36

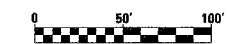

EI-35

CTE | AECOM

REVISIONS	
NAME	DATE

ILLINOIS DEPARTMENT OF TRANSPORTATION  
 F.A.I. 90/94 (DAN RYAN EXPRESSWAY)  
 GARFIELD BLVD TO 31ST STREET (NB LOCAL LANES)  
**ELECTRICAL INFRASTRUCTURE PLAN**

SCALE: 1"=50'  
 DATE: June 9, 2006

DRAWN BY: HAR  
 CHECKED BY: JPC

06/07/2006 10:50:50 AM