

F.A.I.	SECTION	COUNTY	TOTAL SHEETS	SHEET NO.
94/90	*	COOK	565	309
STA. 1620+00		TO STA. 1632+00		
FED. ROAD DIST. NO.		ILLINOIS	FED. AID PROJECT	
62301 • (2021-922 PT2 ETC 2324.6-1P) R-10				

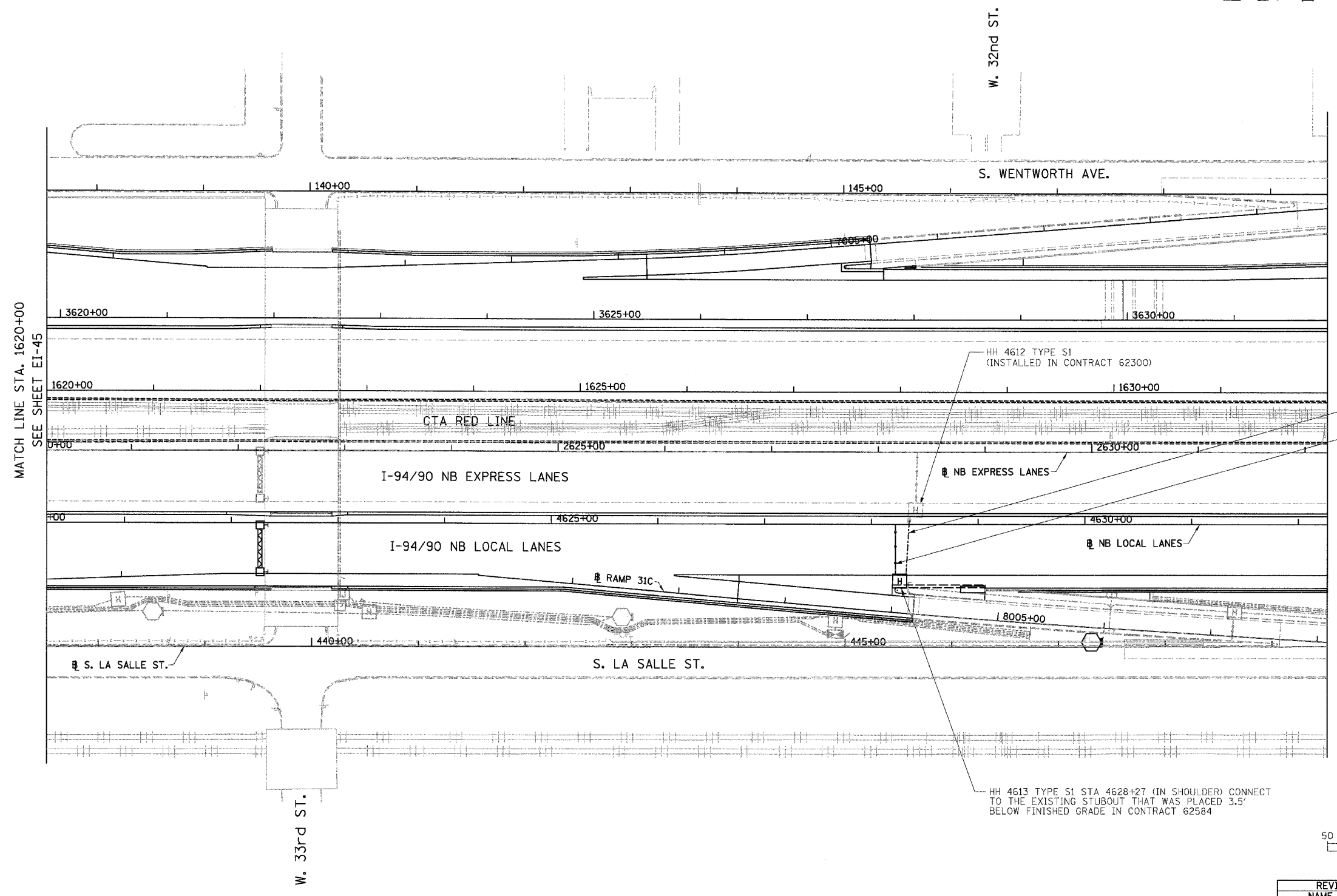

- NOTES:
- SEE DRAWINGS EI-100 AND EI-101 FOR ELECTRICAL SYMBOLS AND ABBREVIATIONS.
 - SEE DRAWINGS EI-102, EI-103, AND EI-104 FOR TYPICAL HANDHOLE INSTALLATION DETAILS.
 - TRENCHED CONDUITS INSTALLED IN PARALLEL ARE TO BE INSTALLED IN COMMON TRENCH.
 - THIS CONTRACT IS RESPONSIBLE FOR PROPOSED ITEMS THAT ARE LABELED. UNLABELLED ITEMS ARE THE RESPONSIBILITY OF CONTRACT 62583. ALL WORK MUST BE COORDINATED BY BOTH CONTRACTS.

- (1) - 2" GSC IN TRENCH CONNECT TO EXISTING STUBOUT AT ELEV. = -3.43
- (1) - 54' - 3" PVC CONCRETE ENCASED

MATCH LINE STA. 1620+00
SEE SHEET EI-45

MATCH LINE STA. 1632+00
SEE SHEET EI-47



EI-46

REVISIONS	
NAME	DATE

ILLINOIS DEPARTMENT OF TRANSPORTATION
 F.A.I. 94/90 (DAN RYAN EXPRESSWAY)
 59TH STREET TO 31ST STREET (NB LOCAL LANES)
 ELECTRICAL INFRASTRUCTURE PLANS

SCALE: 1"=50'
 DATE: 06/09/06

DRAWN BY: JDC
 CHECKED BY: RS

BOWMAN, BARRETT & ASSOCIATES INC.
 CONSULTING ENGINEERS
 Chicago, Illinois
 312.228.0100
 www.bbainc.com

DRAWN BY: JDC
 CHECKED BY: RS
 DATE: 06/09/06
 6/7/2006