

F.A.I.	SECTION	COUNTY	TOTAL SHEETS	SHEET NO.
94/90	*	COOK	588	75
STA.		TO STA.		
FED. ROAD DIST. NO.	ILLINOIS	FED. AID PROJECT		

PLAN	REVISIONS	BY	DATE
NO.	NOTED		
	ALIGNED		
	CHECKED		
	DATE		

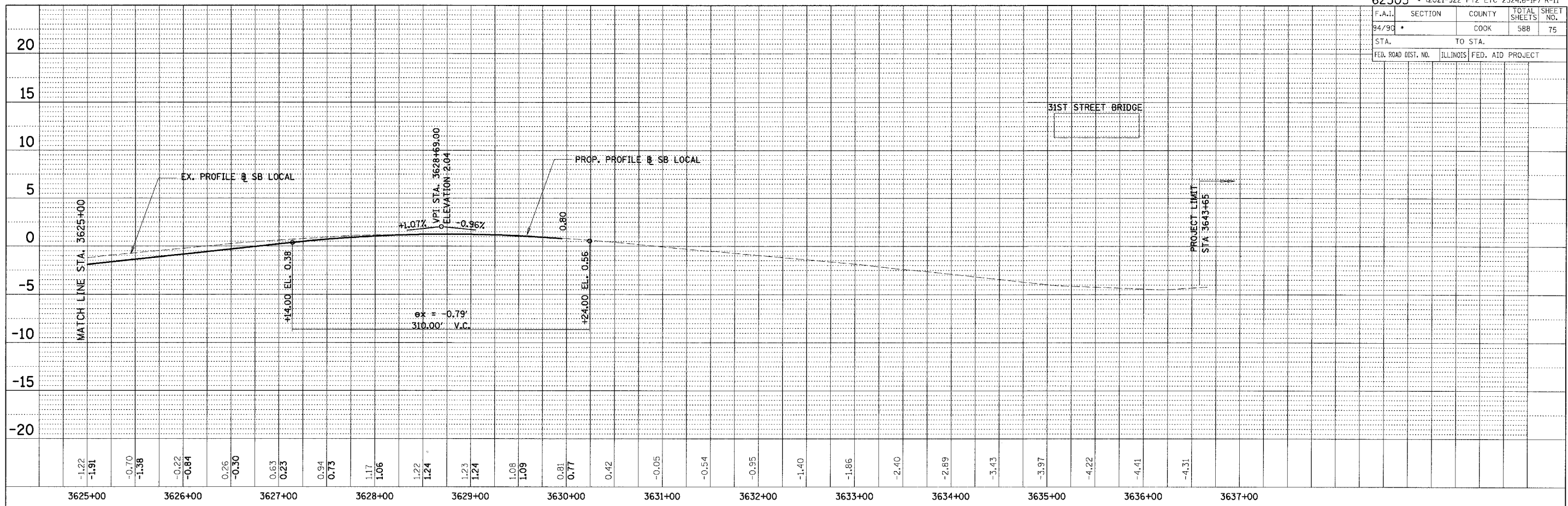

PLAN	REVISIONS	BY	DATE
NO.	NOTED		
	ALIGNED		
	CHECKED		
	DATE		

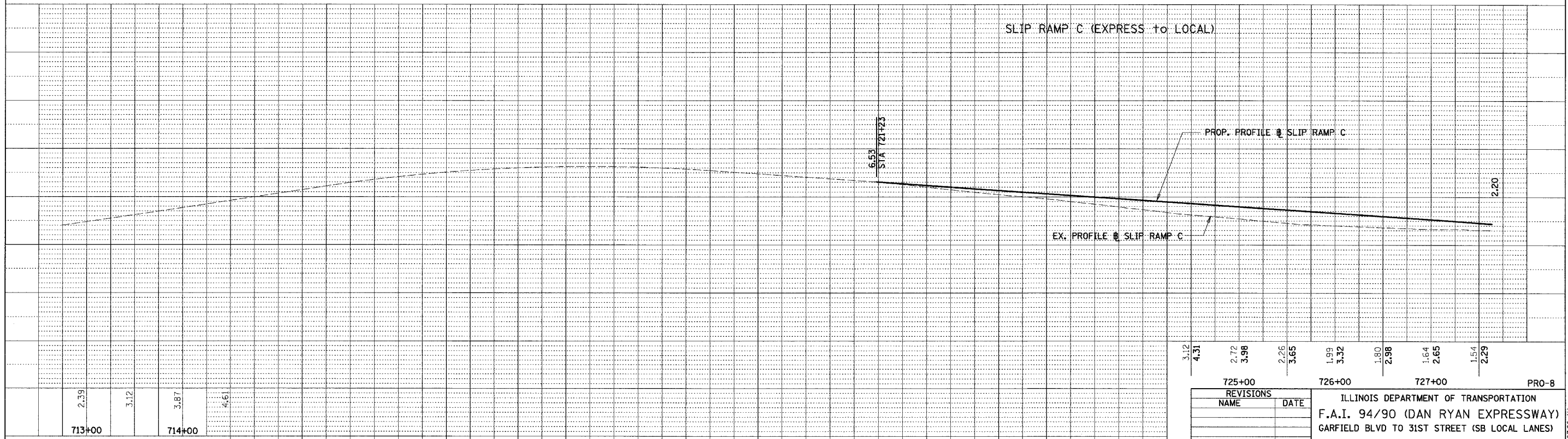

BOWMAN, BARRETT & ASSOCIATES INC.
 CONSULTING ENGINEERS
 Chicago, Illinois
 312.228.0100
 www.bbandainc.com

REVISIONS	NAME	DATE

ILLINOIS DEPARTMENT OF TRANSPORTATION
 F.A.I. 94/90 (DAN RYAN EXPRESSWAY)
 GARFIELD BLVD TO 31ST STREET (SB LOCAL LANES)
 PROFILES - SB LOCAL LANES & SLIP RAMP C

1" = 5' VERTICAL
 SCALE: 1" = 50' HORIZ
 DATE: 06/09/06

DRAWN BY: JDC
 CHECKED BY: RS

16/3/2006 6/8/2006