

F.A.I. RTE.	SECTION	COUNTY	TOTAL SHEETS	SHEET NO.
90/94		COOK	588	108
STA. 3475+50		TO STA. 3482+00		
FED. ROAD DIST. NO. 1 ILLINOIS FED. AID PROJECT				
62303 • (2021-922 PT2 ETC 2324.6-1P) R-11				

- LEGEND:**
- ➔ LANE NUMBER AND DIRECTION OF TRAFFIC
 - ▨ WORK AREA
 - ▨ TEMPORARY PAVEMENT
 - ⊙ IMPACT ATTENUATORS, TEMPORARY (NON-REDIRECTIVE), TEST LEVEL 3
 - ⊙ DRUM OR BARRICADE TYPE II WITH STEADY BURNING LIGHT
 - ⊓ BARRICADE TYPE III
 - ▬ TEMPORARY CONCRETE BARRIER
 - ① LINE 4" (YELLOW EDGE)
 - ② LINE 4" (WHITE EDGE)
 - ③ LINE 4" (SKIP DASH, 6' SKIP - 2' DASH, WHITE)
 - ④ LINE 5" (SKIP DASH, 30' SKIP - 10' DASH, WHITE)
 - ⑤ LINE 8" (WHITE GORE LINE)
 - ⑥ LINE 8" (SKIP DASH, 12' SKIP - 3' DASH, WHITE)
 - ⑦ LINE 12" (DIAGONAL, 30' C-C, WHITE)
 - ⑧ LETTERS AND SYMBOLS
 - ES-XXX-XX EXISTING OVERHEAD OR CANTILEVER SIGNS
 - GS-XXX-XX EXISTING POST MOUNTED SIGNS
 - TS-XXX-XX TEMPORARY SIGNS
 - +XX.XX STATION PROVIDED FROM THE ± SB I-90/94 EXPRESS LANES
 - (+XX.XX) STATION PROVIDED FROM THE ± SB I-90/94 LOCAL LANES

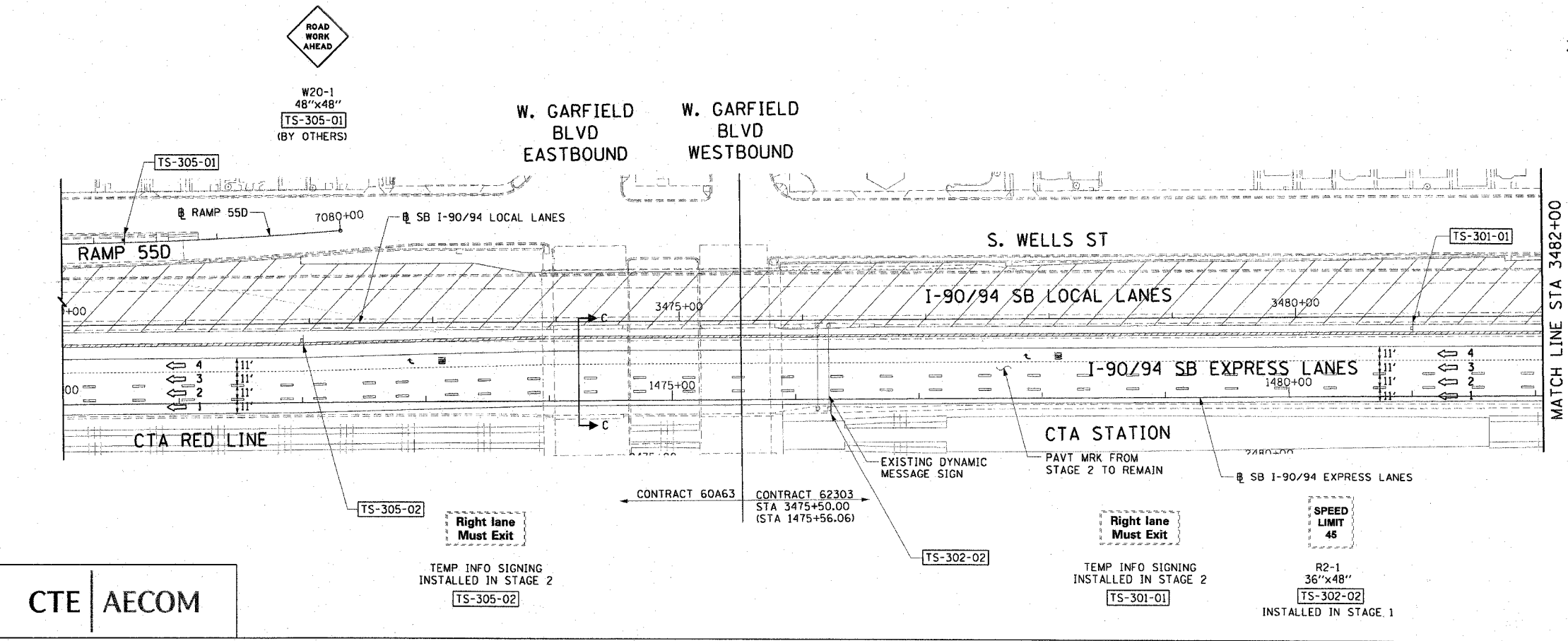

- NOTES:**
- SEE SHEET MOTTS-01 FOR TYPICAL SECTIONS.
 - SEE TEMPORARY SIGN PANEL SHEETS FOR DETAILS.

REVISIONS	
NAME	DATE

MOT-301

ILLINOIS DEPARTMENT OF TRANSPORTATION
F.A.I. 90/94 (DAN RYAN EXPRESSWAY)
GARFIELD BLVD TO 31ST STREET (SB LOCAL LANES)

SUGGESTED STAGES OF CONSTRUCTION
AND TRAFFIC CONTROL
STAGE 3

SCALE: 1"=50'
DATE: June 9, 2006

DRAWN BY: PHP
CHECKED BY: RMG

CTE | AECOM

P:\AECOM\62303\1118\cvt\118_cvt118.ctb & 19/06/2006 15:56:03 PM 6/7/2006 15:56:03 PM