

| | | | | |
|---------------------|------------------------------------|------------------|--------------|-----------|
| F.A.I. | SECTION | COUNTY | TOTAL SHEETS | SHEET NO. |
| 94/90 | * | COOK | 588 | 116 |
| STA. | TO STA. | | | |
| FED. ROAD DIST. NO. | ILLINOIS | FED. AID PROJECT | | |
| 62303 | *(2021-922 PT2 ETC 2324.6-1P) R-11 | | | |

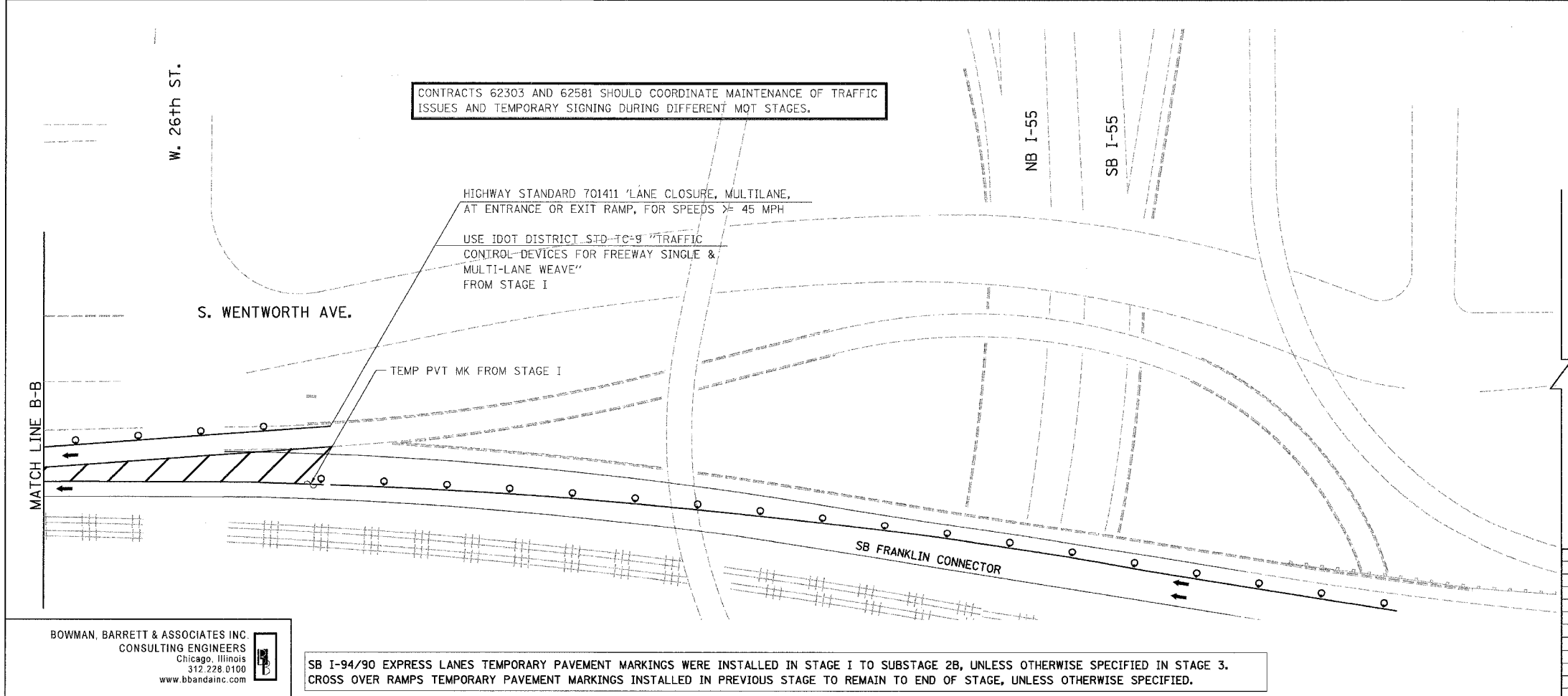
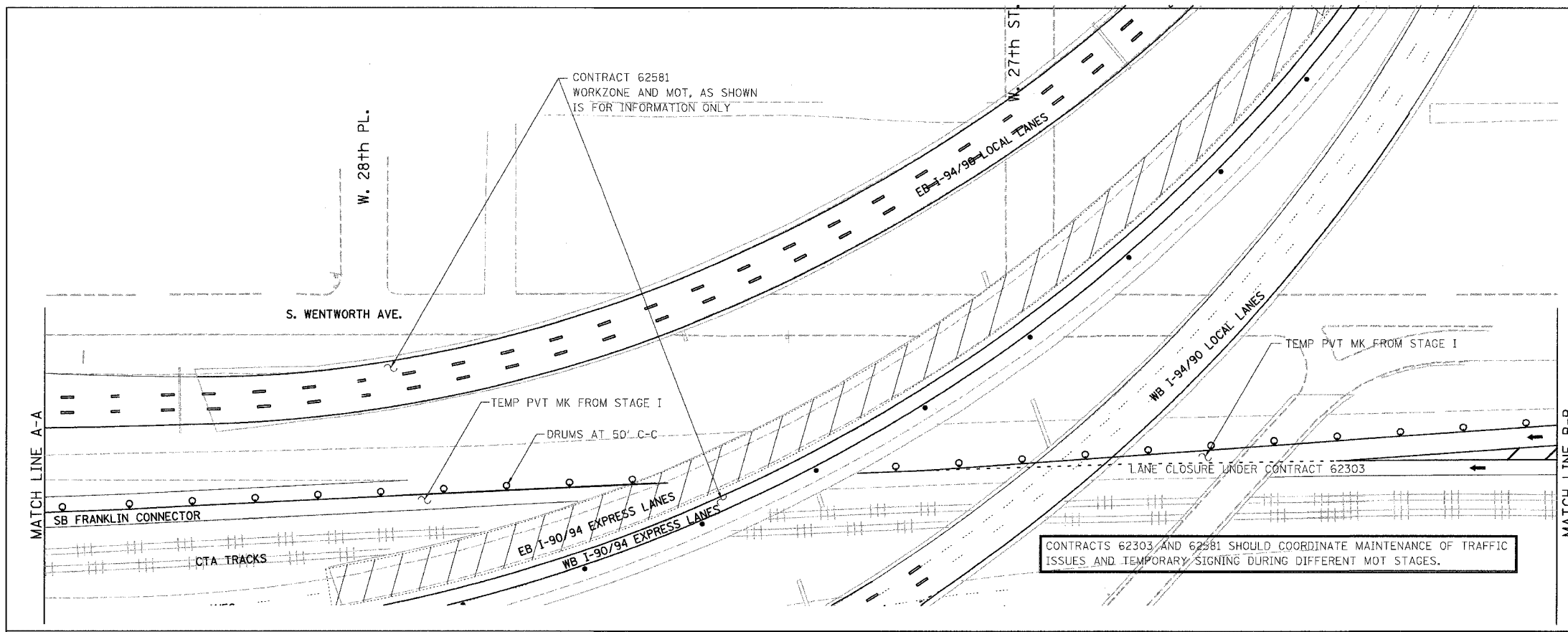

CONTRACTS 62303 AND 62581 SHOULD COORDINATE MAINTENANCE OF TRAFFIC ISSUES AND TEMPORARY SIGNING DURING DIFFERENT MOT STAGES.

CONTRACTS 62303 AND 62581 SHOULD COORDINATE MAINTENANCE OF TRAFFIC ISSUES AND TEMPORARY SIGNING DURING DIFFERENT MOT STAGES.

HIGHWAY STANDARD 701411 LANE CLOSURE, MULTILANE, AT ENTRANCE OR EXIT RAMP, FOR SPEEDS \geq 45 MPH
 USE IDOT DISTRICT STD-TC-9 "TRAFFIC CONTROL DEVICES FOR FREEWAY SINGLE & MULTI-LANE WEAVE" FROM STAGE I

SB I-94/90 EXPRESS LANES TEMPORARY PAVEMENT MARKINGS WERE INSTALLED IN STAGE I TO SUBSTAGE 2B, UNLESS OTHERWISE SPECIFIED IN STAGE 3. CROSS OVER RAMPS TEMPORARY PAVEMENT MARKINGS INSTALLED IN PREVIOUS STAGE TO REMAIN TO END OF STAGE, UNLESS OTHERWISE SPECIFIED.

BOWMAN, BARRETT & ASSOCIATES INC
 CONSULTING ENGINEERS
 Chicago, Illinois
 312.228.0100
 www.bbainc.com

| REVISIONS | NAME | DATE |
|-----------|------|------|
| | | |
| | | |
| | | |
| | | |
| | | |
| | | |
| | | |
| | | |
| | | |
| | | |

0 50' 100'

MOT-309

ILLINOIS DEPARTMENT OF TRANSPORTATION
 F.A.I. 94/90 (DAN RYAN EXPRESSWAY)
 GARFIELD BLVD TO 31ST STREET (SB LOCAL LANES)
 SUGGESTED STAGES OF CONSTRUCTION
 AND TRAFFIC CONTROL
 STAGE 3

SCALE: 1"=50'
 DATE: 06/09/06

DRAWN BY: RA
 CHECKED BY: RS