

|                     |                                  |                  |              |           |
|---------------------|----------------------------------|------------------|--------------|-----------|
| F.A.I.              | SECTION                          | COUNTY           | TOTAL SHEETS | SHEET NO. |
| 94/90               |                                  | COOK             | 588          | 327       |
| STA. 1572+00        |                                  | TO STA. 1584+00  |              |           |
| FED. ROAD DIST. NO. | ILLINOIS                         | FED. AID PROJECT |              |           |
| 62303               | 2021-922 PT2 ETC 2324.6-1P) R-11 |                  |              |           |

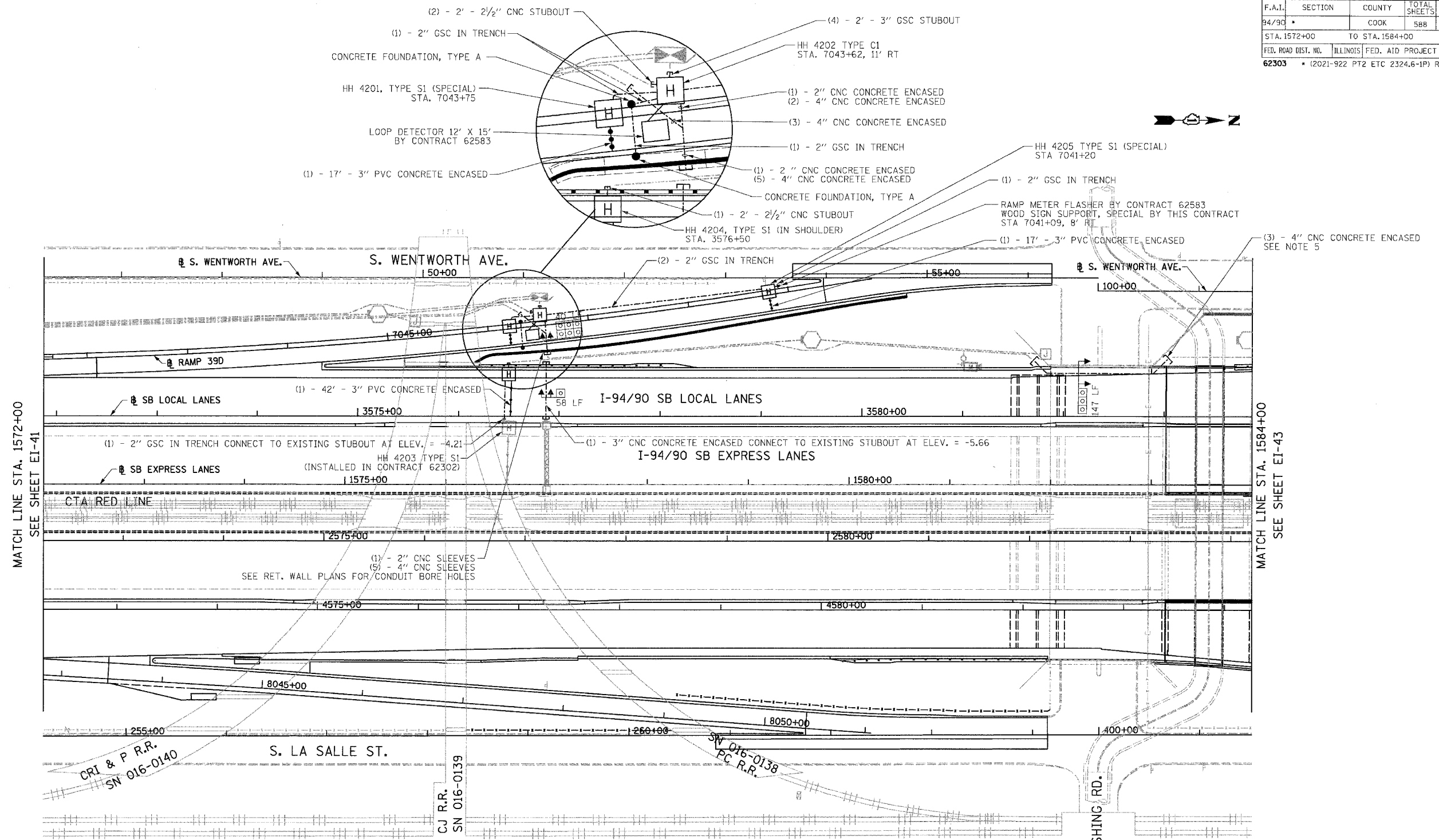

MATCH LINE STA. 1572+00  
SEE SHEET EI-41

MATCH LINE STA. 1584+00  
SEE SHEET EI-43

- NOTES:**
- SEE DRAWINGS EI-100 AND EI-101 FOR ELECTRICAL SYMBOLS AND ABBREVIATIONS.
  - SEE DRAWINGS EI-102, EI-103, AND EI-104 FOR TYPICAL HANDHOLE INSTALLATION DETAILS.
  - TRENCHED CONDUITS INSTALLED IN PARALLEL ARE TO BE INSTALLED IN COMMON TRENCH.
  - THIS CONTRACT IS RESPONSIBLE FOR PROPOSED ITEMS THAT ARE LABELED. UNLABELLED ITEMS ARE THE RESPONSIBILITY OF CONTRACT 62583. ALL WORK MUST BE COORDINATED BY BOTH CONTRACTS.
  - ELECTRICAL DUCTBANKS AROUND BRIDGE ABUTMENTS MUST CLEAR ALL PROPOSED DRAINAGE STRUCTURES. SEE DRAINAGE PLANS FOR DETAILS.

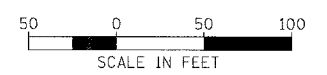

BOWMAN, BARRETT & ASSOCIATES INC.  
CONSULTING ENGINEERS  
Chicago, Illinois  
312.228.0100  
www.bbainc.com

| REVISIONS |      |
|-----------|------|
| NAME      | DATE |
|           |      |
|           |      |
|           |      |
|           |      |
|           |      |

EI-42

ILLINOIS DEPARTMENT OF TRANSPORTATION  
F.A.I. 94/90 (DAN RYAN EXPRESSWAY)  
59TH STREET TO 31ST STREET (SB LOCAL LANES)  
ELECTRICAL INFRASTRUCTURE PLANS

SCALE: 1"=50'  
DATE: 06/09/06

DRAWN BY: JDC  
CHECKED BY: RS

6/8/2006 11:44:32 AM