

F.A.I.	SECTION	COUNTY	TOTAL SHEETS	SHEET NO.
94/90		COOK	588	367
STA.	TO STA.			
FED. ROAD DIST. NO.	ILLINOIS	FED. AID PROJECT		
62303	• (2021-922 PT2 ETC 2324.6-1P) R-11			

SUB-BASE GRANULAR MATERIAL, TYPE B MATERIAL WILL BE REUSED AS SUB-BASE GRANULAR MATERIAL, TYPE B, 24", AS USED FOR ROADWAY CONSTRUCTION.

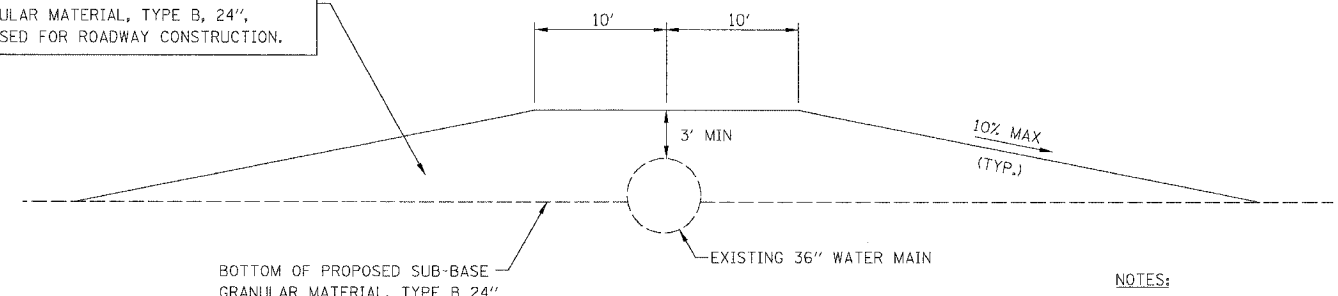

BOTTOM OF PROPOSED SUB-BASE GRANULAR MATERIAL, TYPE B 24"  
EXISTING 36" WATER MAIN

**CONSTRUCTION PROTECTION**  
STA. 4533+69

**NOTES:**

- CONTRACTOR WILL PROVIDE A MINIMUM COVER, AS SHOWN ABOVE AT ALL TIMES DURING CONSTRUCTION AND PRIOR TO THE INSTALLATION OF THE PERMANENT WATER MAIN PROTECTION CAP. CONSTRUCTION TRAFFIC SHALL NOT CROSS THE WATER MAIN PIPE WITHOUT PROTECTION IN PLACE.
- CONTRACTOR IS RESPONSIBLE FOR THE INTEGRITY OF THE WATER MAIN PIPE THROUGH OUT THE DURATION OF THE PROJECT AND WILL NOT BE PAID FOR ANY REPAIRS REQUIRED, AS DETERMINED BY THE ENGINEER, TO THE PIPE, DUE TO CONSTRUCTION ACTIVITIES.

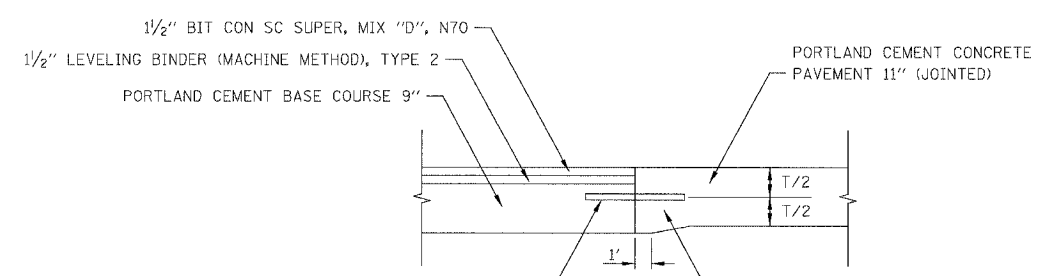

POUR IN PLACE 1/2" DIA. TIE BARS (EPOXY COATED) 18" LONG AT 12" CENTERS. INCLUDED IN THE COST OF PORTLAND CEMENT CONCRETE PAVEMENT 11" (JOINTED).

PAVEMENT THICKENING AT THE RATE OF 1" OF DEPTH PER 5' OF LONGITUDINAL PAVEMENT. ADDITIONAL THICKNESS IS INCLUDED IN THE COST OF PORTLAND CEMENT CONCRETE PAVEMENT 11" (JOINTED)

**PAVEMENT TRANSITION BETWEEN FRONTAGE ROAD AND RAMP**

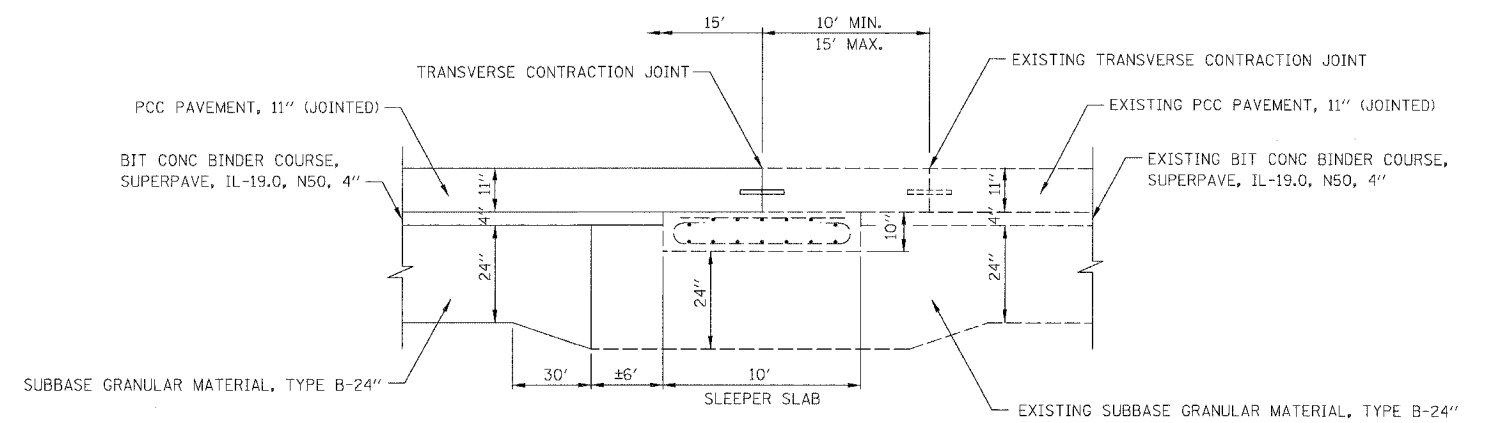

**SLEEPER SLAB INTERFACE**

- RAMP T35D STA 7043+08.6
- RAMP T39A STA 5024+32.5
- RAMP 35A STA 5004+04.9
- RAMP 31D STA 7004+63.8

**NOTES:**

- 10 MIL. POLYETHYLENE BOND BREAKER WAS PLACED ON THE EXISTING SLEEPER SLABS BY THE PREVIOUS CONTRACT ALONG WITH A 3" PREFORMED EXPANSION JOINT AT THE TEMPORARY PAVEMENT LIMIT. THE EXISTING SLEEPER SLABS MUST NOT BE DAMAGED BY THE TEMPORARY CONCRETE PAVEMENT REMOVAL OPERATIONS DONE BY THIS CONTRACT.
- THE AREAS OF VARYING HEIGHT SUB-BASE GRANULAR MATERIAL, TYPE B WILL BE PAID FOR AS SUB-BASE GRANULAR MATERIAL, TYPE B-24".

BOWMAN, BARRETT & ASSOCIATES INC.  
CONSULTING ENGINEERS  
Chicago, Illinois  
312.228.0100  
www.bbainc.com

REVISIONS	
NAME	DATE

ILLINOIS DEPARTMENT OF TRANSPORTATION  
F.A.I. 94/90 (DAN RYAN EXPRESSWAY)  
GARFIELD BLVD TO 31ST STREET (SB LOCAL LANES)  
ROADWAY DETAILS  
CONSTRUCTION PROTECTION  
PVT TRAN BTWN FRONTAGE RD & RAMP  
SLEEPER SLAB INTERFACE  
SCALE: NONE  
DATE: 06/09/06  
DRAWN BY: JDC  
CHECKED BY: RS

RDT-15

11/5/2006  
6/8/2006