

F.A.I.	SECTION	COUNTY	TOTAL SHEETS	SHEET NO.
94/90	*	COOK	588	383
STA.	TO STA.			
FED. ROAD DIST. NO.	ILLINOIS	FED. AID PROJECT		
62303 • (2021-922 PT2 ETC 2324.6-1P) R-11				

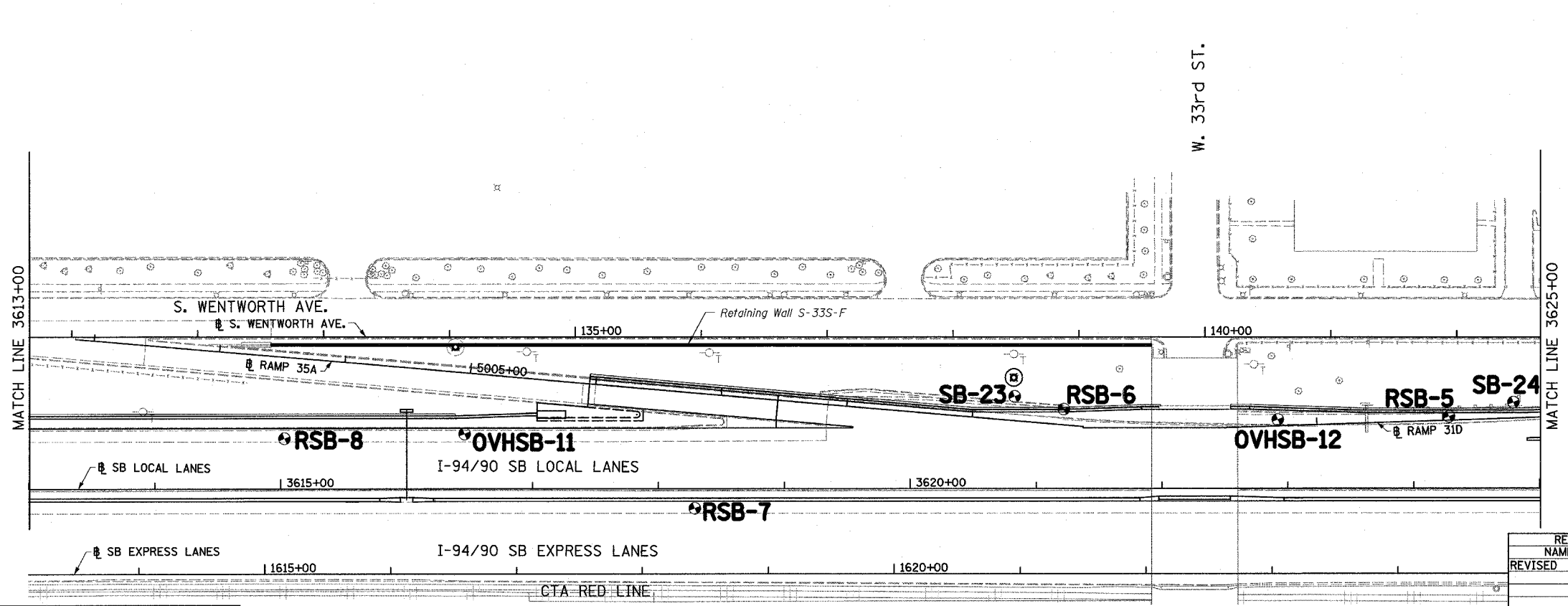

NOTES:

- FOR RETAINING WALL SOIL BORINGS SEE ASSOCIATED RETAINING WALL PLANS
- FOR SIGN STRUCTURE BORINGS SEE SOIL BORING LOGS FOR SIGN STRUCTURE FOUNDATIONS

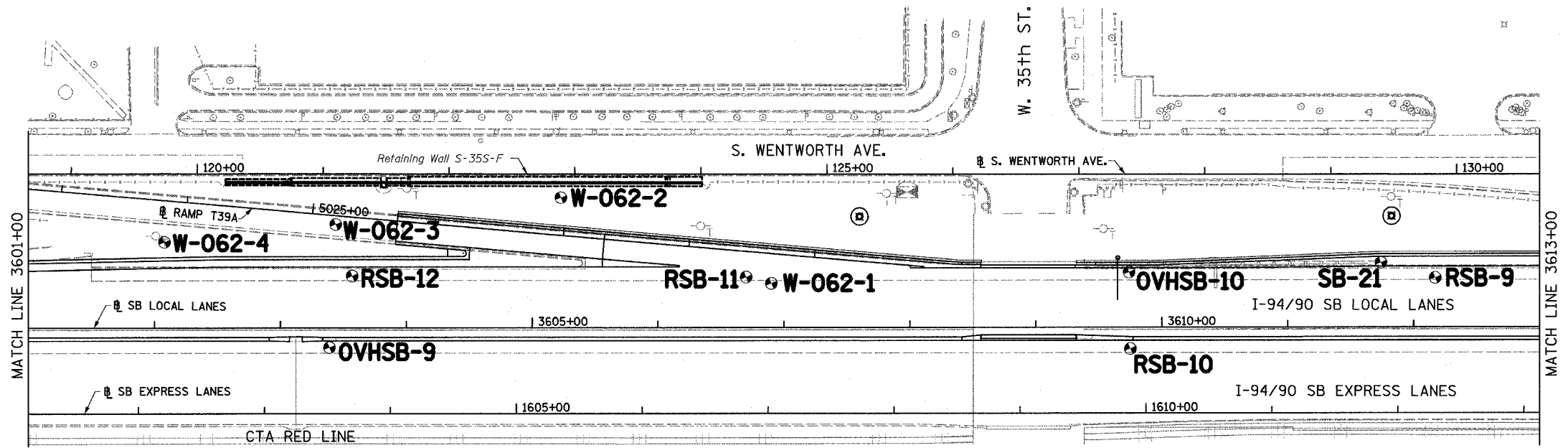

LEGEND:

SB	HIGH MAST LIGHT TOWER
RSB	ROADWAY
OVHSB	OVERHEAD SIGN STRUCTURE

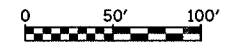

REVISIONS	
NAME	DATE
REVISED	6/27/06

ILLINOIS DEPARTMENT OF TRANSPORTATION
 F.A.I. 94/90 (DAN RYAN EXPRESSWAY)
 GARFIELD BLVD TO 31ST STREET (SB LOCAL LANES)
SOIL BORING PLAN
 SCALE: 1"=50'
 DATE: 06/09/06
 DRAWN BY: LAM
 CHECKED BY: BLU

BOWMAN, BARRETT & ASSOCIATES INC.
 CONSULTING ENGINEERS
 Chicago, Illinois
 312.228.0100
 www.bbandainc.com

4/8/03 PM
 6/27/2006
 4/8/03 PM