

**BAR DETAILS**

BAR	A	B	C	H
F504	2'-1"	1'-7"	2'-4"	1'-0"
F507	2'-5"	1'-7"	2'-1"	1'-0"
F509	1'-3 1/2"	1'-0 1/2"	1'-1 1/2"	5"
F502	1'-6"	1'-0"	2'-0"	5"
F701	2'-0 1/2"	1'-0 1/2"	2'-0"	5"

**BAR LIST**

BAR NO.	SIZE	LENGTH	SHAPE	WEIGHT
F401	12	4	2'-7"	21
F402	30	4	1'-7"	32
F403	32	4	2'-1"	45
F404	18	4	1'-1"	15
F501	117	5	4'-0"	460
F502	14	5	2'-9"	434
F503	189	5	3'-0"	591
F504	55	5	6'-0"	309
F505	235	5	4'-7"	1123
F506	100	5	2'-0"	2712
F507	118	5	6'-1"	724
F508	204	5	7'-5"	1651
F509	51	5	4'-3"	225
F510	104	5	7'-2"	813
F511	39	5	24'-3"	1414
F512	102	5	5'-8"	803
F513	18	5	3'-3"	834
F601	204	6	7'-5"	2349
F602	304	6	4'-7"	1404
F603	102	6	7'-10"	1200
F701	102	7	8'-1"	1260
F501	80	5	4'-7"	382
F502	60	5	6'-2"	496
F503	60	5	7'-0"	604
F504	60	5	8'-4"	600
F505	188	5	9'-0"	1295
F506	60	5	6'-6"	612
F507	60	5	7'-5"	552
F508	160	5	6'-7"	1099
F501	18	5	54'-3"	557
F502	83	5	24'-6"	2143
F503	78	5	20'-2"	1874
F504	8	5	35'-0"	873
F601	22	6	25'-6"	1987

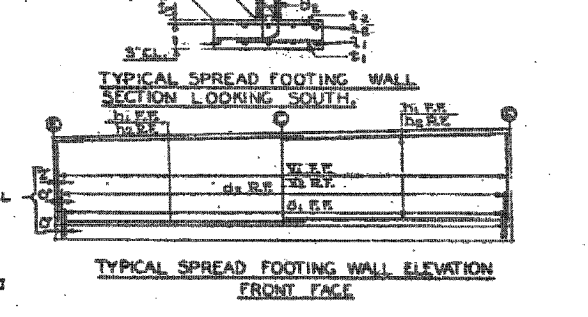
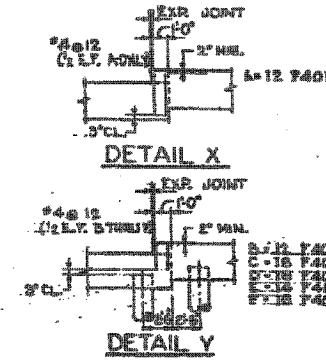

**REINFORCEMENT BAR PLACING TABLE**

UNIT NO.	UNIT TYPE	FOOTING				STEM							
		FTG. MARK	REIN. IN EA. BAND	NO. OF BANDS	ITEM MARK	REIN. IN EA. BAND	NO. OF BANDS	ITEM MARK					
7	F-7	1	51	3	12	F508	1-BOT.	V1	9	5	36	V507	1-R.F.
		2	51	5	12	F601	1-TOP	V2	16	5	12	V507	1-R.F.
		3	51	3	24	F506	2-BOT.	H1	6	5	18	H503	1-R.F.
		4	51	3	18	F506	2-TOP	H2	3	5	36	H503	1-R.F.
		5	18	3	24	F503	1-R.F.	V3	25	3	12	V507	1-R.F.
		6	31	5	12	F502	1-R.F.	H1	6	5	18	H502	1-R.F.
		7	51	3	12	F512	1-BOT.	V1	9	5	36	V508	1-R.F.
		8	51	5	12	F512	1-TOP	V2	16	5	12	V508	1-R.F.
		9	4	5	24	F508	2-BOT.	H1	6	5	18	H503	1-R.F.
		10	4	5	24	F506	2-TOP	H2	3	5	36	H503	1-R.F.
8	F-8	1	18	5	36	F503	1-R.F.	V1	25	3	12	V508	1-R.F.
		2	51	3	12	F505	1-BOT.	H1	6	5	18	H502	1-R.F.
		3	51	5	12	F509	1-R.F.	H2	3	5	36	H502	1-R.F.
		4	51	3	24	F505	2-TOP	V1	9	5	36	V508	1-R.F.
		5	66	5	12	F505	1-BOT.	V1	12	5	36	V508	1-R.F.
		6	67	5	12	F505	1-TOP	V2	16	5	12	V508	1-R.F.
		7	3	5	18	F513	1-BOT.	H1	6	5	18	H501	1-R.F.
		8	3	5	18	F513	2-TOP	H2	3	5	36	H501	1-R.F.
		9	24	5	36	F503	1-R.F.	V1	12	5	36	V508	1-R.F.
		10	27	5	12	F507	1-R.F.	H1	6	5	18	H504	1-R.F.

**NOTES**  
FOR GENERAL NOTES AND STANDARD DETAILS SEE SHEET NO.87 FOR DETAILS, DIMENSIONS, ETC. OF WALL TYPES (1) (2) (3) SEE SHEETS NO. 96 AND 98  
(1) EXPANSION JOINT FOR DETAILS SEE SHEET NO.81  
(2) CONSTRUCTION JOINT  
(3) R-75 INDICATES TEST BORING  
FOR ADDITIONAL PLAN GEOMETRICS SEE ALIGNMENT & TIES STA. 115+00 TO STA. 190+00 SHEET No. 77  
FOR DETAILS OF RC.M.R. SEE SHEET No.78

**BILL OF MATERIAL**

ITEM	UNIT	QUANTITY
POROUS GRANULAR BACKFILL	CU. YD.	450
CLASS A EXCAVATION FOR STRUCTURE	CU. YD.	7250
CLASS X CONCRETE	CU. YD.	475
REINFORCEMENT BARS	POUND	50209
DRIVING CONCRETE PILES	LN. FT.	2600
FURNISHING CONCRETE PILES	LN. FT.	2600
TEST PILE CONCRETE	EACH	1
PERF. CORR. MET. PIPE - 8"	LN. FT.	924
PEDESTRIAN BARRIER TYPE III	LN. FT.	924

**ILLINOIS DIVISION OF HIGHWAYS**  
SOUTH EXPRESSWAY  
**RETAINING WALL**  
W-3

**REVISIONS**

NAME	DATE

ILLINOIS DEPARTMENT OF TRANSPORTATION  
F.A.I. 94/90 (DAN RYAN EXPRESSWAY)  
GARFIELD BLVD TO 31ST STREET (SB LOCAL LANES)  
COOK COUNTY  
STA. 3532+90.57 TO STA. 3543+57.42  
RETAINING WALL S-45S-F  
EXISTING RET. WALL PLAN 2  
S.N. 016-W978  
SCALE: NTS  
DATE: JUNE 9, 2006  
DRAWN BY: KMW  
CHECKED BY: BLU

FOR INFORMATION ONLY

BOWMAN, BARRETT & ASSOCIATES INC.  
CONSULTING ENGINEERS  
Chicago, Illinois  
312.228.0100  
www.bbainc.com

6/9/2006 9:27:44 AM