

F.A.P. RTE.	SECTION	COUNTY	TOTAL SHEETS	SHEET NO.
505	115BR-1	WINNEBAGO	36	1

STATE OF ILLINOIS DEPARTMENT OF TRANSPORTATION DIVISION OF HIGHWAYS PLANS FOR PROPOSED FEDERAL AID HIGHWAY

FAP ROUTE 505 (IL 75)
SECTION 115BR-1
OVER TIMOTHY CREEK
WINNEBAGO COUNTY
PROJECT NO. BRF-0505(018)

C-92-083-06
R. 1 E. 3rd P.M.

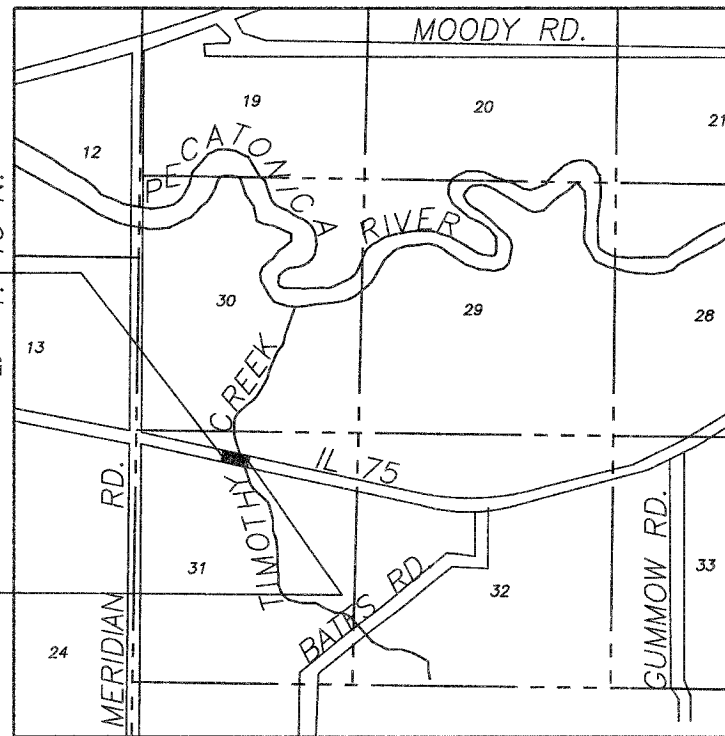

**IMPROVEMENT BEGINS
STA. 60 + 06**

**SECTION 115BR-1
INCLUDES THE REMOVAL OF EXISTING
STRUCTURE NO. 101-0114 AND
CONSTRUCTION OF THE NEW
STRUCTURE 101-0183, A THREE SIDED
STRUCTURE OVER TIMOTHY CREEK
AT STA 63 + 23.20**

**IMPROVEMENT ENDS
STA. 65 + 90**

NET LENGTH OF SECTION 584 FEET (0.111 MILES)
GROSS LENGTH OF SECTION 584 FEET (0.111 MILES)

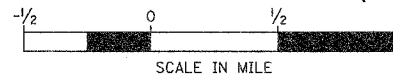

INDEX OF SHEETS

1. COVER SHEET
2. GENERAL NOTES
3. SUMMARY OF QUANTITIES
4. TYPICAL SECTIONS
5. VERTICAL AND HORIZONTAL CONTROL
- 6.-7. SCHEDULE OF QUANTITIES
8. PLAN AND PROFILE IL RTE 75
9. TRAFFIC CONTROL PLANS
- 10.-19. STRUCTURAL PLANS
- 20.-21. SOIL BORINGS
- 22.-29. EXISTING BRIDGE PLANS (FOR INFORMATION ONLY)
30. DETAIL OF BITUMINOUS SHOULDER AT GUARD RAIL (23.4)
- BITUMINOUS SHOULDER (23.4A)
- EROSION CONTROL DETAILS FOR SILT FENCE (29.2)
- DELINEATOR AND POST ORIENTATION (37.4)
- WITNESS MARKER FOR PERMANENT SURVEY MARKERS, TYPE II (38.4)
- INFORMATIONAL WARNING SIGN (FOR NARROW TRAVEL LANES) (39.4)
- STOP LINE SIGN FOR TEMPORARY SIGNALS (99.4)
- CROSS SECTIONS
- 31A. WITNESS MARKER + PERMANENT SURVEY MARKERS, TYPE II (44.2)

HIGHWAY STANDARDS

- | | |
|-----------|-------------------------------------------------------------------------------|
| 000001-04 | STANDARD SYMBOLS, ABBREVIATIONS AND PATTERNS |
| 001001 | AREA OF REINFORCEMENT BARS |
| 280001-02 | TEMPORARY EROSION CONTROL SYSTEMS |
| 482001 | BITUMINOUS SHOULDER ADJACENT TO FLEXIBLE PAVEMENT |
| 515001-02 | NAME PLATE FOR BRIDGES |
| 630001-06 | STEEL PLATE BEAM GUARDRAIL |
| 630201-03 | PCC/BITUMINOUS STABILIZATION AT STEEL PLATE BEAM GUARDRAIL |
| 630301-03 | SHOULDER WIDENING FOR TYPE 1 (SPECIAL) GUARDRAIL TERMINALS |
| 635001 | DELINEATORS |
| 635006-02 | REFLECTOR AND TERMINAL MARKER PLACEMENT |
| 635011-01 | REFLECTOR MARKER AND MOUNTING DETAILS |
| 667101 | PERMANENT SURVEY MARKERS |
| 701006-02 | OFF-ROAD OPERATIONS, 2L, 2W 4.5 M (15') TO 600 MM (24") FROM EDGE OF PAVEMENT |
| 701011-01 | OFF-ROAD OPERATIONS 2L, 2W, DAY ONLY |
| 701301-02 | LANE CLOSURE, 2L, 2W, SHORT TIME OPERATIONS |
| 701306-01 | LANE CLOSURE, 2L, 2W, SLOW MOVING OPERATIONS DAY ONLY, FOR SPEEDS ≥ 45 MPH |
| 701311-02 | LANE CLOSURE, 2L, 2W, MOVING OPERATIONS-DAY ONLY |
| 701321-08 | LANE CLOSURE, 2L, 2W, BRIDGE REPAIR WITH BARRIER |
| 701326-02 | LANE CLOSURE, 2L, 2W, PAVEMENT WIDENING, FOR SPEEDS ≥ 45 MPH |
| 702001-06 | TRAFFIC CONTROL DEVICES |
| 704001-02 | TEMPORARY CONCRETE BARRIER |
| 720011 | METAL POSTS FOR SIGNS, MARKERS AND DELINEATORS |
| 780001-01 | TYPICAL PAVEMENT MARKINGS |
| 781001-02 | TYPICAL APPLICATIONS RAISED REFLECTIVE PAVEMENT MARKERS |

TRAFFIC DATA

HIGHWAY CLASSIFICATION: RURAL MINOR ARTERIAL
2008 ADT = 2700
DESIGN SPEED 55 MPH
POSTED SPEED 55 MPH

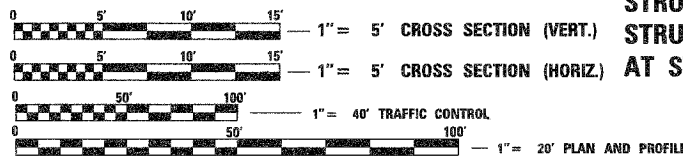

FULL SIZE PLANS HAVE BEEN PREPARED USING STANDARD ENGINEERING SCALES. REDUCED SIZED PLANS WILL NOT CONFORM TO STANDARD SCALES. IN MAKING MEASUREMENTS ON REDUCED PLANS, THE ABOVE SCALES MAY BE USED.

J.U.L.I.E.
JOINT UTILITY LOCATION INFORMATION FOR EXCAVATION
1-800-892-0123

CONTRACT NO. 64940

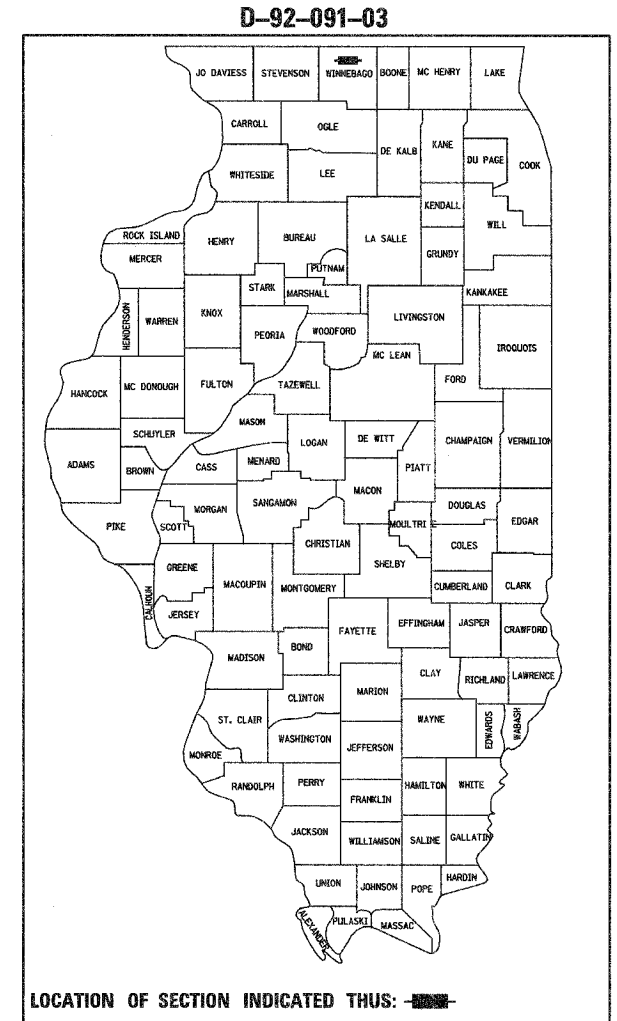

LOCATION OF SECTION INDICATED THUS: [shaded box]

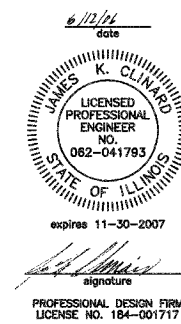

STATE OF ILLINOIS
DEPARTMENT OF TRANSPORTATION
DIVISION OF HIGHWAYS

SUBMITTED June 22, 2006
Gregory L. Mountain
DEPUTY DIRECTOR OF HIGHWAYS, REGION ENGINEER

August 18, 2006
Mike Hine
ENGINEER OF DESIGN AND ENVIRONMENT

August 18, 2006
Milton R. Sear
DIRECTOR OF HIGHWAYS, CHIEF ENGINEER

DISTRICT 2 DIXON IL

**PRINTED BY THE AUTHORITY
OF THE STATE OF ILLINOIS**

CHAMLIN & ASSOCIATES
PERU ILLINOIS MORRIS

PROJECT ENGINEER
BECKY MARRUFFO

SQUAD LEADER
THOMAS HALLA 815-284-5993

SENIOR SQUAD LEADER
MIKE YUSEF 815-284-5354

JAMES K. CLINARD
CHAMLIN & ASSOCIATES
815-223-3344