

F.A.I. SHEET NO.	SECTION	COUNTY	TOTAL SHEETS	SHEET NO.
39	150-1VB1-3	LASALLE	16	8
FED. ROAD DIST. NO.		ILLINOIS	NON-FED. AID PROJECT	

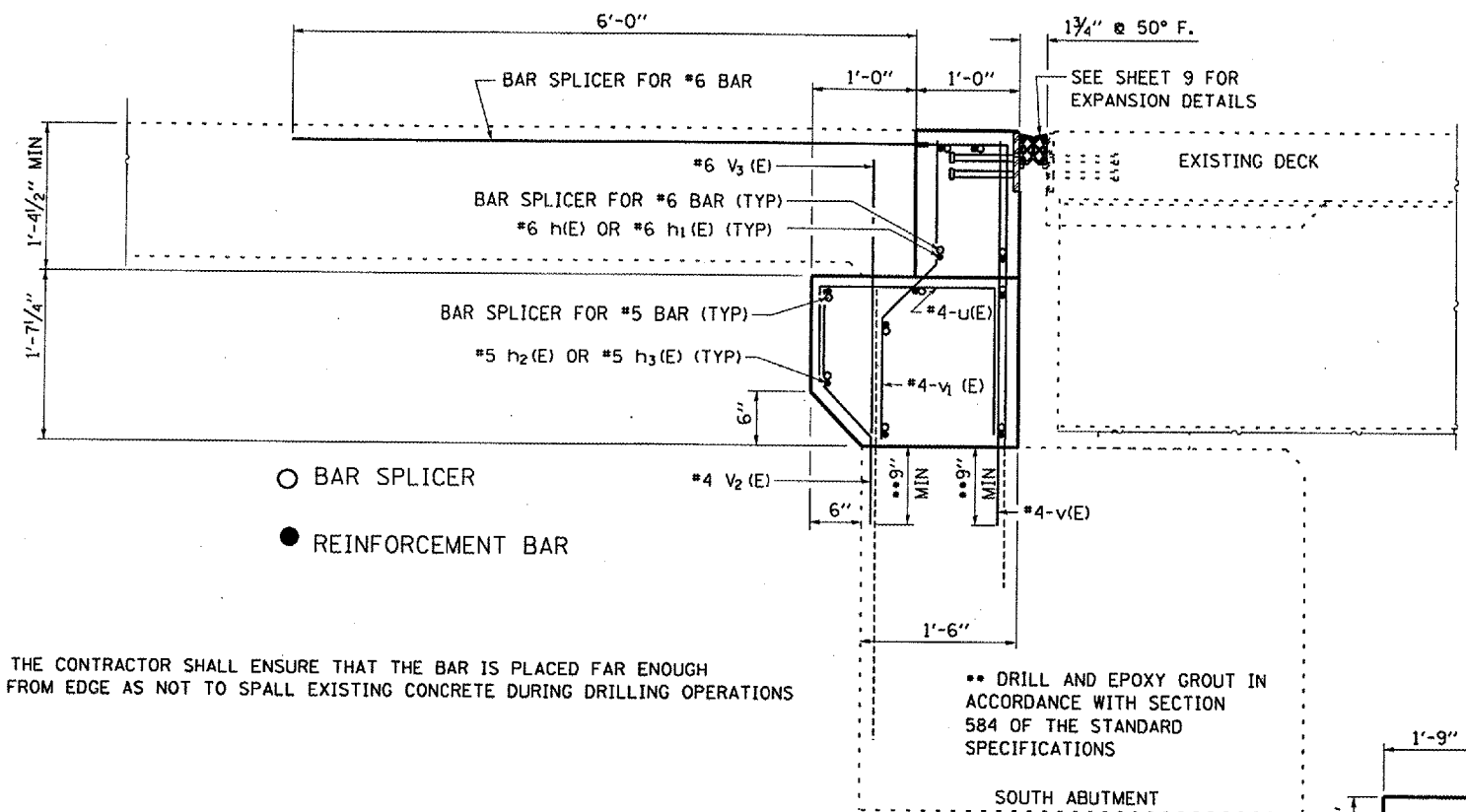

○ BAR SPLICER  
● REINFORCEMENT BAR

•• NOTE: THE CONTRACTOR SHALL ENSURE THAT THE BAR IS PLACED FAR ENOUGH FROM EDGE AS NOT TO SPALL EXISTING CONCRETE DURING DRILLING OPERATIONS

•• DRILL AND EPOXY GROUT IN ACCORDANCE WITH SECTION 584 OF THE STANDARD SPECIFICATIONS

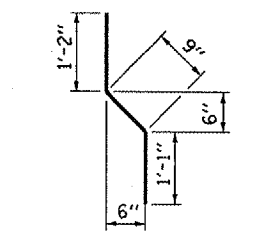

#4 V<sub>1</sub>(E) BAR

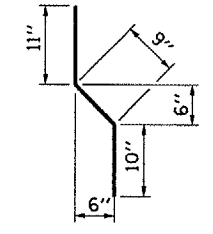

#4 V<sub>2</sub>(E) BAR

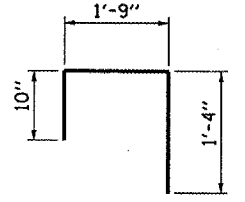

#4 u(E) BAR

**SECTION D-D**

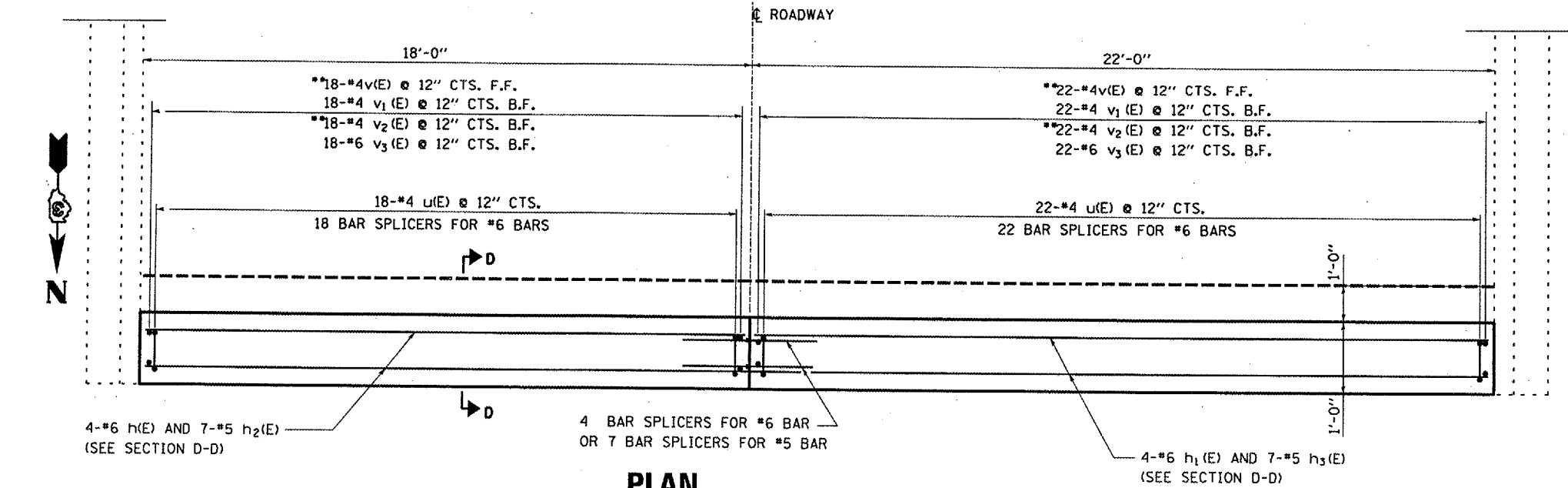

**PLAN SOUTH ABUTMENT**

NOTE: DETAILS SHOWN FOR NORTHBOUND STRUCTURE ONLY  
SOUTHBOUND STRUCTURE SAME THROUGH ROTATION

**GENERAL NOTES**

PLAN DIMENSIONS AND DETAILS RELATIVE TO EXISTING STRUCTURE OR ROADWAY HAVE BEEN TAKEN FROM EXISTING PLANS AND ARE SUBJECT TO NOMINAL CONSTRUCTION VARIATIONS. IT SHALL BE THE CONTRACTOR'S RESPONSIBILITY TO VERIFY SUCH DIMENSIONS AND DETAILS IN THE FIELD AND MAKE NECESSARY APPROVED ADJUSTMENTS PRIOR TO CONSTRUCTION OR ORDERING OF MATERIALS. SUCH VARIATIONS SHALL NOT BE CAUSE FOR ADDITIONAL COMPENSATION FOR A CHANGE IN THE SCOPE OF THE WORK, HOWEVER, THE CONTRACTOR WILL BE PAID FOR THE QUANTITY ACTUALLY FURNISHED AT THE UNIT PRICE FOR THE WORK.

ALL STRUCTURAL STEEL SHALL BE SHOP PAINTED WITH INORGANIC ZINC RICH PRIMER PER AASHTO M300 TYPE 1. COST INCLUDED WITH FURNISHING AND ERECTING STRUCTURAL STEEL.

BACK FILL SHALL BE PLACED BEHIND THE ABUTMENT AFTER THE END DAM HAS BEEN POURED AND THE FALSEWORK REMOVED. SEE ARTICLE 502.10 OF THE STANDARD SPECIFICATIONS.

ALL CONSTRUCTION JOINTS SHALL BE BONDED.

REINFORCEMENT BARS DESIGNATED (E) SHALL BE EPOXY COATED.

EXCAVATION BEHIND THE ABUTMENT SHALL BE DONE BEFORE REMOVING THE EXISTING BACKWALL. THE CONTRACTOR SHALL SAW CUT THE EXISTING ABUTMENTS AT THE STAGE REMOVAL LINE BEFORE STAGE I REMOVAL.

ALL SURFACES OF THE ABUTMENT AND WINGWALLS THAT WILL COME IN CONTACT WITH POROUS GRANULAR EMBANKMENT SHALL BE WATERPROOFED ACCORDING TO ARTICLE 503.18 OF THE STANDARD SPECIFICATIONS. COST OF THIS WORK SHALL BE ACCORDING TO ARTICLE 503.22 OF THE STANDARD SPECIFICATIONS.

**BILL OF MATERIALS FOR ONE ABUTMENT ONLY**

BAR	NO. BARS	SIZE	LENGTH	SHAPE
h(E)	4	6	17'-9"	—
h1(E)	4	6	21'-9"	—
h2(E)	7	5	17'-9"	—
h3(E)	7	5	21'-9"	—
u(E)	40	4	4'-9"	U
v(E)	40	4	3'-6"	—
v1(E)	40	4	3'-0"	—
v2(E)	40	4	2'-4"	—
v3(E)	40	6	2'-9"	—
CONCRETE REMOVAL			CU YD	5.6
CONCRETE SUPERSTRUCTURE			CU YD	6.6
FURNISHING AND ERECTING STRUCTURAL STEEL			POUNDS	760
REINFORCEMENT BARS			POUNDS	1040
EPOXY COATED				
BAR SPLICER			EACH	51

REVISIONS	
NAME	DATE

ILLINOIS DEPARTMENT OF TRANSPORTATION  
**ABUTMENT RECONSTRUCTION DETAILS**  
F.A.I. ROUTE 39 OVER NORFOLK SOUTHERN RAILROAD  
F.A.I. ROUTE 39 SECTION: (50-1VB)I-3  
LASALLE COUNTY  
STA. 565+86.08

Date: 05/09/2006  
P:\1st\civ\proj\se15\csm\m07\cm303\cmr\11s.dgn