

F.A.S. RTE.	SECTION	COUNTY	TOTAL SHEETS	SHEET NO.
1671		DOUGLAS	181	22

STA.	TO STA.
FED. ROAD DIST. NO.	ILLINOIS FED. AID PROJECT
• 144SBR-2 & 22VBR-1	

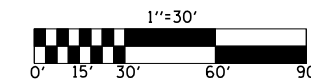

TYPICAL PAVEMENT MARKING LEGEND

- LIGHTED DRUMS ON 50' CENTERS
 - ⊥ TYPE 3 BARRICADE WITH LIGHTS
 - 4 4" (100) DOUBLE YELLOW (NARROW)
 - 8 4" (100) SOLID (WHITE)
 - 9 12" (300) DIAGONAL (WHITE)
 - 11 24" (600) STOP BAR (WHITE)
-

STRIPING WILL BE PAID FOR AS "TEMPORARY PAVEMENT MARKING" OF THE WIDTH SPECIFIED.

ALL SIGNS, DRUMS BARRICADES AND LIGHTS TO BE INCLUDED IN "TRAFFIC CONTROL & PROTECTION (DETOUR 1)"

PRE-STAGE TRAFFIC CONTROL

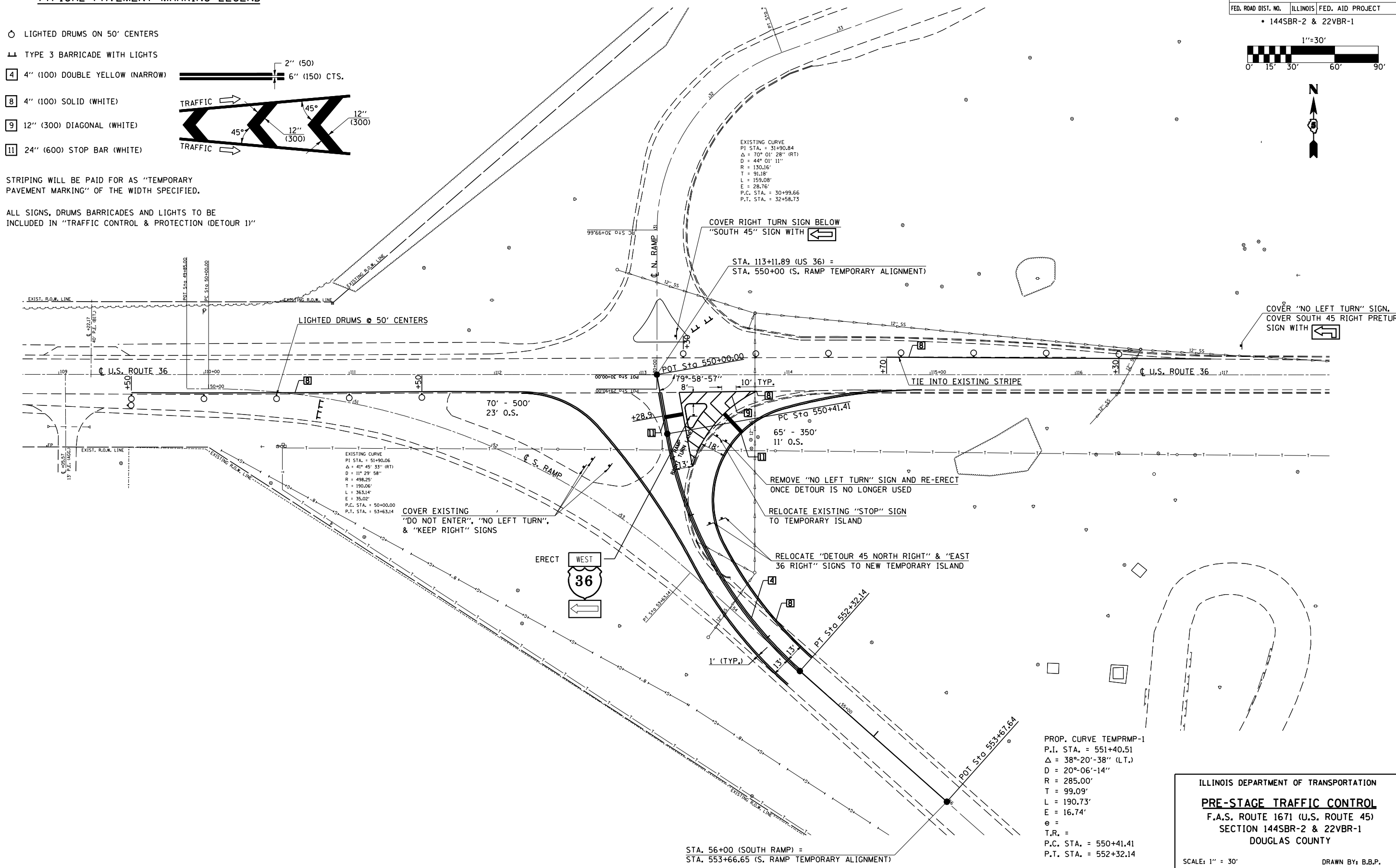

EXISTING CURVE
 P.I. STA. = 51+90.06
 $\Delta = 41^\circ 45' 33''$ (RT)
 $D = 11^\circ 29' 58''$
 $R = 498.25'$
 $T = 190.06'$
 $L = 363.14'$
 $E = 35.02'$
 P.C. STA. = 50+00.00
 P.T. STA. = 53+63.14

EXISTING CURVE
 P.I. STA. = 31+30.84
 $\Delta = 70^\circ 01' 28''$ (RT)
 $D = 44^\circ 01' 11''$
 $R = 130.16'$
 $T = 91.18'$
 $L = 159.08'$
 $E = 28.76'$
 P.C. STA. = 30+99.66
 P.T. STA. = 32+58.73

PROP. CURVE TEMPRMP-1
 P.I. STA. = 551+40.51
 $\Delta = 38^\circ 20' 38''$ (LT.)
 $D = 20^\circ 06' 14''$
 $R = 285.00'$
 $T = 99.09'$
 $L = 190.73'$
 $E = 16.74'$
 $e =$
 $T.R. =$
 P.C. STA. = 550+41.41
 P.T. STA. = 552+32.14

ILLINOIS DEPARTMENT OF TRANSPORTATION
PRE-STAGE TRAFFIC CONTROL
 F.A.S. ROUTE 1671 (U.S. ROUTE 45)
 SECTION 144SBR-2 & 22VBR-1
 DOUGLAS COUNTY

SCALE: 1" = 30'
 DATE: 06/14/06
 DRAWN BY: B.B.P.
 CHECKED BY: C.R.G.

PLOT DATE = 7/10/2006
 FILE NAME = c:\projects\05202 (v8)\70258tr-trafficcontrol.dgn
 PLOT SCALE = 63.5294 / IN.
 USER NAME = piersebr