

F.A.S. RTE.	SECTION	COUNTY	TOTAL SHEETS	SHEET NO.
1671		DOUGLAS	181	33
STA. 1157+00		TO STA. 1163+00		
FED. ROAD DIST. NO.		ILLINOIS FED. AID PROJECT		
• 144SBR-2 & 22VBR-1				

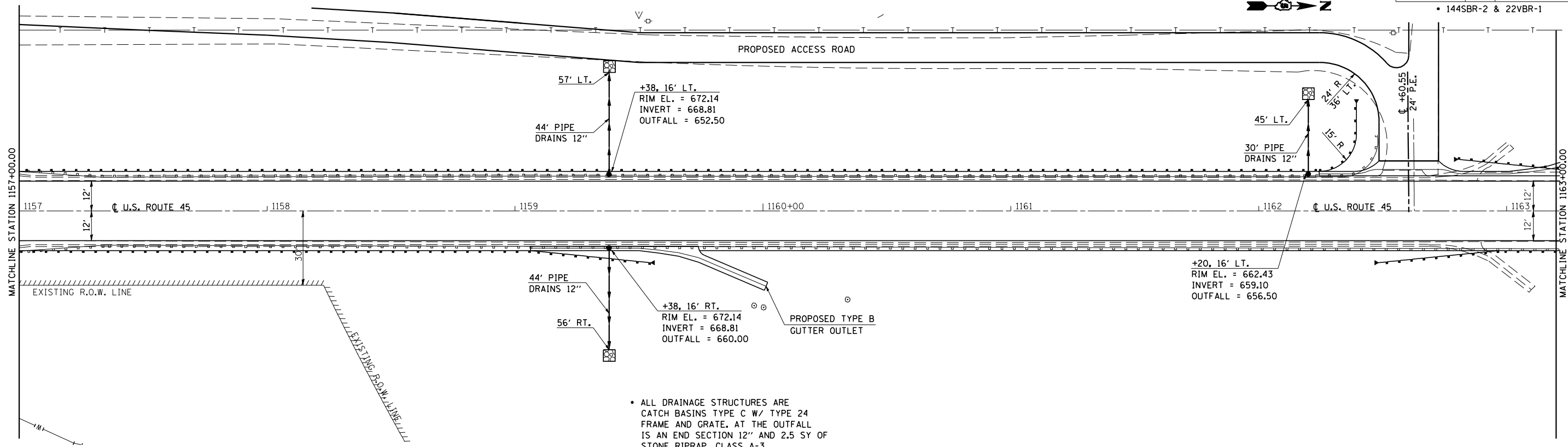
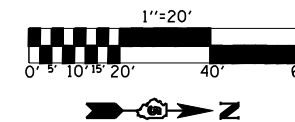

• ALL DRAINAGE STRUCTURES ARE CATCH BASINS TYPE C W/ TYPE 24 FRAME AND GRATE. AT THE OUTFALL IS AN END SECTION 12" AND 2.5 SY OF STONE RIPRAP, CLASS A-3

PLAN	SURVEYED	BY	DATE
	PLOTTED		
	NOTE BOOK		
	NO. OF WAY CHECKED		
	NO. OF STRUCTURE NOTATIONS CHECKED		
	NO. OF CADD FILE NAME		

PROFILE	SURVEYED	BY	DATE
	PLOTTED		
	NOTE BOOK		
	NO. OF WAY CHECKED		
	NO. OF STRUCTURE NOTATIONS CHECKED		

PLOT DATE = 7/10/2006
 FILE NAME = c:\projects\4505202 (v8)\pl&pr-20.dgn
 PLOT SCALE = 42.3529 / IN.
 USER NAME = craigr

