

F.A.S. RTE.	SECTION	COUNTY	TOTAL SHEETS	SHEET NO.
1671	.	DOUGLAS	181	36
STA. 1127+75.00		TO STA. 1132+50.00		
FED. ROAD DIST. NO.	ILLINOIS	FED. AID PROJECT		

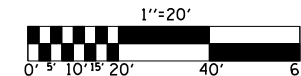

• 144SBR-2 & 22VBR-1

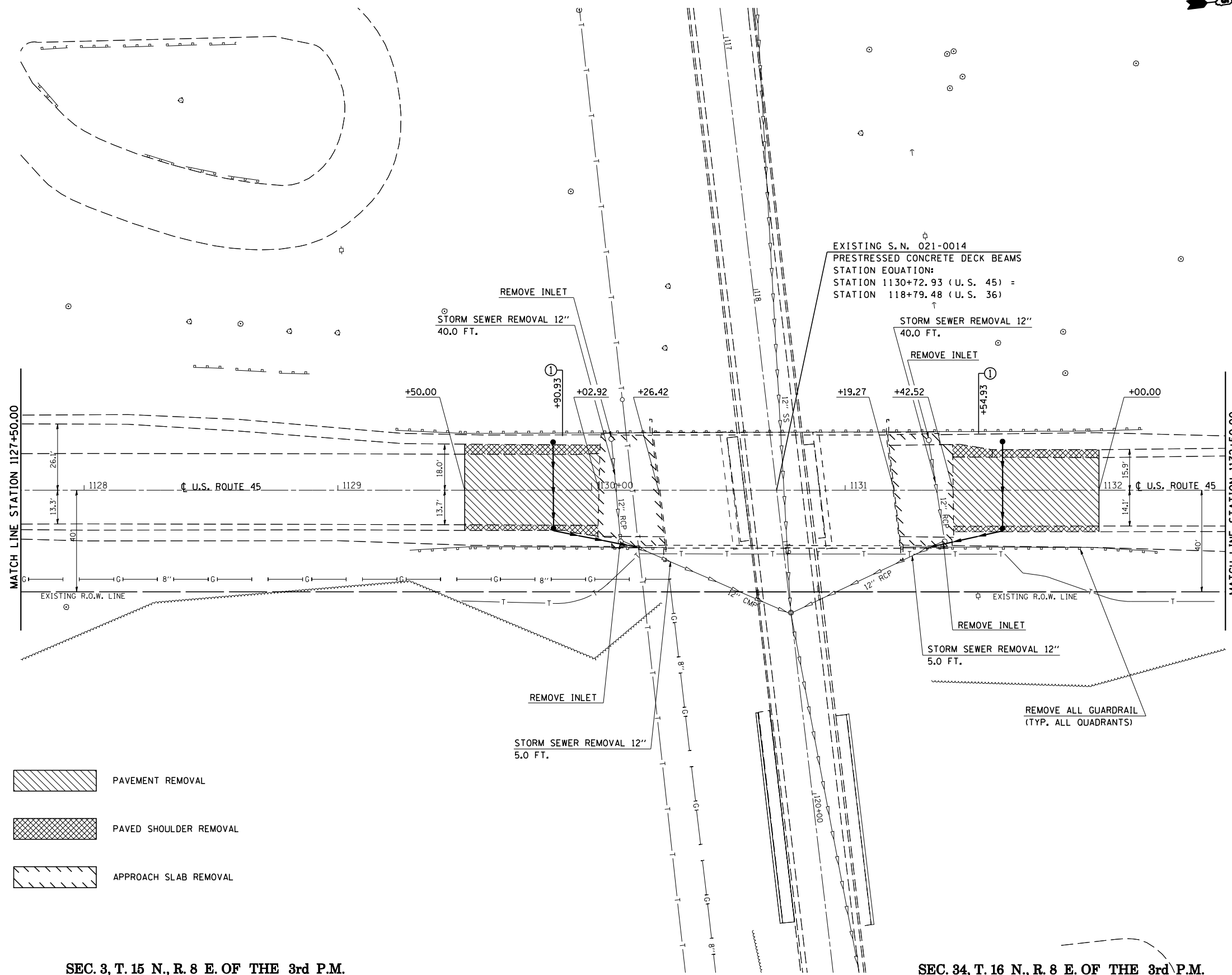

SEC. 3, T. 15 N., R. 8 E. OF THE 3rd P.M.

SEC. 33, T. 16 N., R. 8 E. OF THE 3rd P.M.

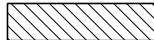

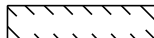
-  PAVEMENT REMOVAL
-  PAVED SHOULDER REMOVAL
-  APPROACH SLAB REMOVAL

SEC. 3, T. 15 N., R. 8 E. OF THE 3rd P.M.

SEC. 34, T. 16 N., R. 8 E. OF THE 3rd P.M.

ILLINOIS DEPARTMENT OF TRANSPORTATION
REMOVAL PLAN
 F.A.S. ROUTE 1671 (U.S. ROUTE 45)
 SECTION 144SBR-2 & 22VBR-1
 DOUGLAS COUNTY

SCALE: 1" = 20'-0"
DATE: 05/31/06

DRAWN BY: B.B.P.
CHECKED BY: C.R.G.

PLOT DATE = 7/10/2006
 FILE NAME = c:\projects\144SBR-2\144SBR-2.dgn
 USER NAME = crg