

F.A.S. RTE.	SECTION	COUNTY	TOTAL SHEETS	SHEET NO.
1671	.	DOUGLAS	181	44
STA. 1122+00.00		TO STA. 1127+75.00		
FED. ROAD DIST. NO.	ILLINOIS	FED. AID PROJECT		

• 144SBR-2 & 22VBR-1

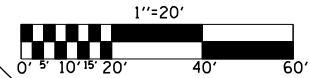

SEC. 3, T. 15 N., R. 8 E. OF THE 3rd P.M.



EXISTING CURVE  
 PI STA. = 58+02.82  
 $\Delta = 35^\circ 01' 41''$  (LT)  
 D = 27° 20' 43"  
 R = 209.53'  
 T = 66.12'  
 L = 128.10'  
 E = 10.19'  
 P.C. STA. = 57+36.70  
 P.T. STA. = 58+64.80

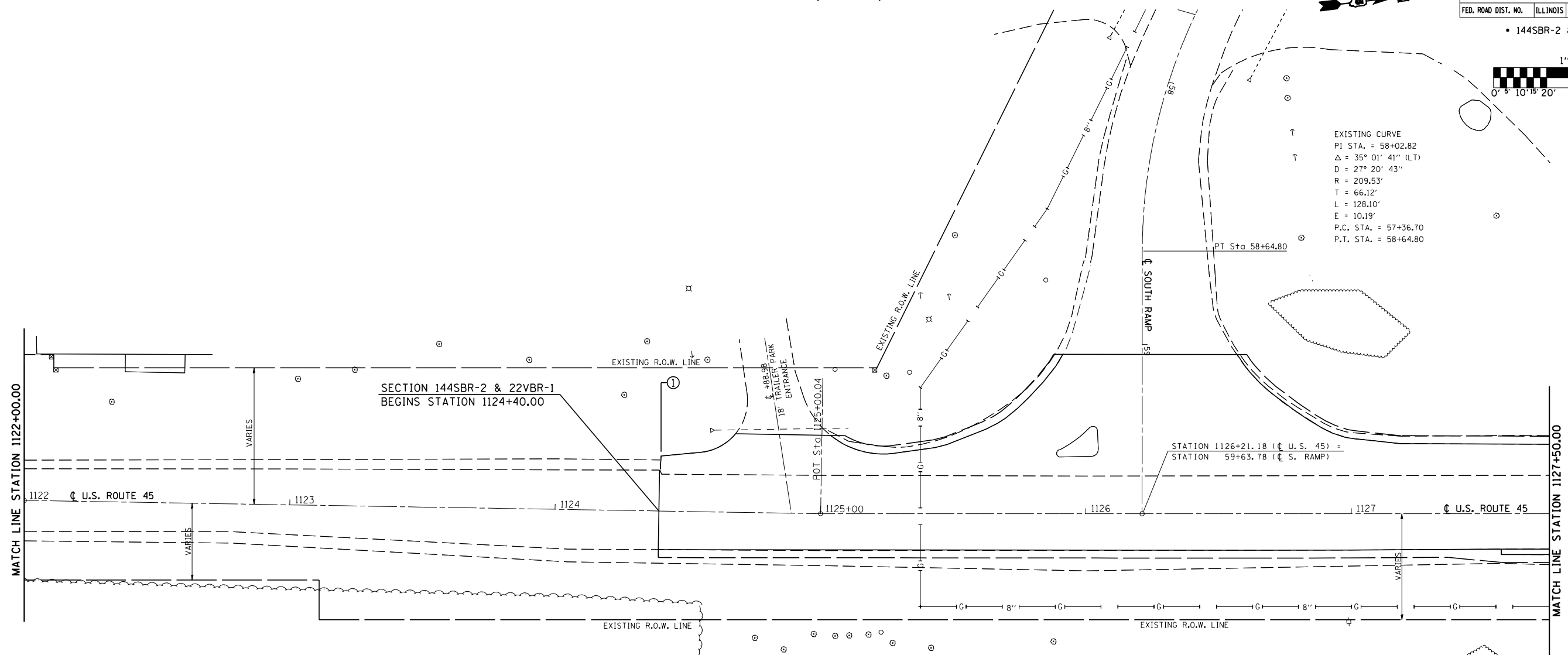

SEC. 3, T. 15 N., R. 8 E. OF THE 3rd P.M.

ILLINOIS DEPARTMENT OF TRANSPORTATION  
**EROSION CONTROL PLAN**  
 F.A.S. ROUTE 1671 (U.S. ROUTE 45)  
 SECTION 144SBR-2 & 22VBR-1  
 DOUGLAS COUNTY

SCALE: 1" = 20'-0"  
 DATE: 06/02/06

DRAWN BY: B.B.P.  
 CHECKED BY: C.R.G.

PLOT DATE = 7/10/2006  
 FILE NAME = c:\projects\144SBR-2 & 22VBR-1\144SBR-2 & 22VBR-1.dgn  
 USER NAME = crg