

STATE OF ILLINOIS
DEPARTMENT OF TRANSPORTATION

ROUTE NO.	SECTION	COUNTY	TOTAL SHEETS	SHEET NO.
FAP 332	47BR-2	VERMILION	68	25
FED. ROAD DIST. NO. 7	ILLINOIS	FED. AID PROJECT		

SHEET NO. 6
23 SHEETS

Contract #70420

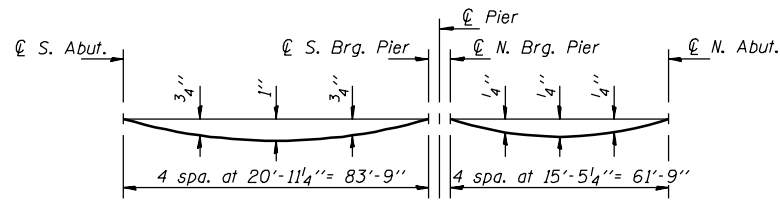

DEAD LOAD DEFLECTION DIAGRAM

(Includes weight of concrete, excluding beams).

Notes: The above deflections are not to be used in the field if the Engineer is working from the grade elevations adjusted for dead load deflections and grinding as shown below and on sheets 7 & 8 of 23.

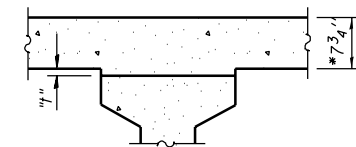

To determine "f": After all precast prestressed beams have been erected, elevations of the top flanges of the beams shall be taken at intervals shown below. These elevations subtracted from the "Theoretical Grade Elevations Adjusted for Dead Load Deflections and Grinding" shown below and on sht. 7 of 23, minus 7 3/4" deck thickness, equals the fillet heights "f" above top flanges of beams.

The slab is to be ground after curing to achieve smoothness, but the slab is not to be ground to elevations below the "Theoretical Grade Elevations" shown below and on sheet 7 of 23. For grinding the deck, see Special Provisions.

FILLET HEIGHTS

*Prior to grinding

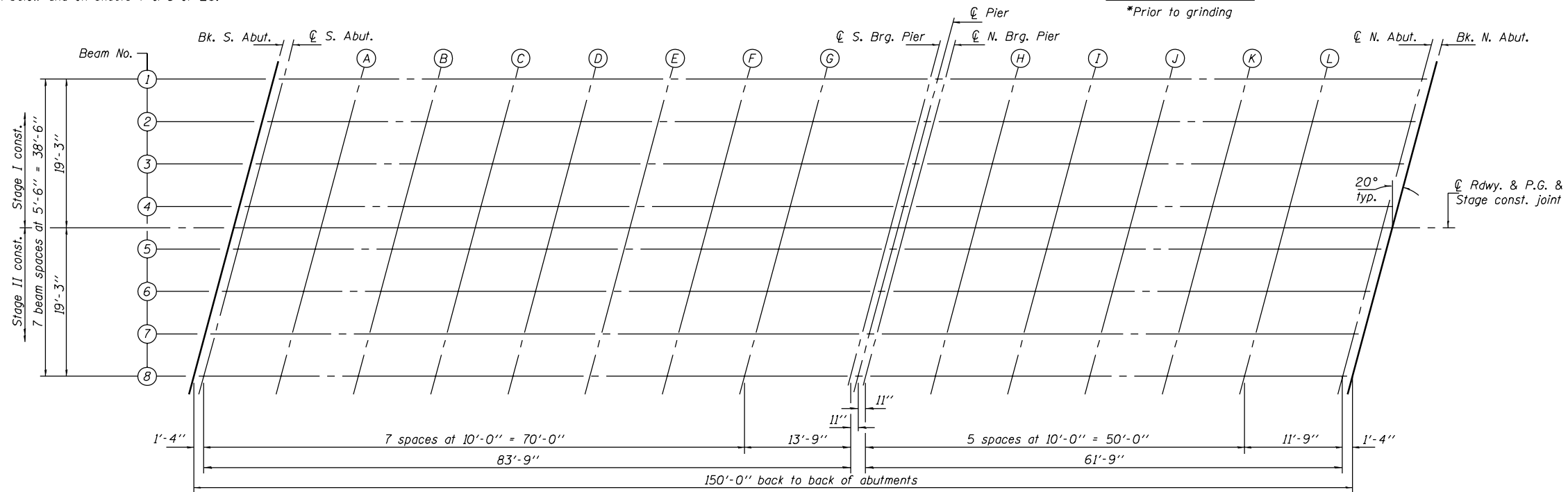

PLAN

BEAM 1

Location	Station	Offset	Theoretical Grade Elevations	Theoretical Grade Elevations Adjusted for Dead Load Deflection & Grinding
Bk. S. Abut.	252204.01	-19.25	623.08	623.10
CL S. Abut.	252205.34	-19.25	623.11	623.13
A	252215.34	-19.25	623.34	623.39
B	252225.34	-19.25	623.57	623.65
C	252235.34	-19.25	623.8	623.89
D	252245.34	-19.25	624.03	624.13
E	252255.34	-19.25	624.26	624.35
F	252265.34	-19.25	624.49	624.57
G	252275.34	-19.25	624.72	624.78
CL S. Brg. Pier	252289.09	-19.25	625.03	625.05
CL Pier	252290.01	-19.25	625.05	625.07
CL N. Brg. Pier	252290.92	-19.25	625.08	625.10
H	252300.92	-19.25	625.31	625.34
I	252310.92	-19.25	625.53	625.57
J	252320.92	-19.25	625.76	625.81
K	252330.92	-19.25	625.99	626.03
L	252340.92	-19.25	626.22	626.26
CL N. Abut.	252352.68	-19.25	626.49	626.51
Bk. N. Abut.	252354.01	-19.25	626.52	626.54

BEAM 2

Location	Station	Offset	Theoretical Grade Elevations	Theoretical Grade Elevations Adjusted for Dead Load Deflection & Grinding
Bk. S. Abut.	252202.00	-13.75	623.15	623.17
CL S. Abut.	252203.33	-13.75	623.18	623.20
A	252213.33	-13.75	623.41	623.46
B	252223.33	-13.75	623.64	623.72
C	252233.33	-13.75	623.87	623.96
D	252243.33	-13.75	624.10	624.20
E	252253.33	-13.75	624.33	624.42
F	252263.33	-13.75	624.56	624.64
G	252273.33	-13.75	624.79	624.84
CL S. Brg. Pier	252287.09	-13.75	625.10	625.12
CL Pier	252288.00	-13.75	625.12	625.14
CL N. Brg. Pier	252288.92	-13.75	625.14	625.16
H	252298.92	-13.75	625.37	625.40
I	252308.92	-13.75	625.60	625.64
J	252318.92	-13.75	625.83	625.88
K	252328.92	-13.75	626.06	626.10
L	252338.92	-13.75	626.29	626.33
CL N. Abut.	252350.67	-13.75	626.56	626.58
Bk. N. Abut.	252352.00	-13.75	626.59	626.61

DESIGNED	D. P. Narielwala
CHECKED	S. M. Ryan
DRAWN	h.t. duong
CHECKED	DPN/SMR

August 4, 2006
EXAMINED *Thomas J. Damagala*
PASSED *Ralph E. Anderson*
ENGINEER OF BRIDGES DESIGN
ENGINEER OF BRIDGES AND STRUCTURES

TOP OF SLAB ELEVATIONS
F.A.P. RTE. 332 - SEC. 47BR-2
VERMILION COUNTY
STATION 2522+72.00
STRUCTURE NO. 092-0206