

F.A.P. RTE.	SECTION	COUNTY	TOTAL SHEETS	SHEET NO.
817	8BR-3	WASHINGTON	52	36
STA. 33+15		TO STA. 39+25		
FED. ROAD DIST. NO.		ILLINOIS FED. AID PROJECT		

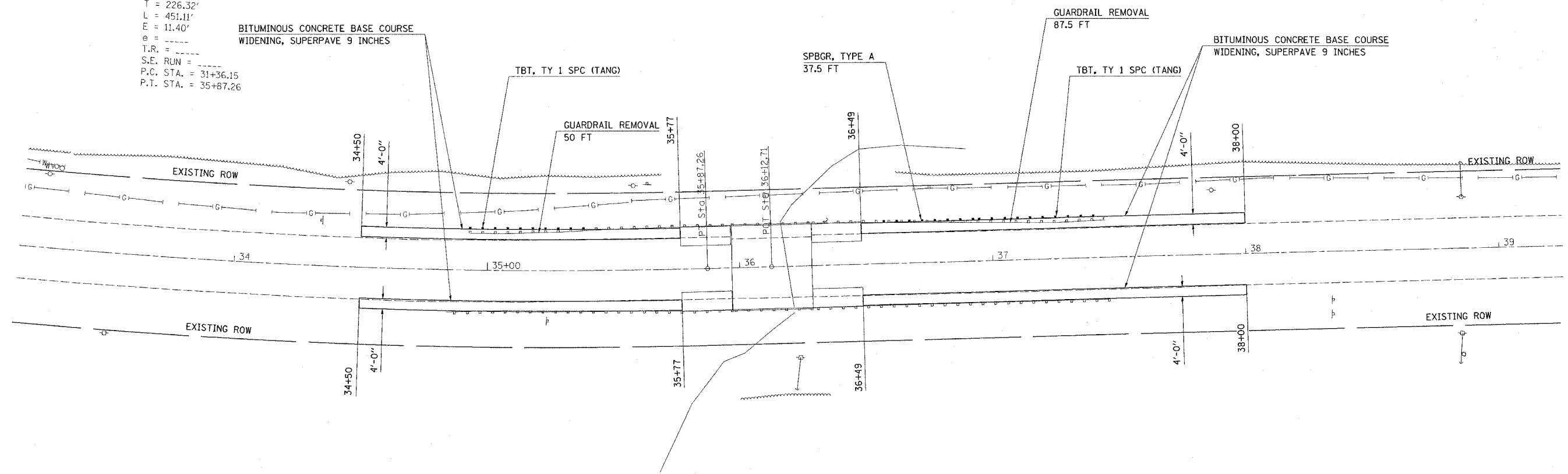

EXIST. CURVE C2
 PI STA. = 33+62.47
 $\Delta = 11^\circ 32' 20''$ (LT)
 $D = 2^\circ 33' 28''$
 $R = 2,240.00'$
 $T = 226.32'$
 $L = 451.11'$
 $E = 11.40'$
 $e =$
 $T.R. =$
 $S.E. RUN =$
 P.C. STA. = 31+36.15
 P.T. STA. = 35+87.26



PRE-STAGE I DESCRIPTION OF WORK:

REMOVE EXISTING GUARDRAIL THAT WILL CONFLICT WITH PROPOSED WIDENING. (50 FT IN NW QUADRANT AND 87.5 FT IN NE QUADRANT) THIS INCLUDES EXISTING END SECTIONS.

PLACE TBT, TYPE 1 SPECIAL (TANGENT) IN NW QUADRANT.

PLACE 37.5 FT OF TEMPORARY STEEL PLATE BEAM GUARDRAIL AND TBT, TYPE 1 SPECIAL (TANGENT) IN NE QUADRANT.

PLACE "BITUMINOUS CONCRETE BASE COURSE WIDENING, SUPERPAVE 9 INCHES" TO ALLOW FOR TRAFFIC IN STAGE I AND II.

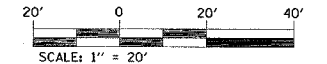

REVISIONS	
NAME	DATE

ILLINOIS DEPARTMENT OF TRANSPORTATION
STAGE CONSTRUCTION
PRE-STAGE I
 FAP ROUTE 817
 SECTION 8BR-3
 WASHINGTON COUNTY
 SN 095-0011

PLOT DATE = 7/18/2006
 FILE NAME = c:\p\proj\817\8br3\plan\15g8995.blodgn
 PLOT SCALE = 20/0000 / 1 IN.
 USER NAME = c:\msd\j