

| F.A.P. RTE.         | SECTION  | COUNTY           | TOTAL SHEETS | SHEET NO. |
|---------------------|----------|------------------|--------------|-----------|
| 817                 | 8BR-3    | WASHINGTON       | 52           | 37        |
| STA. 33+15          |          | TO STA. 39+25    |              |           |
| FED. ROAD DIST. NO. | ILLINOIS | FED. AID PROJECT |              |           |

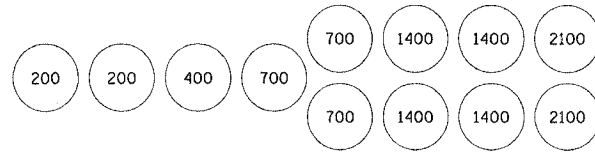

**LEGEND**

- IMPACT ATTENUATOR
- TEMPORARY CONCRETE BARRIER
- BARRELS OR BARRICADES WITH STEADY BURNING LIGHT
- TEMPORARY BRIDGE TRAFFIC SIGNALS
- TYPE III BARRICADE



SAND BARREL LAYOUT  
(IF OPTION USED)

EXIST. CURVE C2  
 PI STA. = 33+62.47  
 $\Delta = 11^\circ 32' 20''$  (LT)  
 $D = 2^\circ 33' 28''$   
 $R = 2,240.00'$   
 $T = 226.32'$   
 $L = 451.11'$   
 $E = 11.40'$   
 $e = \text{---}$   
 T.R. =  $\text{---}$   
 S.E. RUN =  $\text{---}$   
 P.C. STA. = 31+36.15  
 P.T. STA. = 35+87.26

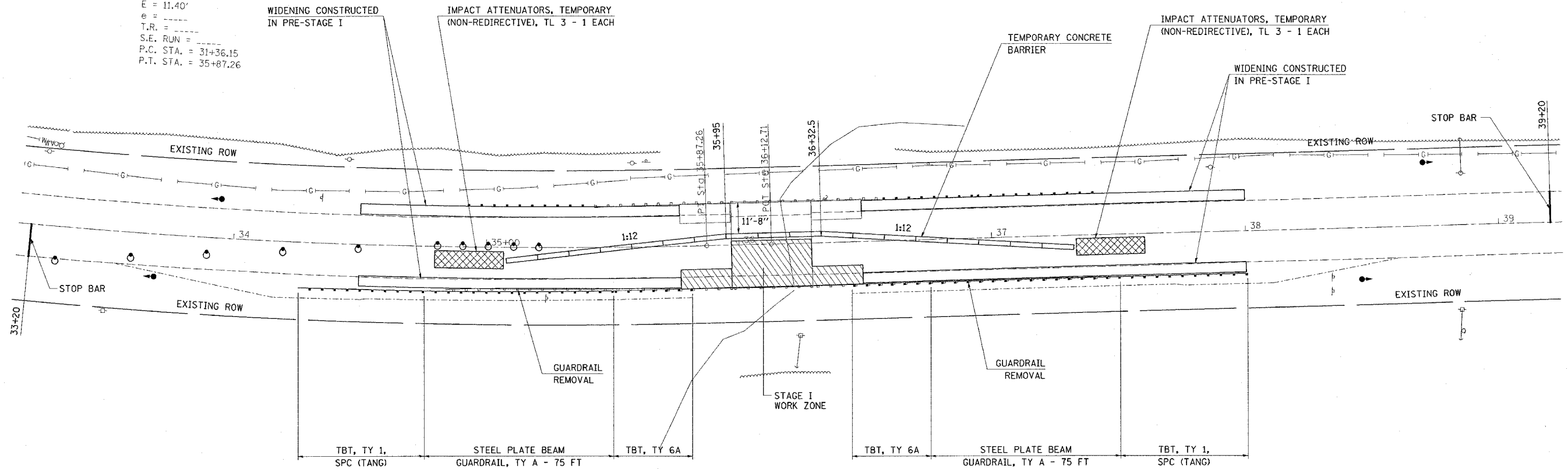

**SEQUENCE OF CONSTRUCTION:**

THE CONTRACTOR SHALL GIVE ILLINOIS DEPARTMENT OF TRANSPORTATION, BUREAU OF OPERATIONS TWO WEEKS NOTICE FOR PREPARATION OF THE STATE FURNISHED TRAFFIC CONTROLLER. THE CONTRACTOR SHALL PICK UP THE TRAFFIC CONTROLLER AT THE T.M. BUILDING.

PLACE STOP BARS AS SHOWN ON PLANS.

PLACE TEMPORARY RUMBLE STRIPS (3 EACH) WEST OF STRUCTURE FOR EASTBOUND TRAFFIC.

REMOVE CENTERLINE AND CONFLICTING SOLID EDGE PAVEMENT MARKINGS BETWEEN STOP BARS.

PLACE 225 FT TEMPORARY CONCRETE BARRIER AND 2 EACH IMPACT ATTENUATORS, TEMPORARY.

SEE STANDARD 701321 FOR DETAILS NOT SHOWN ON PLANS.

PERFORM ALL NECESSARY BRIDGE WORK IN STAGE I WORK ZONE.

REMOVE EXISTING GUARDRAIL ON SOUTH SIDE AND REPLACE WITH PROPOSED TBT, TYPE 6A, STEEL PLATE BEAM GUARDRAIL, TYPE A AND TBT, TYPE 1 (SPECIAL) TANGENT IN SW AND SE QUADRANTS.



| REVISIONS |      |
|-----------|------|
| NAME      | DATE |
|           |      |
|           |      |
|           |      |
|           |      |
|           |      |
|           |      |
|           |      |
|           |      |
|           |      |
|           |      |

ILLINOIS DEPARTMENT OF TRANSPORTATION  
**STAGE CONSTRUCTION**  
**STAGE I**  
 FAP ROUTE 817  
 SECTION 8BR-3  
 WASHINGTON COUNTY  
 SN 095-0011

PLOT DATE = 7/19/2006  
 FILE NAME = c:\p0\mcs\w888888\plan\tag888888.bltdgn  
 PLOT SCALE = 20.0000 / IN.  
 USER NAME = owerbj