

ROUTE	SECTION	COUNTY	TOTAL SHEETS	SHEET NO.
*	**	***	52	32
STA.		TO STA.		
FED. ROAD DIST. NO.	ILLINOIS	FED. AID PROJECT		
* FAI 55/70		CONTRACT# 76973		
** DIST 8 ITS 2006-2				
*** MADISON & ST. CLAIR & CITY OF ST. LOUIS, MO				

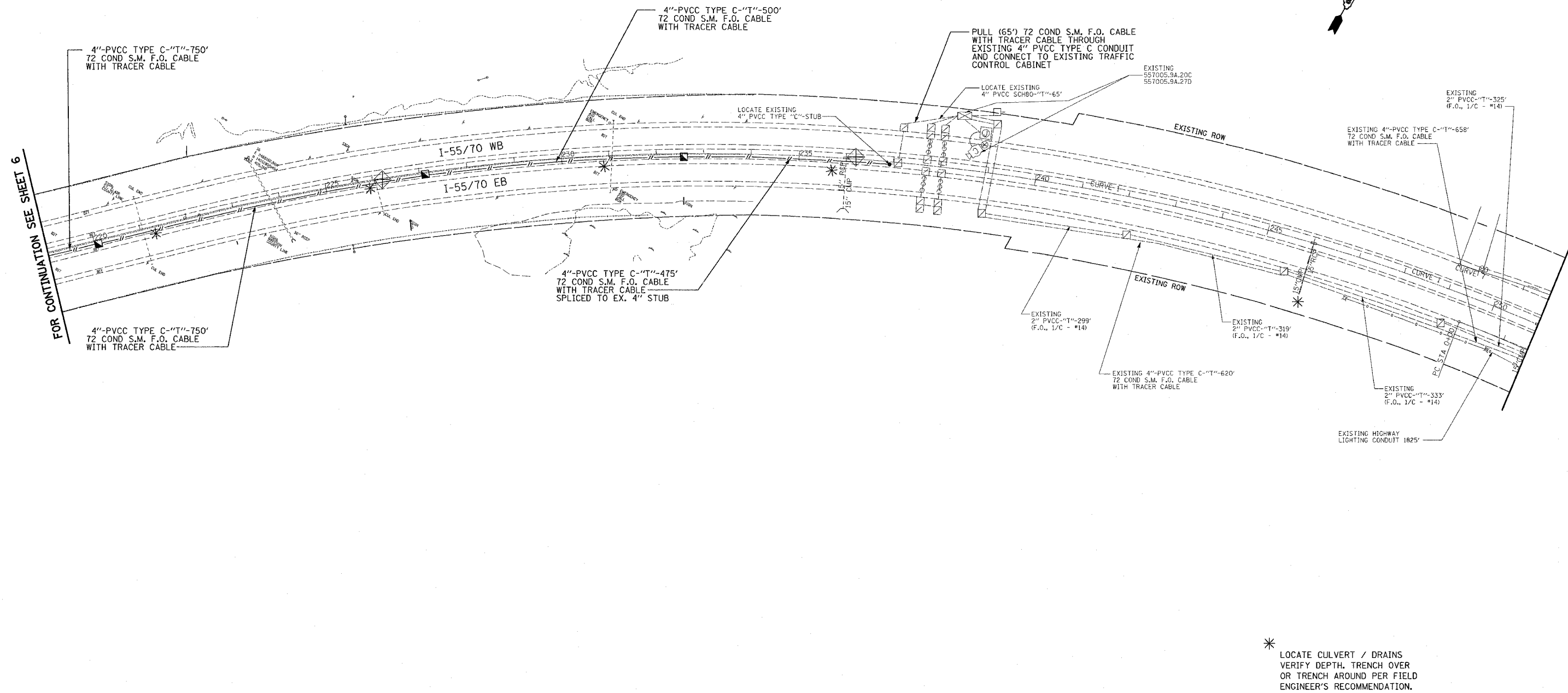

FOR CONTINUATION SEE SHEET 6

* LOCATE CULVERT / DRAINS
VERIFY DEPTH, TRENCH OVER
OR TRENCH AROUND PER FIELD
ENGINEER'S RECOMMENDATION.

SHEET 17 OF 18

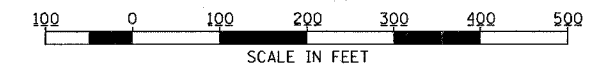

REVISIONS	
NAME	DATE

ILLINOIS DEPARTMENT OF TRANSPORTATION
LOCATION 557005.9A.20C(EX.)
LOCATION 557005.9A.27D(EX.)
FAI 55/70
SECTION DIST 8 ITS 2006-2
MADISON AND ST. CLAIR COUNTY
AND ST. LOUIS, MO
DATE 5/23/2006

PLOT DATE = 5/23/2006
 FILE NAME = \\ed11585\electrical\top\11585a.dgn
 PLOT SCALE = 1/8\"/>