

FAU	SECTION	COUNTY	TOTAL SHEETS	SHEET NO.
2647	99-00142-07-WR	LAKE	256	17
CONTRACT NO: 83815				
FED. ROAD DIST. NO. 1 ILLINOIS FED. AID PROJECT				

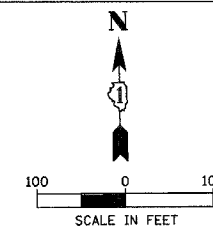

PROP. CURVE WINCHEST  
 PI STA. = 48+54.09  
 $\Delta = 9^\circ 22' 30''$  (LT)  
 $D = 1^\circ 15' 00''$   
 $R = 4,583.75'$   
 $T = 375.85'$   
 $L = 750.01'$   
 $E = 15.38'$   
 P.C. STA = 44+78.24  
 P.T. STA = 52+28.25  
 $SE = 2.7\%$

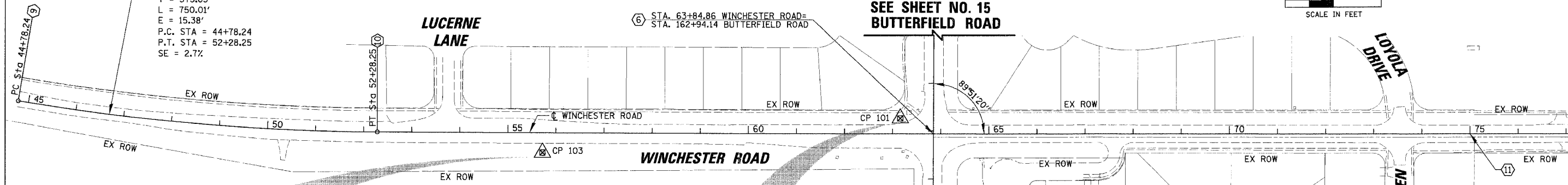

⑥ STA. 63+84.86 WINCHESTER ROAD=  
 STA. 162+94.14 BUTTERFIELD ROAD

SEE SHEET NO. 15  
 BUTTERFIELD ROAD

BUTTERFIELD ROAD  
 SEE SHEET NO. 15

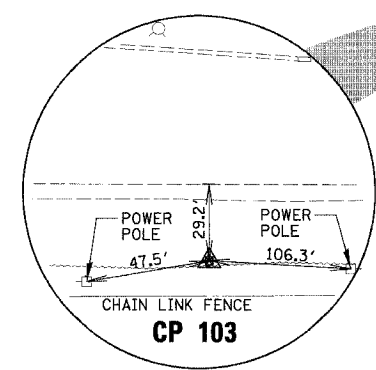

CP 103  
 STA. 55+70.02  
 OFFSET 50.83' RT  
 SET IRON PIPE  
 $N = 2050302.98$   
 $E = 1078039.46$   
 $EL = 737.27$

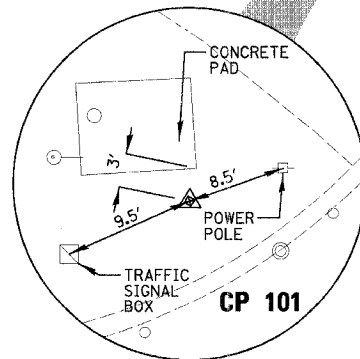

CP 101  
 STA. 163+31.97  
 OFFSET 46.47' LT  
 SET IRON PIPE  
 $N = 2050390.42$   
 $E = 1078808.07$   
 $EL = 731.24$

NOTE: PK NAILS HAVE BEEN SET AT ALL+00 STATIONS AT PROPOSED CENTERLINES

9 EACH - SURVEY MONUMENTS (INSTALL ONLY) TO BE INSTALLED BY CONTRACTOR AT ALIGNMENT POINT NUMBERS 3, 4, 5, 6, 7, 8, 9, 10, AND 11.

\* MONUMENT

ALIGNMENT POINTS					
ID. #	STATION	OFFSET	NORTHING (Y)	EASTING (X)	DESCRIPTION
* ⑨	44+78.24	CL	2,050,416.92	1,076,951.21	PC
* ⑩	52+28.25	CL	2,050,354.40	1,077,697.78	PT
* ⑥	63+84.86	CL	2,050,352.40	1,078,854.38	CL-CL
* ⑪	75+00.00	CL	2,050,350.47	1,079,969.52	75+00

REVISIONS	
NAME	DATE

ILLINOIS DEPARTMENT OF TRANSPORTATION  
**FAU 2647 - BUTTERFIELD ROAD  
 ALIGNMENT, TIES AND BENCHMARKS  
 WINCHESTER ROAD**  
 SCALE: 1:100  
 DATE: 12/2/2005  
 DRAWN BY: ELA  
 CHECKED BY: JRM

N:\LIBERTYVILLE\99-389\CIVIL\99389.TBL  
 N:\LIBERTYVILLE\99-389\CIVIL\99389-03.bnh  
 11:00  
 12/2/2005