

FAU	SECTION	COUNTY	TOTAL SHEET NO.
2647	99-00142-07-WR	LAKE	256 21
CONTRACT NO: 83815			
FED. ROAD DIST. NO. 1 ILLINOIS FED. AID PROJECT			

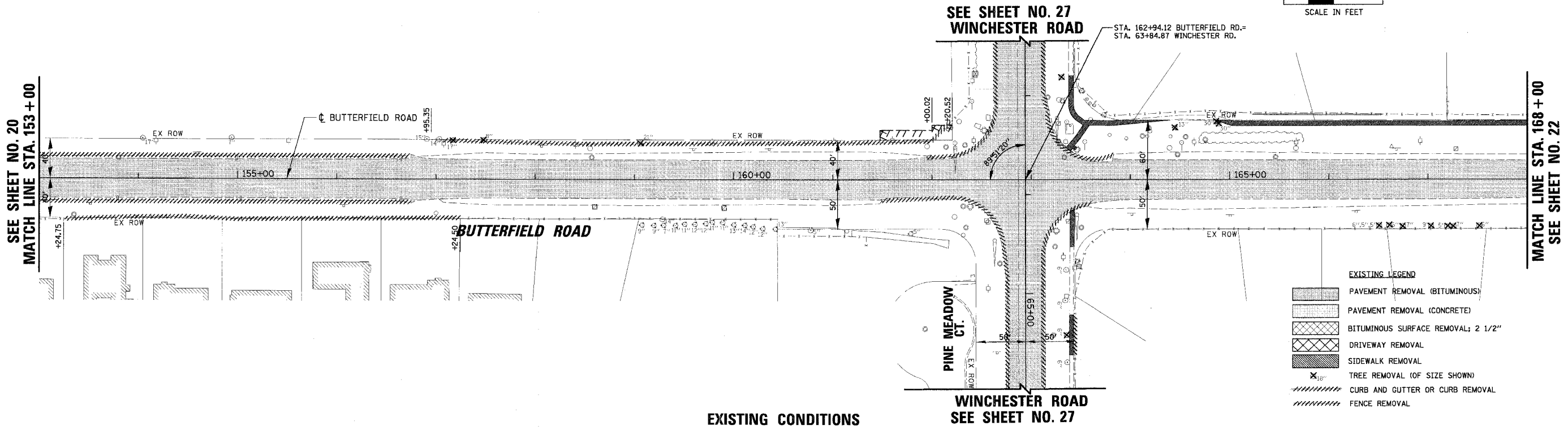
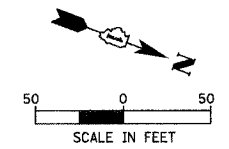

**EXISTING CONDITIONS**

POINT	STA.	OFFSET
A	161+93.61	30.0'
B	162+35.37	37.5'
C	63+23.60	35.0'
D	62+81.84	27.5'
E	62+70.21	27.5'
F	63+11.97	35.0'
G	163+52.50	49.5'
H	163+94.26	42.0'
I	163+94.66	30.0'
J	163+52.91	37.5'
K	163+46.13	35.0'
L	64+87.89	27.5'
M	64+87.52	27.5'
N	64+45.75	35.0'
O	162+35.74	37.5'
P	161+93.99	30.0'

FOR ELEVATIONS, SEE SHEET 82

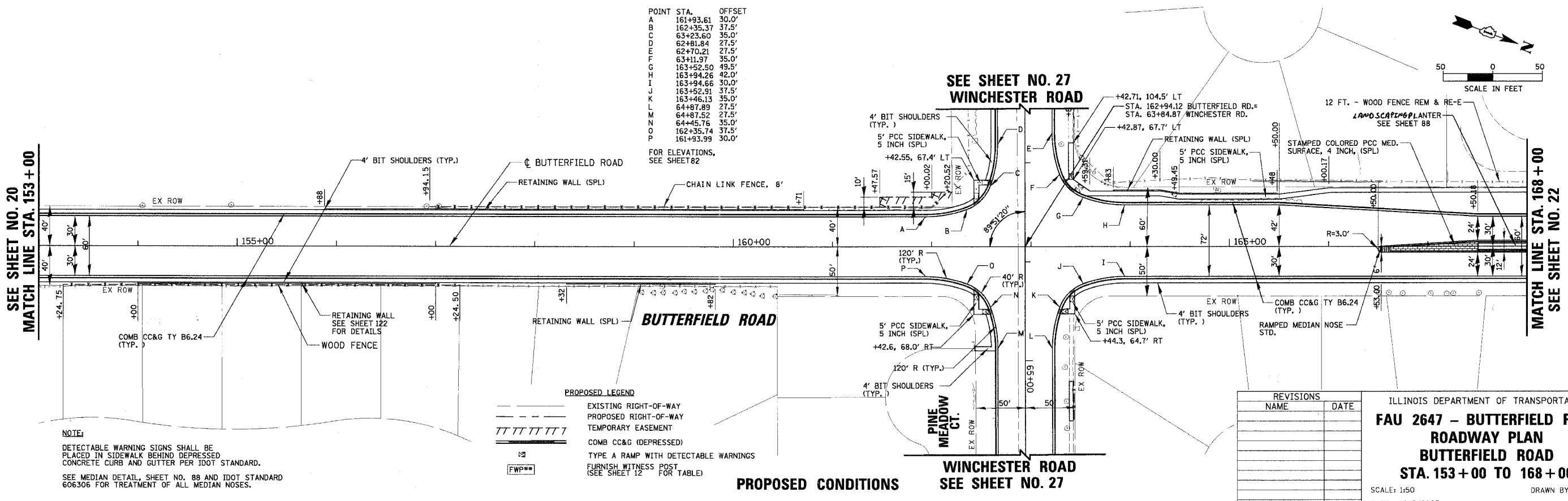

**PROPOSED CONDITIONS**

REVISIONS	
NAME	DATE

ILLINOIS DEPARTMENT OF TRANSPORTATION  
**FAU 2647 - BUTTERFIELD ROAD ROADWAY PLAN**  
**BUTTERFIELD ROAD**  
**STA. 153+00 TO 168+00**  
 SCALE: 1:50  
 DATE: 12/2/2005  
 DRAWN BY: ELA, PMM  
 CHECKED BY: BLL

N:\LIBERTYVILLE\99-389\CIVIL\99389.TBL  
 N:\LIBERTYVILLE\99-389\CIVIL\99389\_04.plt  
 1:50  
 12/2/2005