

FAU	SECTION	COUNTY	TOTAL SHEETS	SHEET NO.
2647	99-00142-07-WR	LAKE	256	45
CONTRACT NO: 83815				
FED. ROAD DIST. NO. 1 ILLINOIS FED. AID PROJECT				

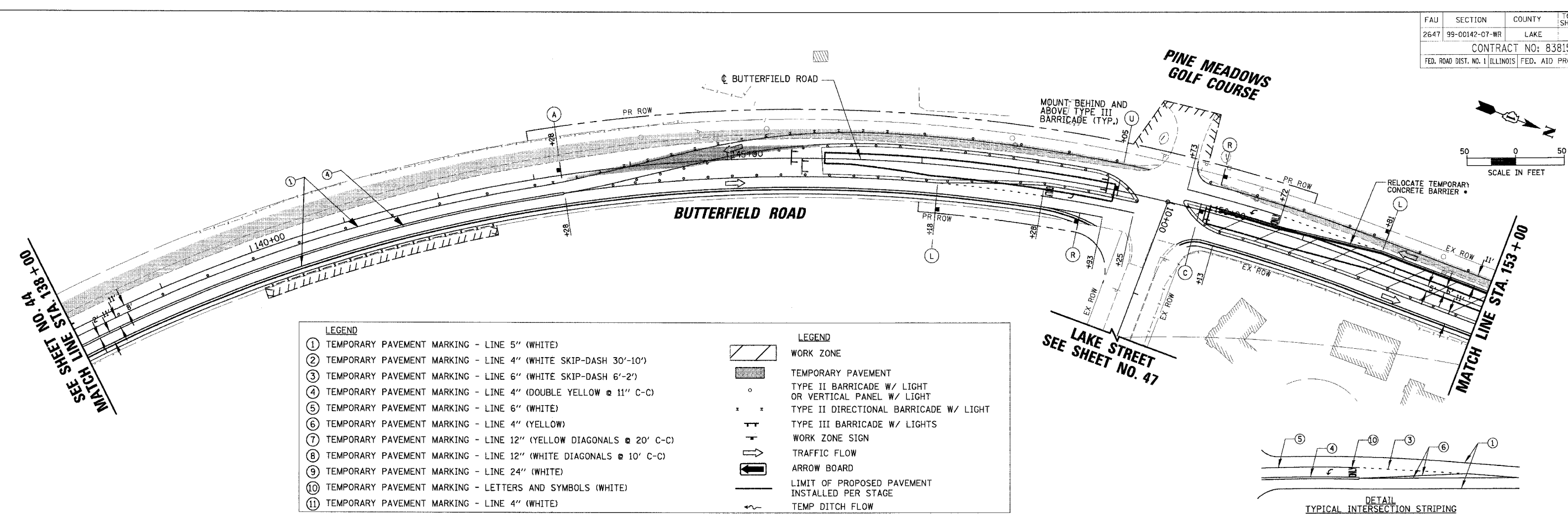

LEGEND		LEGEND	
①	TEMPORARY PAVEMENT MARKING - LINE 5" (WHITE)		WORK ZONE
②	TEMPORARY PAVEMENT MARKING - LINE 4" (WHITE SKIP-DASH 30'-10')		TEMPORARY PAVEMENT
③	TEMPORARY PAVEMENT MARKING - LINE 6" (WHITE SKIP-DASH 6'-2')		TYPE II BARRICADE W/ LIGHT OR VERTICAL PANEL W/ LIGHT
④	TEMPORARY PAVEMENT MARKING - LINE 4" (DOUBLE YELLOW @ 11" C-C)		TYPE II DIRECTIONAL BARRICADE W/ LIGHT
⑤	TEMPORARY PAVEMENT MARKING - LINE 6" (WHITE)		TYPE III BARRICADE W/ LIGHTS
⑥	TEMPORARY PAVEMENT MARKING - LINE 4" (YELLOW)		WORK ZONE SIGN
⑦	TEMPORARY PAVEMENT MARKING - LINE 12" (YELLOW DIAGONALS @ 20' C-C)		ARROW BOARD
⑧	TEMPORARY PAVEMENT MARKING - LINE 12" (WHITE DIAGONALS @ 10' C-C)		LIMIT OF PROPOSED PAVEMENT INSTALLED PER STAGE
⑨	TEMPORARY PAVEMENT MARKING - LINE 24" (WHITE)		TEMP DITCH FLOW
⑩	TEMPORARY PAVEMENT MARKING - LETTERS AND SYMBOLS (WHITE)		
⑪	TEMPORARY PAVEMENT MARKING - LINE 4" (WHITE)		

SEE SHEET NO. 44
MATCH LINE STA. 138+00

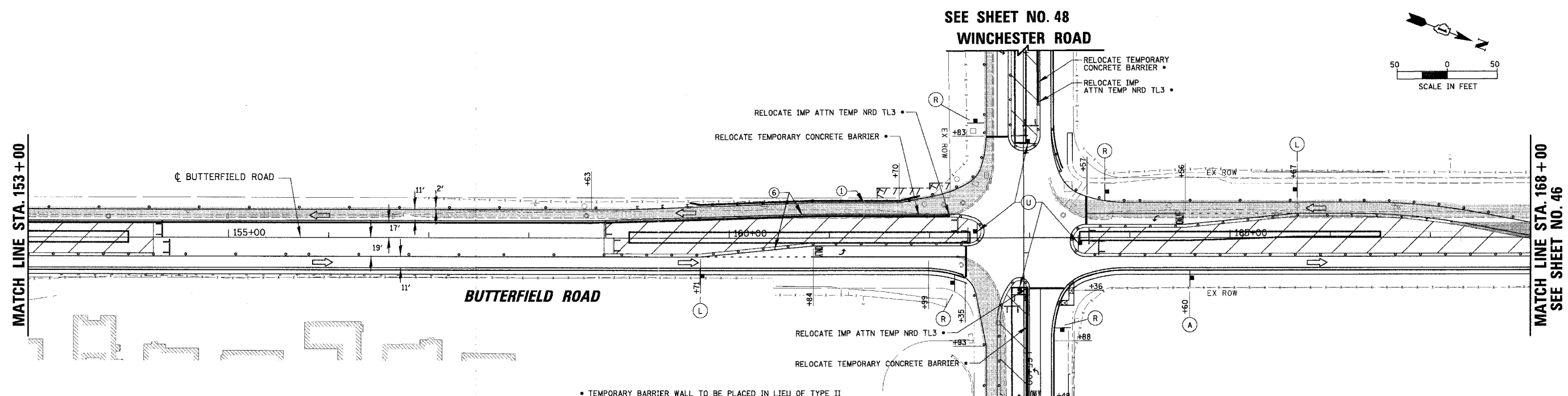
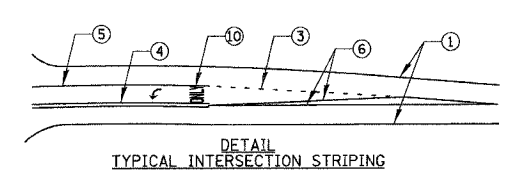
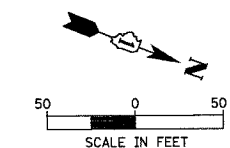

MATCH LINE STA. 153+00

MATCH LINE STA. 168+00
SEE SHEET NO. 46

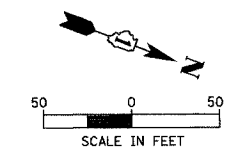

- TEMPORARY BARRIER WALL TO BE PLACED IN LIEU OF TYPE II BARRICADES WHERE ALL OF THE FOLLOWING CONDITIONS OCCUR, OR DIRECTED BY THE ENGINEER,
 - SIDESLOPE STEEPER THAN 4:1, OR DROPOFF > 2', TO PROPOSED SUBGRADE/BOTTOM OF UNDERCUT.
 - EDGE OF TRAVEL LANE CLOSER THAN 4 FEET TO TOP OF SIDESLOPE OR DROPOFF.
- ALL TEMPORARY BARRIER WALL END TREATMENTS WILL HAVE ATTENUATING DEVICES AS SHOWN OR AS DIRECTED BY THE ENGINEER.

SEE SHEET NO. 48
WINCHESTER ROAD
WINCHESTER ROAD
SEE SHEET NO. 48

REVISIONS	
NAME	DATE

ILLINOIS DEPARTMENT OF TRANSPORTATION
FAU 2647 - BUTTERFIELD ROAD
SUGGESTED STAGES OF CONSTRUCTION
AND TRAFFIC CONTROL - STAGE 1B
STA. 138+00 TO STA. 168+00
 SCALE: 1:50
 DATE: 12/2/2005
 DRAWN BY: PMM
 CHECKED BY: BLL