

| | | | | |
|---|----------------|--------|--------------|-----------|
| FAU | SECTION | COUNTY | TOTAL SHEETS | SHEET NO. |
| 2647 | 99-00142-07-WR | LAKE | 256 | 46 |
| CONTRACT NO: 83815 | | | | |
| FED. ROAD DIST. NO. 1 ILLINOIS FED. AID PROJECT | | | | |

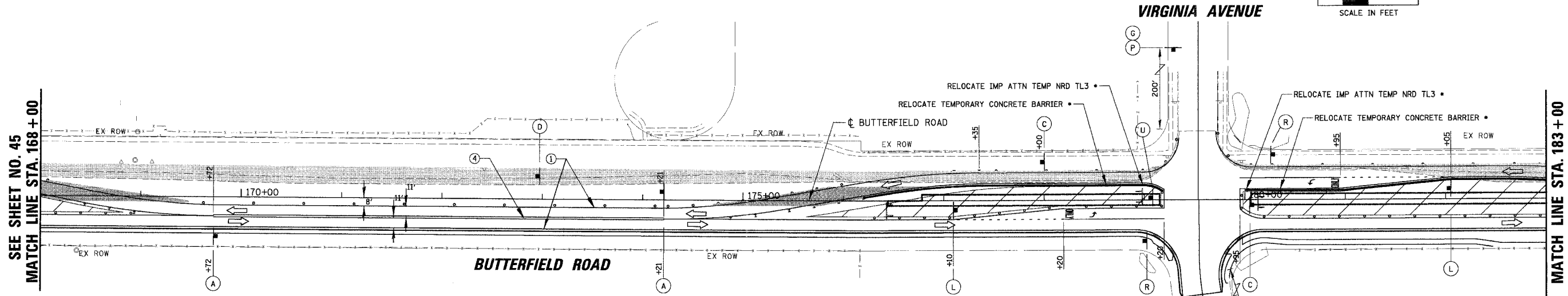
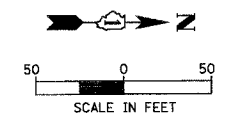

SEE SHEET NO. 45
MATCH LINE STA. 168+00

MATCH LINE STA. 183+00

| LEGEND | | LEGEND | |
|--------|--|-----------------|---|
| ① | TEMPORARY PAVEMENT MARKING - LINE 5" (WHITE) | [Hatched Box] | WORK ZONE |
| ② | TEMPORARY PAVEMENT MARKING - LINE 4" (WHITE SKIP-DASH 30'-10') | [Dotted Box] | TEMPORARY PAVEMENT |
| ③ | TEMPORARY PAVEMENT MARKING - LINE 6" (WHITE SKIP-DASH 6'-2') | [Circle] | TYPE II BARRICADE W/ LIGHT OR VERTICAL PANEL W/ LIGHT |
| ④ | TEMPORARY PAVEMENT MARKING - LINE 4" (DOUBLE YELLOW @ 11" C-C) | [Dashed Line] | TYPE II DIRECTIONAL BARRICADE W/ LIGHT |
| ⑤ | TEMPORARY PAVEMENT MARKING - LINE 6" (WHITE) | [Vertical Line] | TYPE III BARRICADE W/ LIGHTS |
| ⑥ | TEMPORARY PAVEMENT MARKING - LINE 4" (YELLOW) | [Arrow] | WORK ZONE SIGN |
| ⑦ | TEMPORARY PAVEMENT MARKING - LINE 12" (YELLOW DIAGONALS @ 20' C-C) | [Arrow] | TRAFFIC FLOW |
| ⑧ | TEMPORARY PAVEMENT MARKING - LINE 12" (WHITE DIAGONALS @ 10' C-C) | [Arrow] | ARROW BOARD |
| ⑨ | TEMPORARY PAVEMENT MARKING - LINE 24" (WHITE) | [Dashed Line] | LIMIT OF PROPOSED PAVEMENT INSTALLED PER STAGE |
| ⑩ | TEMPORARY PAVEMENT MARKING - LETTERS AND SYMBOLS (WHITE) | [Wavy Line] | TEMP DITCH FLOW |
| ⑪ | TEMPORARY PAVEMENT MARKING - LINE 4" (WHITE) | | |

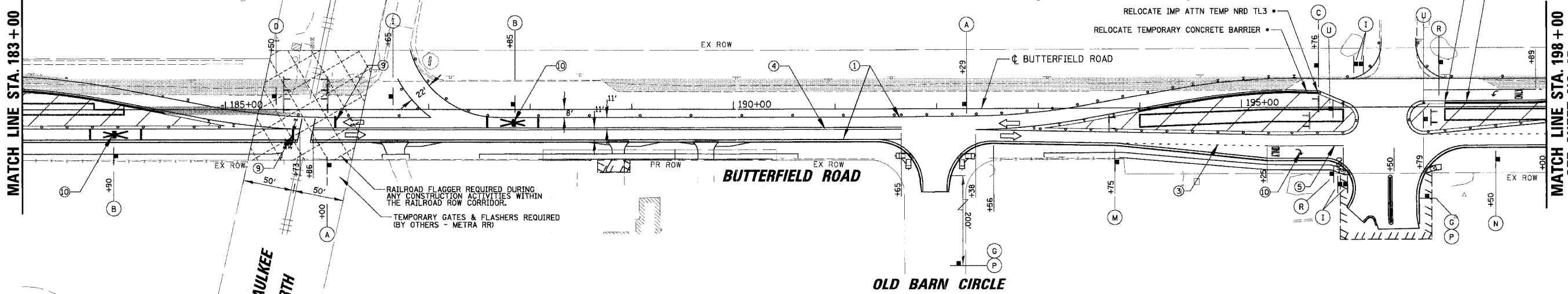
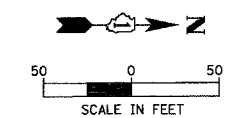
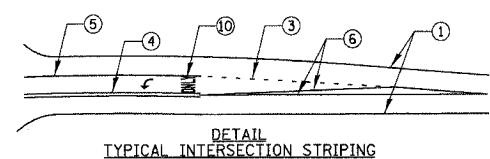

MATCH LINE STA. 183+00

MATCH LINE STA. 198+00
SEE SHEET NO. 47

- TEMPORARY BARRIER WALL TO BE PLACED IN LIEU OF TYPE II BARRICADES WHERE ALL OF THE FOLLOWING CONDITIONS OCCUR, OR DIRECTED BY THE ENGINEER,
 - SIDESLOPE STEEPER THAN 4:1, OR DROPOFF > 2', TO PROPOSED SUBGRADE/BOTTOM OF UNDERCUT.
 - EDGE OF TRAVEL LANE CLOSER THAN 4 FEET TO TOP OF SIDESLOPE OR DROPOFF.
- ALL TEMPORARY BARRIER WALL END TREATMENTS WILL HAVE ATTENUATING DEVICES AS SHOWN OR AS DIRECTED BY THE ENGINEER.

| REVISIONS | |
|-----------|------|
| NAME | DATE |
| | |
| | |
| | |
| | |
| | |

ILLINOIS DEPARTMENT OF TRANSPORTATION
FAU 2647 - BUTTERFIELD ROAD
SUGGESTED STAGES OF CONSTRUCTION
AND TRAFFIC CONTROL - STAGE IB
STA. 168+00 TO STA. 198+00
 SCALE: 1:50
 DATE: 12/2/2005
 DRAWN BY: PMM
 CHECKED BY: BLL

N:\LIBERTYVILLE\99-389\CIVIL\99389.TBL
 N:\LIBERTYVILLE\99-389\CIVIL\99389IB_03.mot
 1:50
 12/2/2005