

FAU	SECTION	COUNTY	TOTAL SHEETS	SHEET NO.
2647	99-00142-07-WR	LAKE	256	52
CONTRACT NO: 83815				
FED. ROAD DIST. NO. 1 ILLINOIS FED. AID PROJECT				

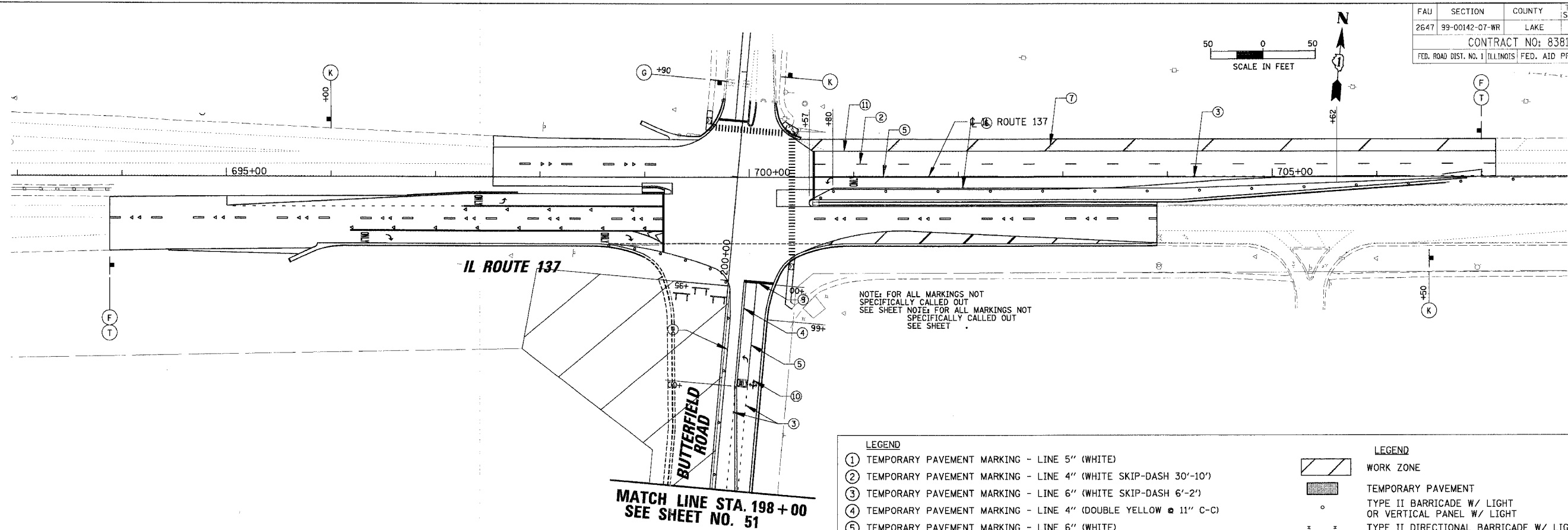

NOTE: FOR ALL MARKINGS NOT SPECIFICALLY CALLED OUT SEE SHEET NOTE: FOR ALL MARKINGS NOT SPECIFICALLY CALLED OUT SEE SHEET

MATCH LINE STA. 198 + 00
SEE SHEET NO. 51

LEGEND		LEGEND	
①	TEMPORARY PAVEMENT MARKING - LINE 5" (WHITE)		WORK ZONE
②	TEMPORARY PAVEMENT MARKING - LINE 4" (WHITE SKIP-DASH 30'-10')		TEMPORARY PAVEMENT
③	TEMPORARY PAVEMENT MARKING - LINE 6" (WHITE SKIP-DASH 6'-2')	o	TYPE II BARRICADE W/ LIGHT OR VERTICAL PANEL W/ LIGHT
④	TEMPORARY PAVEMENT MARKING - LINE 4" (DOUBLE YELLOW @ 11" C-C)	x =	TYPE II DIRECTIONAL BARRICADE W/ LIGHT
⑤	TEMPORARY PAVEMENT MARKING - LINE 6" (WHITE)	T	TYPE III BARRICADE W/ LIGHTS
⑥	TEMPORARY PAVEMENT MARKING - LINE 4" (YELLOW)	T	WORK ZONE SIGN
⑦	TEMPORARY PAVEMENT MARKING - LINE 12" (YELLOW DIAGONALS @ 20' C-C)	→	TRAFFIC FLOW
⑧	TEMPORARY PAVEMENT MARKING - LINE 12" (WHITE DIAGONALS @ 10' C-C)	→	ARROW BOARD
⑨	TEMPORARY PAVEMENT MARKING - LINE 24" (WHITE)	→	LIMIT OF PROPOSED PAVEMENT INSTALLED PER STAGE
⑩	TEMPORARY PAVEMENT MARKING - LETTERS AND SYMBOLS (WHITE)	→	TEMP DITCH FLOW
⑪	TEMPORARY PAVEMENT MARKING - LINE 4" (WHITE)		

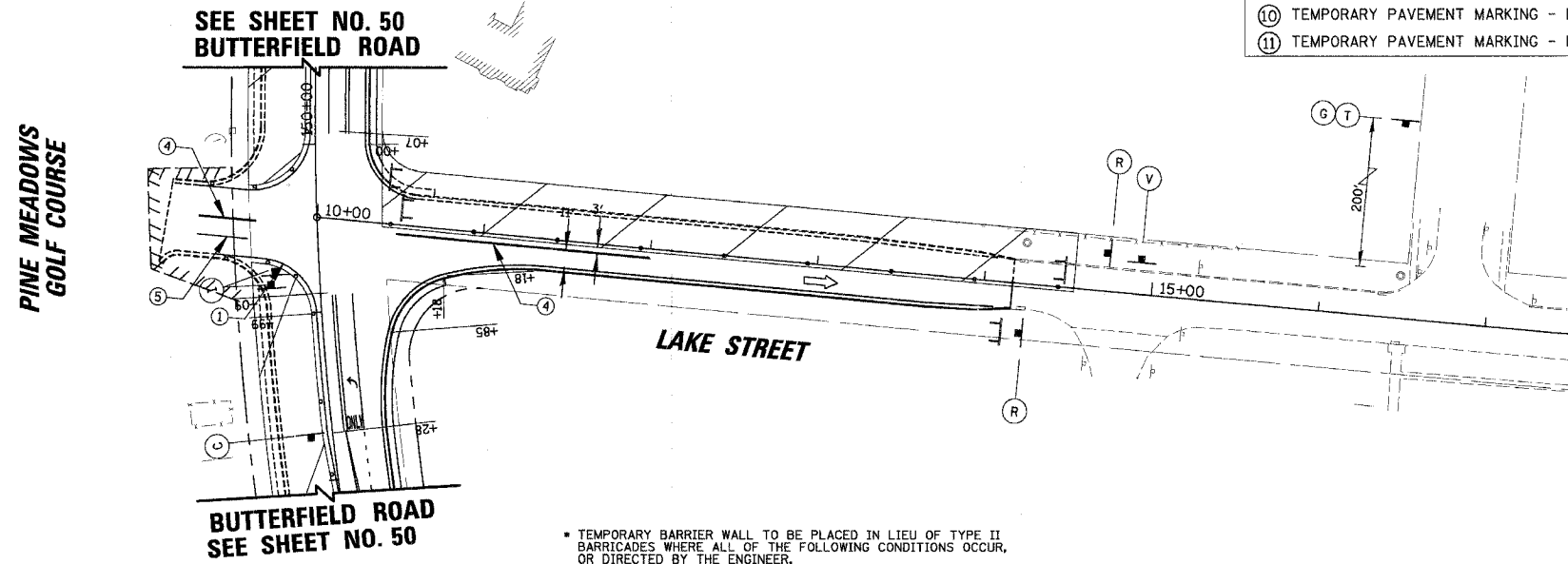

SEE SHEET NO. 50
BUTTERFIELD ROAD

BUTTERFIELD ROAD
SEE SHEET NO. 50

TEMPORARY BARRIER WALL TO BE PLACED IN LIEU OF TYPE II BARRICADES WHERE ALL OF THE FOLLOWING CONDITIONS OCCUR, OR DIRECTED BY THE ENGINEER,

1. SIDESLOPE STEEPER THAN 4:1, OR DROPOFF > 2', TO PROPOSED SUBGRADE/BOTTOM OF UNDERCUT.
2. EDGE OF TRAVEL LANE CLOSER THAN 4 FEET TO TOP OF SIDESLOPE OR DROPOFF.

ALL TEMPORARY BARRIER WALL END TREATMENTS WILL HAVE ATTENUATING DEVICES AS SHOWN OR AS DIRECTED BY THE ENGINEER.

REVISIONS	
NAME	DATE

ILLINOIS DEPARTMENT OF TRANSPORTATION
**FAU 2647 - BUTTERFIELD ROAD
SUGGESTED STAGES OF CONSTRUCTION
AND TRAFFIC CONTROL - STAGE II
IL RTE. 137 AND LAKE STREET**

SCALE: 1:50
DATE: 12/2/2005
DRAWN BY: PMM
CHECKED BY: BLL