

- TEMPORARY TRAFFIC SIGNAL LEGEND**
- ▲ TEMPORARY TRAFFIC SIGNAL HEAD SPAN WIRE MOUNTED ORIGINAL LOCATION
  - ▲ TEMPORARY TRAFFIC SIGNAL HEAD SPAN WIRE MOUNTED SECONDARY LOCATION
  - ⊙ TEMPORARY WOOD POLE (CLASS 5 OR BETTER) 45 FOOT (13.7m) MINIMUM
  - ⊠ TEMPORARY CONTROLLER CABINET
  - TEMPORARY SPAN WIRE, TETHER WIRE, AND CABLE
  - TEMPORARY SERVICE INSTALLATION
  - ⊠ TEMPORARY PEDESTRIAN SIGNAL HEAD, BRACKET MOUNTED
  - ⊙ MACHINE VISION PROCESSOR
  - ⊙ PEDESTRIAN PUSHBUTTON DETECTOR
  - ⊙ EMERGENCY VEHICLE LIGHT DETECTOR
  - ⊙ CONFIRMATION BEACON
  - ⊙ VEHICLE DETECTOR, INDUCTION LOOP
  - UD UNIT DUCT
  - CT COMMON TRENCH
  - G.S. CONDUIT IN TRENCH (T) OR PUSHED (P)
  - HANDHOLE
  - ⊠ HEAVY DUTY HANDHOLE
  - ⊠ DOME CAMERA
  - ⊠ APPROXIMATE DETECTOR ZONE

- EXISTING EQUIPMENT TO BE REMOVED LEGEND**
- "E" ▲ EXISTING SIGNAL HEAD TO BE REMOVED
  - "E" ⊠ EXISTING SERVICE INSTALLATION TO BE REMOVED
  - "E" ○ EXISTING SIGNAL POST AND FOUNDATION TO BE REMOVED
  - "E" ⊠ EXISTING ALUMINUM MAST ARM POLE AND FOUNDATION TO BE REMOVED
  - "E" ⊠ EXISTING CONTROLLER AND FOUNDATION TO BE REMOVED
  - "E" ⊠ EXISTING HANDHOLE TO BE REMOVED
  - "E" ⊠ EXISTING PEDESTRIAN SIGNAL HEAD TO BE REMOVED
  - "E" ⊙ EXISTING PEDESTRIAN PUSHBUTTON TO BE REMOVED
  - "E" ⊙ EMERGENCY VEHICLE LIGHT DETECTOR TO BE REMOVED
  - "E" ⊙ CONFIRMATION BEACON TO BE REMOVED
  - "E" ⊠ EXISTING HEAVY-DUTY HANDHOLE TO BE REMOVED
  - "E" ⊠ EXISTING STEEL MAST ARM POLE AND FOUNDATION TO BE REMOVED

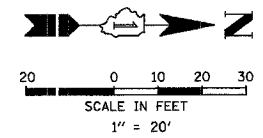

THE FOLLOWING EXISTING TRAFFIC SIGNAL EQUIPMENT SHALL BE REMOVED BY THE CONTRACTOR, SHALL REMAIN THE PROPERTY OF THE COUNTY AND SHALL BE DELIVERED BY THE CONTRACTOR TO THE COUNTY YARD AS PER TRAFFIC SIGNAL SPECIFICATIONS.

- 1 EACH CABINET
- 1 EACH CONTROLLER
- 1 EACH INTERSECTION MONITOR UNIT
- 2 EACH LIGHT DETECTOR
- 1 EACH LIGHT DETECTOR AMPLIFIER

THE FOLLOWING ITEMS SHALL BE REMOVED BY THE CONTRACTOR AND SHALL BE DISPOSED OF BY THEM OUTSIDE THE RIGHT-OF-WAY AT THEIR EXPENSE. THE SALVAGE VALUE OF THE REMOVED EQUIPMENT SHALL BE REFLECTED IN THE CONTRACT BID PRICE.

- 4 EACH SIGNAL HEAD, 1-FACE, 3-SECTION
- 8 EACH SIGNAL HEAD, 1-FACE, 5-SECTION
- 2 EACH PEDESTRIAN SIGNAL HEAD, 1-FACE
- 2 EACH PEDESTRIAN PUSHBUTTON
- 4 EACH STEEL MAST ARM
- 4 EACH SIGNAL POST

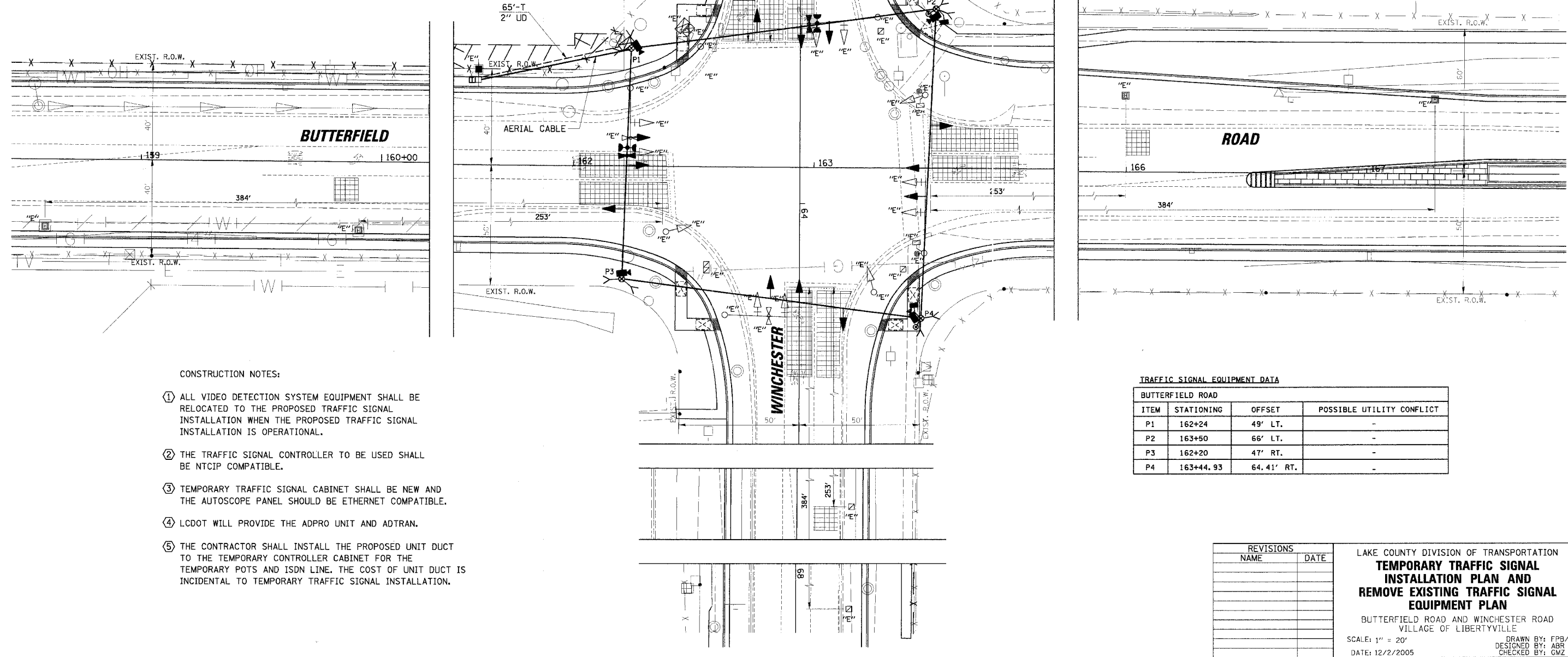

- CONSTRUCTION NOTES:**
- 1 ALL VIDEO DETECTION SYSTEM EQUIPMENT SHALL BE RELOCATED TO THE PROPOSED TRAFFIC SIGNAL INSTALLATION WHEN THE PROPOSED TRAFFIC SIGNAL INSTALLATION IS OPERATIONAL.
  - 2 THE TRAFFIC SIGNAL CONTROLLER TO BE USED SHALL BE NTCIP COMPATIBLE.
  - 3 TEMPORARY TRAFFIC SIGNAL CABINET SHALL BE NEW AND THE AUTOSCOPE PANEL SHOULD BE ETHERNET COMPATIBLE.
  - 4 LCDOT WILL PROVIDE THE ADPRO UNIT AND ADTRAN.
  - 5 THE CONTRACTOR SHALL INSTALL THE PROPOSED UNIT DUCT TO THE TEMPORARY CONTROLLER CABINET FOR THE TEMPORARY POTS AND ISDN LINE. THE COST OF UNIT DUCT IS INCIDENTAL TO TEMPORARY TRAFFIC SIGNAL INSTALLATION.

**TRAFFIC SIGNAL EQUIPMENT DATA**

BUTTERFIELD ROAD			
ITEM	STATIONING	OFFSET	POSSIBLE UTILITY CONFLICT
P1	162+24	49' LT.	-
P2	163+50	66' LT.	-
P3	162+20	47' RT.	-
P4	163+44.93	64.41' RT.	-

REVISIONS	
NAME	DATE

LAKE COUNTY DIVISION OF TRANSPORTATION  
**TEMPORARY TRAFFIC SIGNAL  
 INSTALLATION PLAN AND  
 REMOVE EXISTING TRAFFIC SIGNAL  
 EQUIPMENT PLAN**  
 BUTTERFIELD ROAD AND WINCHESTER ROAD  
 VILLAGE OF LIBERTYVILLE  
 SCALE: 1" = 20'  
 DATE: 12/2/2005  
 DRAWN BY: FPB/FCP  
 DESIGNED BY: ABR  
 CHECKED BY: GWZ

12/2/2005 N:\LIBERTYVILLE\99-389\T-traffic\TMP\_winchester.dgn