

ORIGINAL SURVEY	DATE	BY
STAMPED SURVEY		
NOTE BOOK		
AREAS CHECKED		
NO.		

**CHRISTOPHER B. BURKE ENGINEERING LTD.**  
 9575 West Higgins Road, Suite 600  
 Rosemont, Illinois 60018  
 (847) 823-0500

FINAL SURVEY	DATE	BY
STAMPED SURVEY		
NOTE BOOK		
AREAS CHECKED		
NO.		

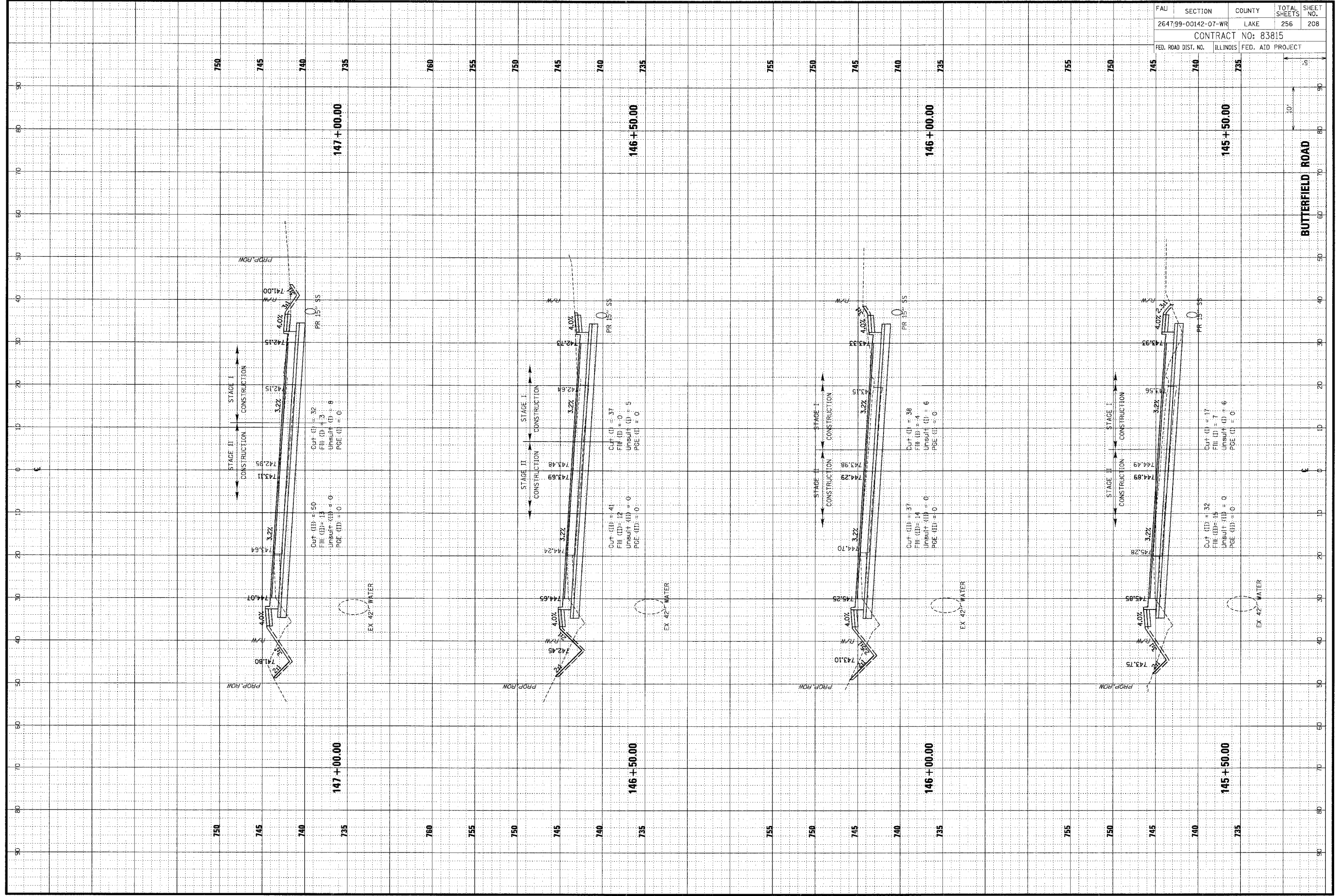

FAL	SECTION	COUNTY	TOTAL SHEETS	SHEET NO.
264799-00142-07-WR	LAKE	ILLINOIS	256	208
CONTRACT NO: 83815				
FED. ROAD DIST. NO.	ILLINOIS	FED. AID PROJECT		