

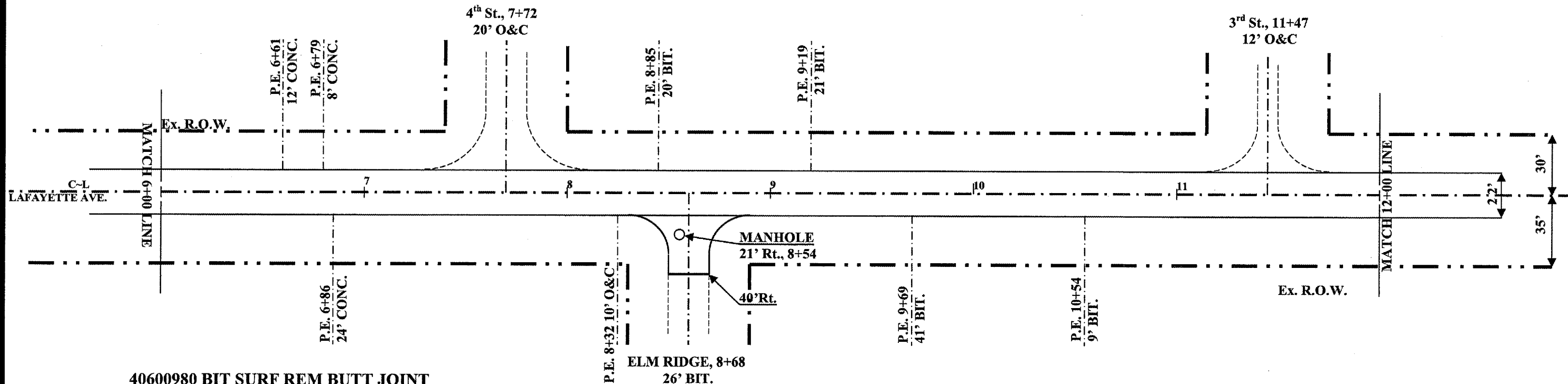

PLAN VIEW

CITY OF MATTOON
SECTION 05-00143-00-RS
CONTRACT 95479
ROUTE: F.A.U.7675
LAFAYETTE AVENUE
COLES COUNTY
SHEET 28 OF 43



40600980 BIT SURF REM BUTT JOINT

30'~40' Rt., C~L E. RIDGE 8+68 = 34.0 SQ.YDs.
TOTAL = 34.0 SQ.YDs.

44000001 BIT SURFACE REMOVAL 1/4"

11' Lt. ~ Rt., 6+00 ~ 12+00 = 1466.7 SQ.YDs.
TOTAL = 1466.7 SQ.YDs.

60300350 MANHOLE FRAMES ADJUST

21' Rt., 8+54 = 1.0 EACH
TOTAL = 1.0 EACH

40800040 INCIDENTAL BITUMINOUS SURFACING

P.E. 6+61 Lt., 11' ~ 23' Lt.	= 0.8 TON
P.E. 6+79 Lt., 11' ~ 17' Lt.	= 0.4 TON
P.E. 8+32 Rt., 11' ~ 17' Rt.	= 0.5 TON
ELM RIDGE St. 8+68 Rt., 11' ~ 35' Rt.	= 10.0 TON
P.E. 9+19 Lt., 11' ~ 15' Lt.	= 0.6 TON
P.E. 9+69 Rt., 11' ~ 17' Rt.	= 1.2 TON
P.E. 10+54 Rt., 11' ~ 15' Rt.	= 0.4 TON
TOTAL	= 13.9 TON

NOTE: SEE P.E. & C.E. DETAIL SHEET FOR
 DETAILS OF ENTRANCES

JOB: C-97-060-06
 PROJECT: M-5042(14)
 SCALE: 1" = 50'