

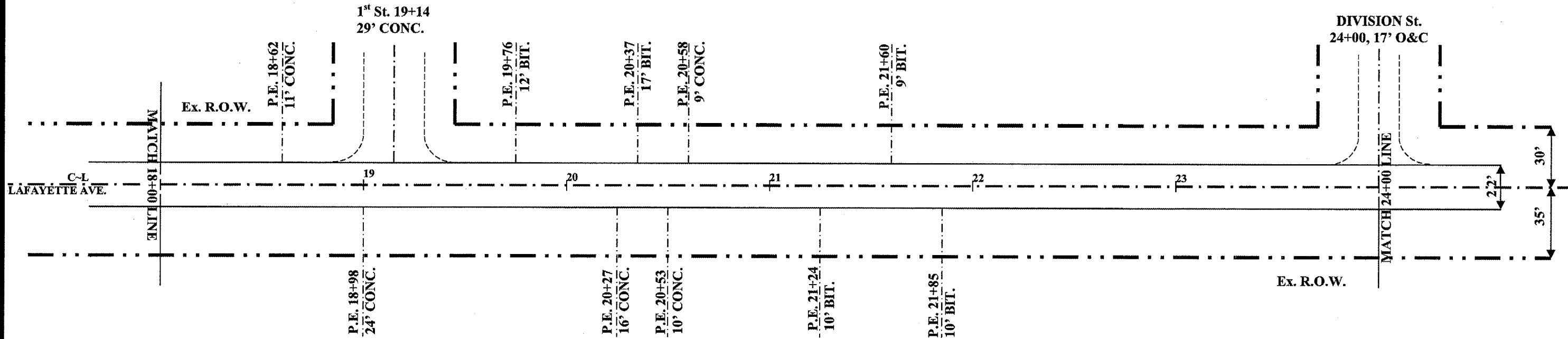

# PLAN VIEW

**CITY OF MATTOON**  
**SECTION 05-00143-00-RS**  
**CONTRACT 95479**  
**ROUTE: F.A.U.7675**  
**LAFAYETTE AVENUE**  
**COLES COUNTY**  
**SHEET 30 OF 43**



**44000001 BIT SURFACE REMOVAL 1/4"**  
 11' Lt. ~ Rt., 18+00 ~ 24+00 = 1466.7 SQ.YDs.  
**TOTAL = 1466.7 SQ.YDs.**

**44201761 CLASS D PATCHES TYPE 1 10"**  
 C~L ~ 11' Rt., 20+35 ~ 20+39 = 4.9 SQ.YDs.  
 C~L ~ 11' Rt., 21+36 ~ 21+40 = 4.9 SQ.YDs.  
 C~L ~ 11' Lt., 22+37 ~ 22+41 = 4.9 SQ.YDs.  
**TOTAL = 14.7 SQ.YDs.**

**44201765 CLASS D PATCHES TYPE 2 10"**  
 C~L ~ 11' Lt., 20+31 ~ 20+38 = 9.0 SQ.YDs.  
 C~L ~ 11' Rt., 22+37 ~ 22+42 = 6.5 SQ.YDs.  
**TOTAL = 15.5 SQ.YDs.**

**40800040 INCIDENTAL BITUMINOUS SURFACING**  
 P.E. 18+62 Lt., 11' ~ 23' Lt. = 0.9 TON  
 P.E. 20+27 Rt., 11' ~ 19' Rt. = 0.6 TON  
 P.E. 20+53 Rt., 11' ~ 19' Rt. = 0.4 TON  
 P.E. 20+58 Lt., 11' ~ 19' Lt. = 0.5 TON  
 P.E. 21+85 Rt., 11' ~ 14' Rt. = 0.3 TON  
**TOTAL = 2.7 TON**

NOTE: SEE P.E. & C.E. DETAIL SHEET  
 FOR DETAILS OF ENTRANCES

JOB: C-97-060-06  
 PROJECT: M-5042(14)  
 SCALE: 1" = 50'