

F.A.I. RTE.	SECTION	COUNTY	TOTAL SHEETS	SHEET NO.
57	*	WILLIAMSON	55	39
STA.	TO STA.			
FED. ROAD DIST. NO. ILLINOIS FED. AID PROJECT				

* [X1-(4,4-1,5,6,6-2)] R-1

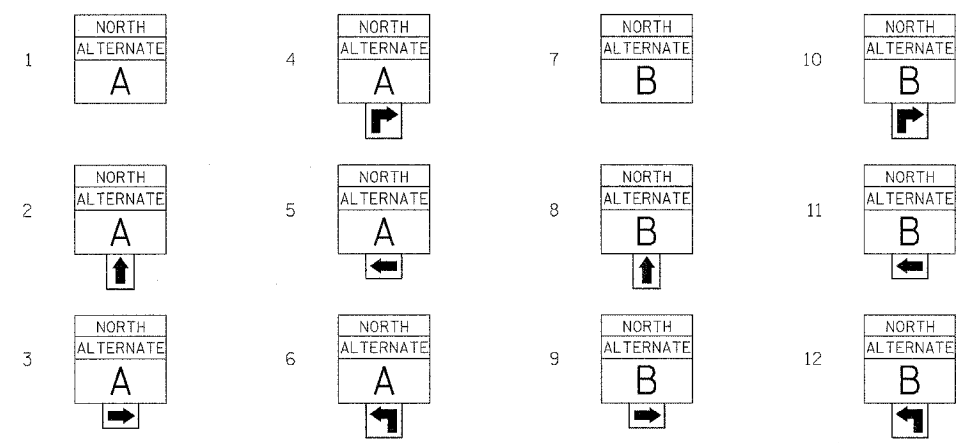

PROPOSED SIGN KEY



- 3 — PROPOSED SIGN
- A — EXISTING SIGN

PLACE PROPOSED SIGN WITHIN 200' OF THE EXISTING SIGN IN RURAL AREAS. FOR PROPOSED SIGNS IN CITY LIMITS, THE SIGNS SHALL BE PLACED SO THEY DO NOT INTERFERE WITH EXISTING SIGNS AND AS DIRECTED BY THE ENGINEER.

EXISTING SIGN KEY

- A STATE ROUTE SIGN
- B MILEAGE SIGN
- C SPEED LIMIT SIGN
- D DIRECTIONAL STATE ROUTE SIGN
- E COUNTY LINE SIGN
- F CITY/VILLAGE POPULATION SIGN
- G I-57 DIRECTIONAL SIGN

SIGN PANEL, TYPE 1	SIGN POST
50 FT	EACH
885	80

SIGN DETAIL

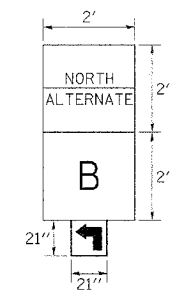

NOTES:

1. THE CONTRACTOR HAS THE OPTION OF USING METAL POSTS INSTEAD OF WOOD.
2. ALL SIGNS SHALL BE BLACK ON ORANGE. THE POSTS SHALL BE PLACED 12 FEET FROM THE EDGE OF PAVEMENT AS DIRECTED BY THE ENGINEER.
3. ALL SIGN HARDWARE REQUIRED TO INSTALL THE ALTERNATE ROUTE SIGNING SHALL BE INCLUDED IN COST OF SIGN PANEL TYPE 1.
4. SIGNS SHALL BE REMOVED ON COMPLETION OF THE CONTRACT AT THE DIRECTION OF THE ENGINEER. THIS WORK SHALL BE COMPLETED ACCORDING TO SECTION 724 OF THE STANDARD SPECIFICATIONS. THIS WORK WILL NOT BE PAID FOR. THE SIGNS AND POSTS SHALL BECOME THE PROPERTY OF IDOT.
5. ALTERNATE A = ILL. RTE. 37.
ALTERNATE B = ILL. RTE. 148.
6. THE RELOCATING, MAINTENANCE OR REPLACEMENT OF SIGNS SHALL BE PAID FOR IN ACCORDANCE WITH ARTICLE 109.04.
7. EXACT SIGN PLACEMENT WILL BE DETERMINED BY THE ENGINEER.
8. THE DISTRICT 9 OPERATIONS ENGINEER SHALL BE CONTACTED 10 DAYS PRIOR TO THE ERECTION OF SIGNS.

FOR DETAIL OF SIGNING IN WEST FRANKFORT SEE SHEET 43

FOR DETAIL OF SIGNING IN JOHNSTON CITY SEE SHEET 42

FOR DETAIL OF SIGNING IN MARION SEE SHEETS 41 & 45

FOR DETAIL OF SIGNING IN HERRIN SEE SHEET 46

FOR DETAIL OF SIGNING IN ZEIGLER SEE SHEET 47

FOR DETAIL OF SIGNING IN INTERCHANGE AREA SEE SHEET 40 & 44

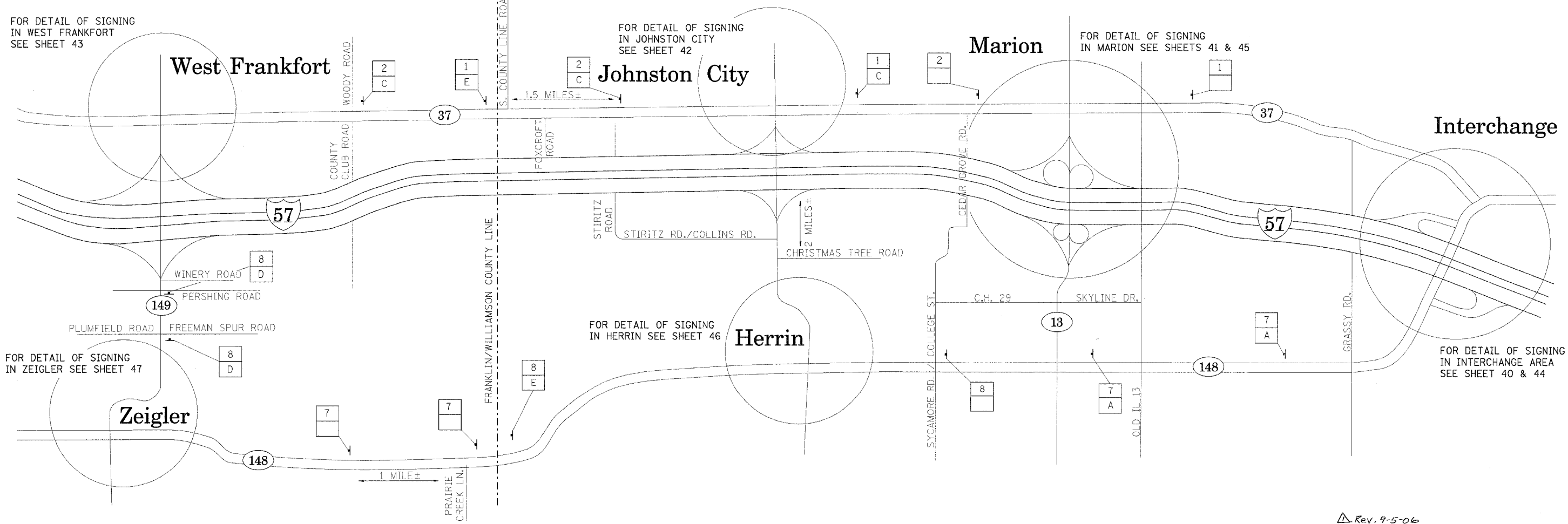

PLOT DATE = 8/22/2005
 FILE NAME = c:\p\proj\msta\39181805\alt\signm32
 USER NAME = j...
 USER HOME = ...

Rev. 9-5-06

ALTERNATE ROUTE SIGNING - ALTERNATES A & B

F.A.I. RTE.	SECTION	COUNTY	TOTAL SHEETS	SHEET NO.
57	*	WILLIAMSON	55	40
STA. _____ TO STA. _____		FED. ROAD DIST. NO. ILLINOIS FED. AID PROJECT		

* [X1-(4,4-1,5,6,6-2)] R-1

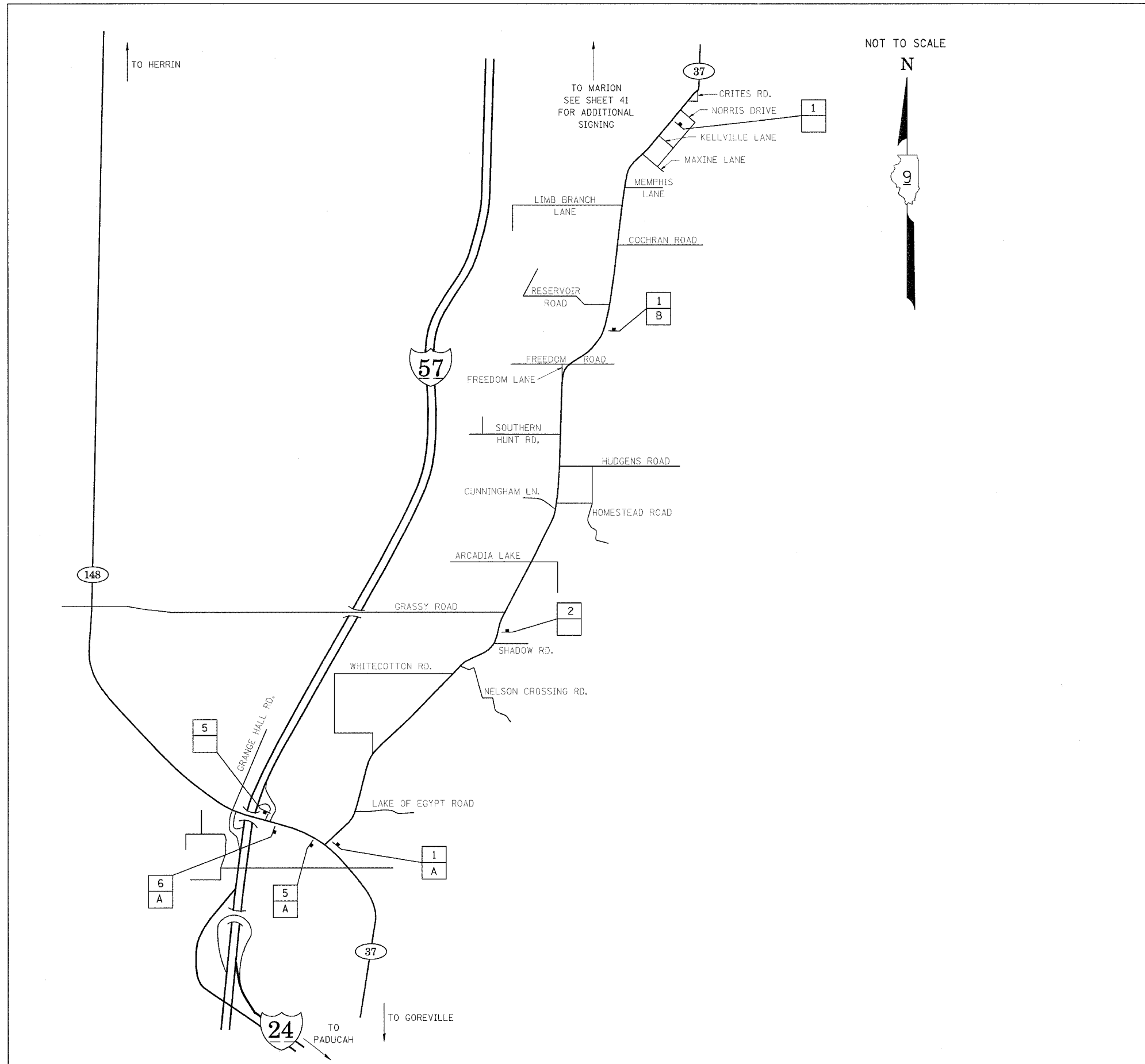

PROPOSED SIGN KEY

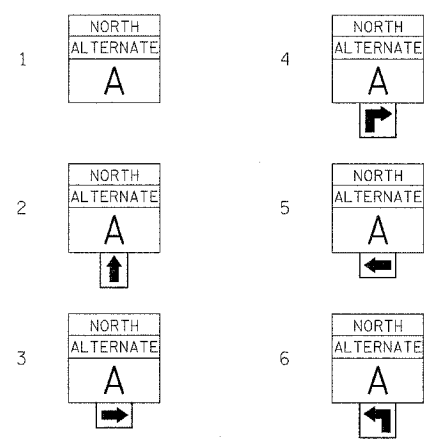

3 — PROPOSED SIGN
A — EXISTING SIGN

PLACE PROPOSED SIGN WITHIN 200' OF THE EXISTING SIGN IN RURAL AREAS. FOR PROPOSED SIGNS IN CITY LIMITS, THE SIGNS SHALL BE PLACED SO THEY DO NOT INTERFERE WITH EXISTING SIGNS AND AS DIRECTED BY THE ENGINEER. SIGNS SHALL NOT BE PLACED ON EXISTING POSTS WITH EXISTING SIGNS.

EXISTING SIGN KEY

- A STATE ROUTE SIGN
- B MILEAGE SIGN
- C SPEED LIMIT SIGN
- D DIRECTIONAL STATE ROUTE SIGN
- E CROSS ROAD SIGN
- F I-57 DIRECTIONAL SIGN
- G NO PARKING SIGN
- H SOUTHERN BRANCH - LINCOLN HERITAGE TRAIL SIGN

NOTES:

1. THE CONTRACTOR HAS THE OPTION OF USING METAL POSTS INSTEAD OF WOOD.
2. ALL SIGNS SHALL BE BLACK ON ORANGE. THE POSTS SHALL BE PLACED 12 FEET FROM THE EDGE OF PAVEMENT AS DIRECTED BY THE ENGINEER.
3. ALL SIGN HARDWARE REQUIRED TO INSTALL THE ALTERNATE ROUTE SIGNING SHALL BE INCLUDED IN COST OF SIGN PANEL TYPE 1.
4. SIGNS SHALL BE REMOVED ON COMPLETION OF THE CONTRACT AT THE DIRECTION OF THE ENGINEER. THIS WORK SHALL BE COMPLETED ACCORDING TO SECTION 724 OF THE STANDARD SPECIFICATIONS. THIS WORK WILL NOT BE PAID FOR. THE SIGNS AND POSTS SHALL BECOME THE PROPERTY OF **IDOT**.
5. ALTERNATE A = ILL. RTE. 37
6. THE RELOCATING, MAINTENANCE OR REPLACEMENT OF SIGNS SHALL BE PAID FOR IN ACCORDANCE WITH ARTICLE 109.04.
7. EXACT SIGN PLACEMENT WILL BE DETERMINED BY THE ENGINEER.
8. THE DISTRICT 9 OPERATIONS ENGINEER SHALL BE CONTACTED 10 DAYS PRIOR TO THE ERECTION OF SIGNS.

Rev. 9-5-06

**ALTERNATE ROUTE SIGNING - ALTERNATE A
IL 37 - INTERCHANGE AREA**

PLOT DATE = 8/22/2006
 FILE NAME = c:\projects\98948\98948.dwg
 PLOT SCALE = 1/16" = 1' / IN.
 USER NAME = bmoore

F.A.I. RTE.	SECTION	COUNTY	TOTAL SHEETS	SHEET NO.
57	*	WILLIAMSON	55	44
STA.	TO STA.			
FED. ROAD DIST. NO.	ILLINOIS		FED. AID PROJECT	

* EX1-(4,4-1,5,6,6-2) R-1

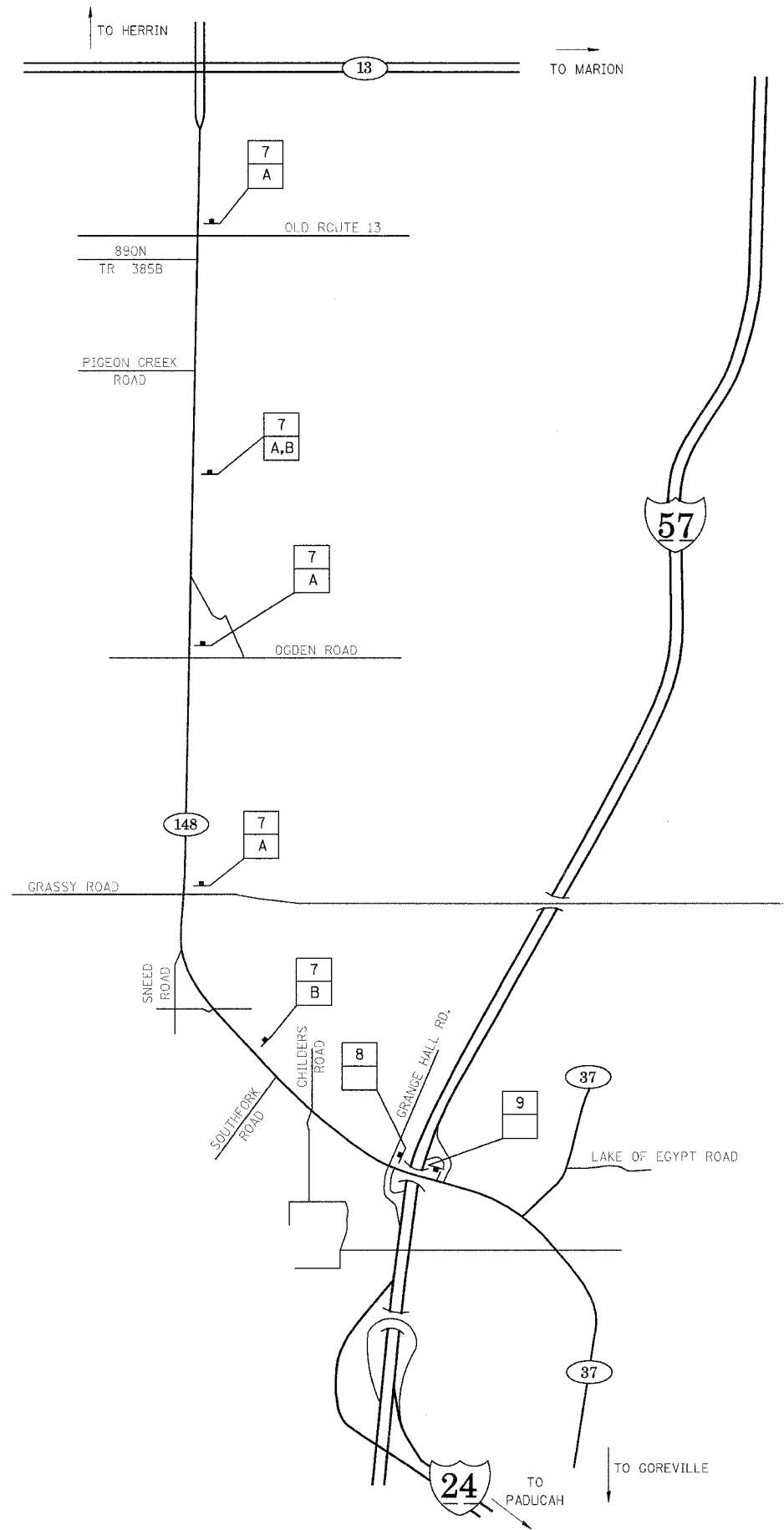

NOT TO SCALE



PROPOSED SIGN KEY

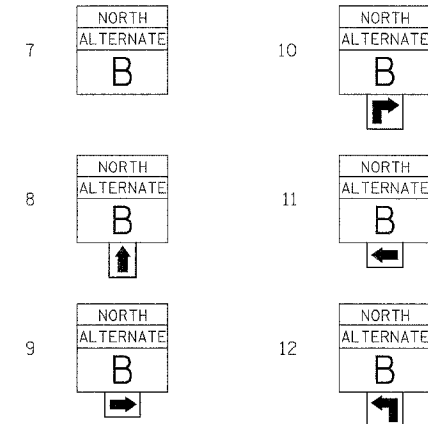

- 3 — PROPOSED SIGN
- A — EXISTING SIGN

PLACE PROPOSED SIGN 200' OF THE EXISTING SIGN IN RURAL AREAS. FOR PROPOSED SIGNS IN CITY LIMITS, THE SIGNS SHALL BE PLACED SO THEY DO NOT INTERFERE WITH EXISTING SIGNS AND AS DIRECTED BY THE ENGINEER. SIGNS SHALL NOT BE PLACED ON EXISTING POSTS WITH EXISTING SIGNS.

EXISTING SIGN KEY

- A STATE ROUTE SIGN
- B MILEAGE SIGN
- C SPEED LIMIT SIGN
- D DIRECTIONAL STATE ROUTE SIGN
- E CROSS ROAD SIGN
- F I-57 DIRECTIONAL SIGN
- G NO PARKING SIGN
- H SOUTHERN BRANCH - LINCOLN HERITAGE TRAIL SIGN

NOTES:

1. THE CONTRACTOR HAS THE OPTION OF USING METAL POSTS INSTEAD OF WOOD.
2. ALL SIGNS SHALL BE BLACK ON ORANGE. THE POSTS SHALL BE PLACED 12 FEET FROM THE EDGE OF PAVEMENT AS DIRECTED BY THE ENGINEER.
3. ALL SIGN HARDWARE REQUIRED TO INSTALL THE ALTERNATE ROUTE SIGNING SHALL BE INCLUDED IN COST OF SIGN PANEL TYPE 1.
4. SIGNS SHALL BE REMOVED ON COMPLETION OF THE CONTRACT AT THE DIRECTION OF THE ENGINEER. THIS WORK SHALL BE COMPLETED ACCORDING TO SECTION 724 OF THE STANDARD SPECIFICATIONS. THIS WORK WILL NOT BE PAID FOR. THE SIGNS AND POSTS SHALL BECOME THE PROPERTY OF IDOT.
5. ALTERNATE A = ILL. RTE. 13 AND ILL. RTE. 148.
6. THE RELOCATING, MAINTENANCE OR REPLACEMENT OF SIGNS SHALL BE PAID FOR IN ACCORDANCE WITH ARTICLE 109.04.
7. EXACT SIGN PLACEMENT WILL BE DETERMINED BY THE ENGINEER.
8. THE DISTRICT 9 OPERATIONS ENGINEER SHALL BE CONTACTED 10 DAYS PRIOR TO THE ERECTION OF SIGNS.

PLOT DATE = 8/22/2006
 FILE NAME = c:\projects\98948\98948.dwg
 PLOT SCALE = 1/8" = 1' / IN.
 USER NAME = thomasr

Rev. 9-5-06

**ALTERNATE ROUTE SIGNING - ALTERNATE B
IL 148 - INTERCHANGE AREA**

F.A.I. RTE.	SECTION	COUNTY	TOTAL SHEETS	SHEET NO.
57	*	WILLIAMSON	55	45
STA. _____ TO STA. _____				
FED. ROAD DIST. NO. _____ ILLINOIS FED. AID PROJECT				

* EX1-(4,4-1,5,6,6-2)J R-1

PROPOSED SIGN KEY

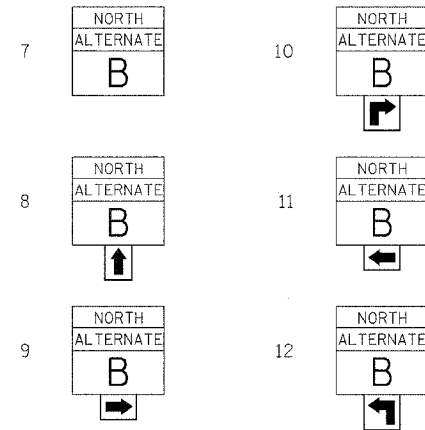

3 — PROPOSED SIGN
A — EXISTING SIGN

PLACE PROPOSED SIGN 200' OF THE EXISTING SIGN IN RURAL AREAS. FOR PROPOSED SIGNS IN CITY LIMITS, THE SIGNS SHALL BE PLACED SO THEY DO NOT INTERFERE WITH EXISTING SIGNS AND AS DIRECTED BY THE ENGINEER. SIGNS SHALL NOT BE PLACED ON EXISTING POSTS WITH EXISTING SIGNS.

EXISTING SIGN KEY

- A STATE ROUTE SIGN
- B MILEAGE SIGN
- C SPEED LIMIT SIGN
- D DIRECTIONAL STATE ROUTE SIGN
- E CROSS ROAD SIGN
- F I-57 DIRECTIONAL SIGN
- G NO PARKING SIGN
- H SOUTHERN BRANCH - LINCOLN HERITAGE TRAIL SIGN

NOTES:

1. THE CONTRACTOR HAS THE OPTION OF USING METAL POSTS INSTEAD OF WOOD.
2. ALL SIGNS SHALL BE BLACK ON ORANGE. THE POSTS SHALL BE PLACED 12 FEET FROM THE EDGE OF PAVEMENT AS DIRECTED BY THE ENGINEER.
3. ALL SIGN HARDWARE REQUIRED TO INSTALL THE ALTERNATE ROUTE SIGNING SHALL BE INCLUDED IN COST OF SIGN PANEL TYPE 1.
4. SIGNS SHALL BE REMOVED ON COMPLETION OF THE CONTRACT AT THE DIRECTION OF THE ENGINEER. THIS WORK SHALL BE COMPLETED ACCORDING TO SECTION 724 OF THE STANDARD SPECIFICATIONS. THIS WORK WILL NOT BE PAID FOR. THE SIGNS AND POSTS SHALL BECOME THE PROPERTY OF IDOT.
5. ALTERNATE B = ILL. RTE. 148 AND ILL. RTE. 13
6. THE RELOCATING, MAINTENANCE OR REPLACEMENT OF SIGNS SHALL BE PAID FOR IN ACCORDANCE WITH ARTICLE 109.04.
7. EXACT SIGN PLACEMENT WILL BE DETERMINED BY THE ENGINEER.
8. THE DISTRICT 9 OPERATIONS ENGINEER SHALL BE CONTACTED 10 DAYS PRIOR TO THE ERECTION OF SIGNS.

Rev. 9-5-06

**ALTERNATE ROUTE SIGNING - ALTERNATE B
IL 148 - IL 13 - MARION / SOUTH HERRIN**

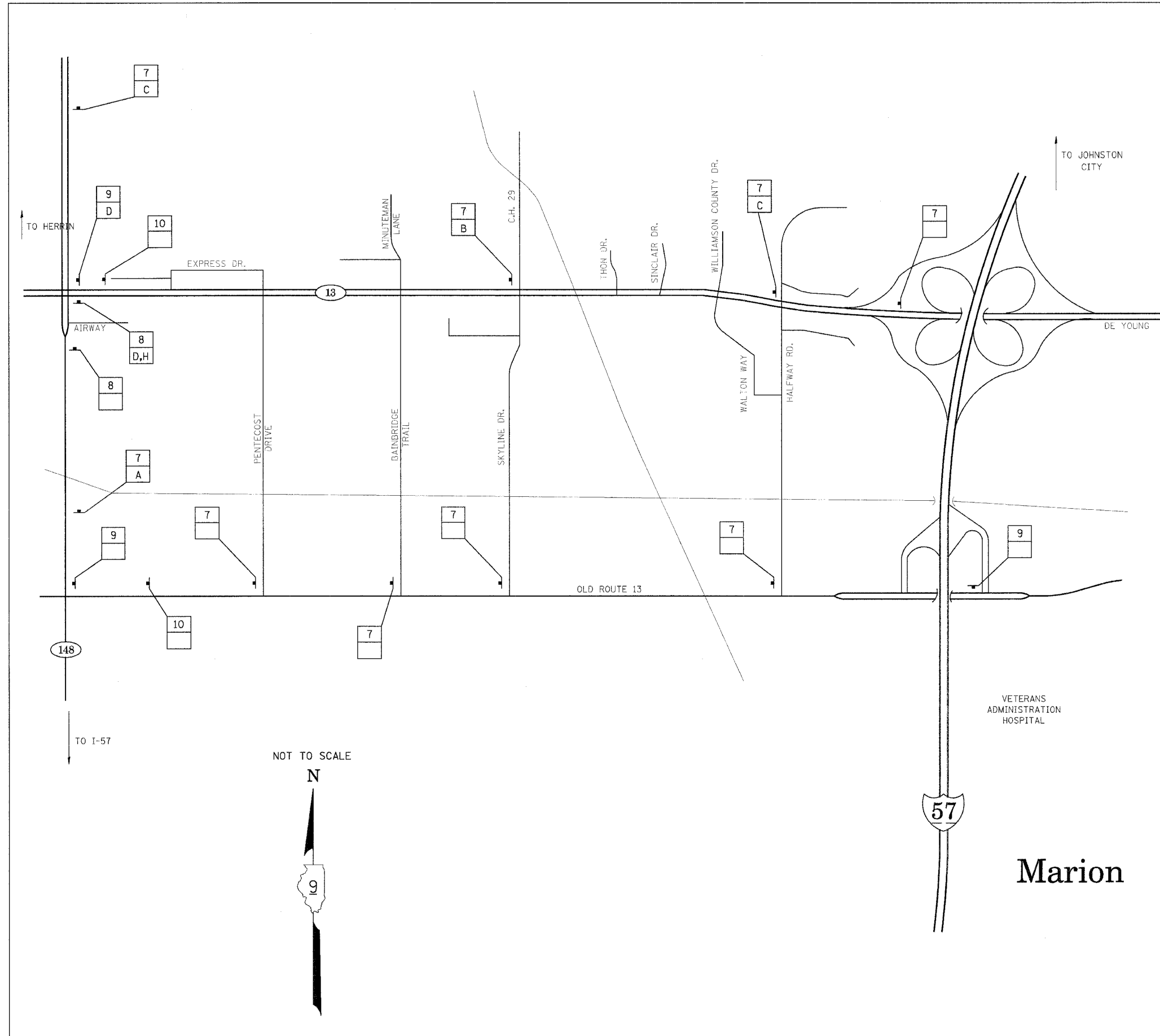

PLOT DATE = 8/22/2006
FILE NAME = c:\pco\jms\cd\181828\alt\sign\32
PLOT SCALE = 50.0000 / IN.
USER NAME = kromasht