

F.A.I. RTE.	SECTION	COUNTY	TOTAL SHEETS	SHEET NO.
55	2005-040 GRR	WILL	14	9
STA. 143+00		TO STA. 158+00		
FED. ROAD DIST. NO.	ILLINOIS	FED. AID PROJECT		

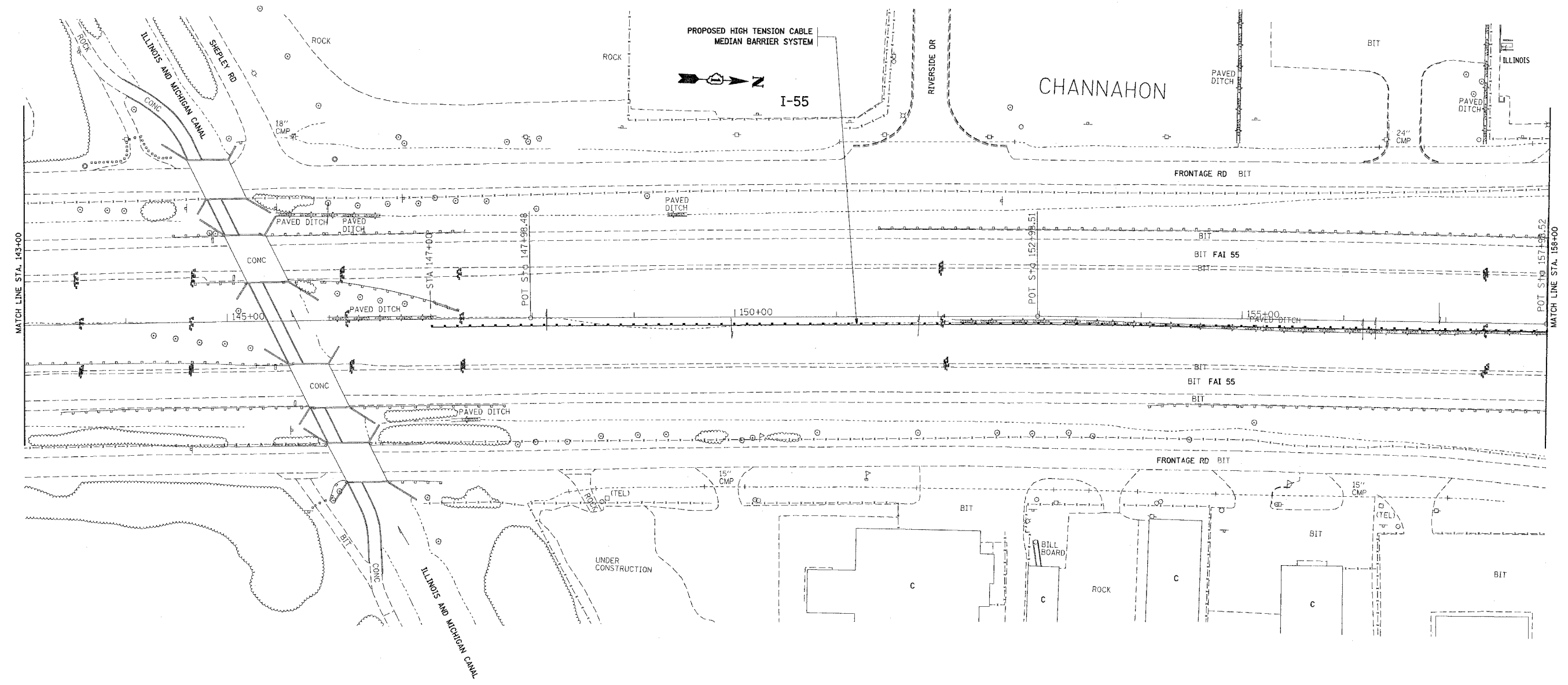

REVISIONS	
NAME	DATE

ILLINOIS DEPARTMENT OF TRANSPORTATION
FAI 55/ I-55
US 6 TO SOUTH OF I-80
EXISTING / PROPOSED ROADWAY PLAN

SCALE: VERT. _____
 HORIZ. _____
 DATE _____
 DRAWN BY: HMO
 CHECKED BY _____

PLOT DATE = 7/18/2005
 FILE NAME = c:\p\proj\2005\127205\wh\1-55sec-2.mxd
 PLOT SCALE = 56.8680 / IN.
 USER NAME = csmahon