

F.A.I. RTE.	SECTION	COUNTY	TOTAL SHEETS	SHEET NO.
55	2005-040 GRR	WILL	14	12
STA. 188+00		TO STA. 196+00		
FED. ROAD DIST. NO.	ILLINOIS FED. AID PROJECT			

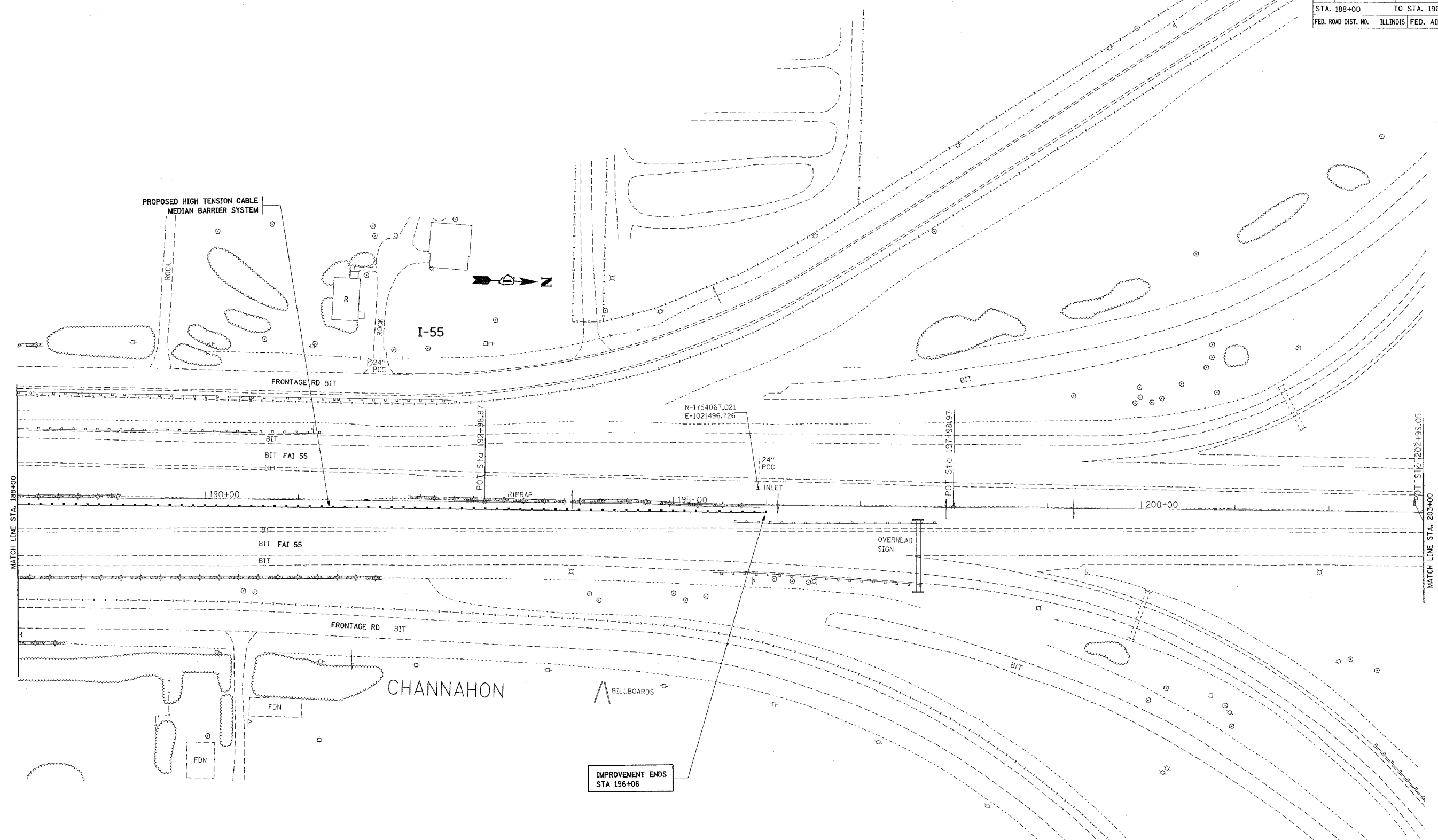

REVISIONS	
NAME	DATE

ILLINOIS DEPARTMENT OF TRANSPORTATION
FAI 55/ I-55
US 6 TO SOUTH OF I-80
EXISTING / PROPOSED ROADWAY PLAN

SCALE: VERT. _____
 HORIZ. _____
 DATE _____
 DRAWN BY: HMO
 CHECKED BY: _____

PLOT DATE = 7/10/2005
 FILE NAME = c:\pcc\mca\11272885\ah\1-9550-2.dwg
 PLOT SCALE = 56.833 / IN.
 USER NAME = emmanhan