

F.A.I. RTE.	SECTION	COUNTY	TOTAL SHEETS	SHEET NO.
94/90		COOK	556	52
STA.	TO STA.			
62300	ILLINOIS		FED. AID PROJECT	
62300 • 0818, ETC, 2324.6-1PR-8				

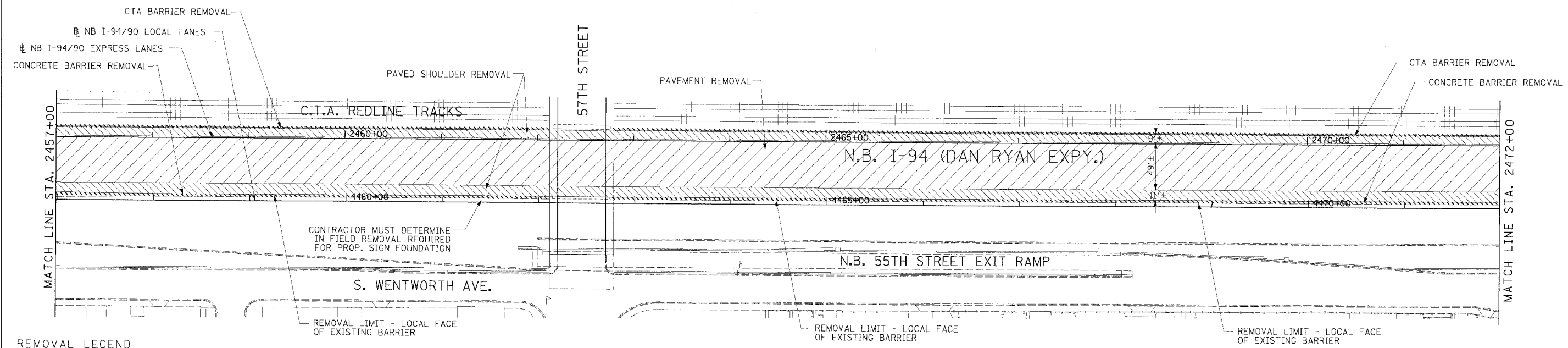
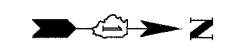

- REMOVAL LEGEND**
- PAVEMENT REMOVAL
 - PAVED SHOULDER REMOVAL
 - COMBINATION CURB AND GUTTER REMOVAL
 - CONCRETE BARRIER OR GUARD RAIL REMOVAL

NOTE:
1. THE LOCATION OF PAVEMENT CONSTRUCTED IN PREVIOUS CONTRACTS IS BASED OFF OF CONTRACT PLAN DRAWINGS. THE CONTRACTOR MUST VERIFY LIMITS OF PREVIOUS CONSTRUCTION IN THE FIELD.

EXISTING CONDITIONS & REMOVALS

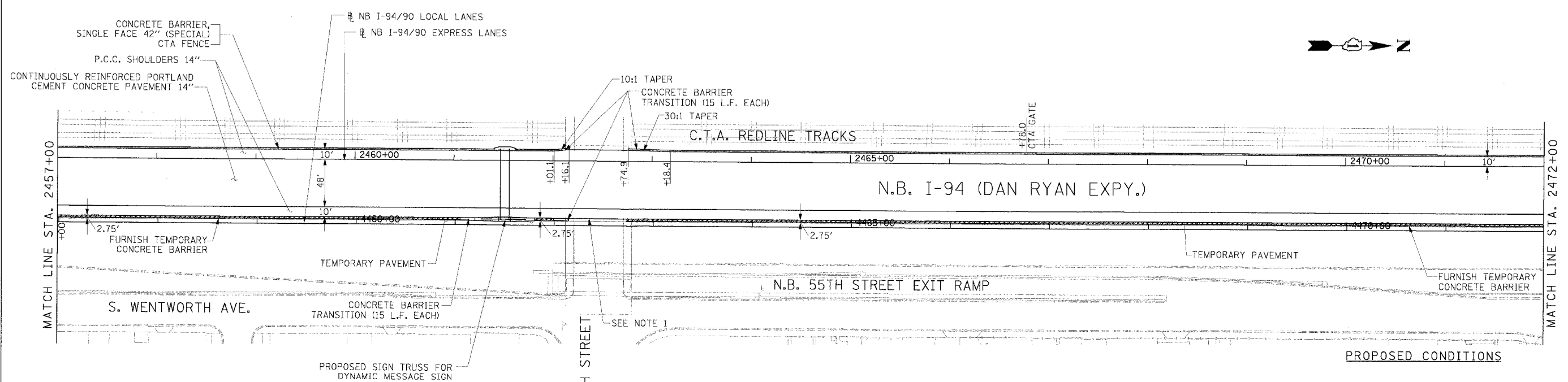

- LEGEND**
- TEMPORARY PAVEMENT (INTERSTATE)/TEMPORARY SHOULDER
 - TEMPORARY CONCRETE BARRIER

STATIONING

***.## STATION PROVIDED FROM THE I-90/94 EXPRESS LANES

(+##.##) STATION PROVIDED FROM THE I-90/94 LOCAL LANES

[+##.##] STATION PROVIDED FROM THE SLIP RAMP

REVISIONS	
NAME	DATE

ILLINOIS DEPARTMENT OF TRANSPORTATION
F.A.I. 94/90 (DAN RYAN EXPRESSWAY)
31ST STREET TO 71ST STREET
NB EXPRESS LANE RECONSTRUCTION
EXISTING AND PROPOSED PLAN
NORTHBOUND STA. 2457+00 TO STA. 2472+00

SCALE: 1"=50'
DATE: 7/1/05

DRAWN BY: TAI
CHECKED BY: PJM

NOTE:
1. BRIDGE OVER EXPRESS LANES OMITTED FOR CLARITY.

Edwards AND Kelcey
ONE NORTH FRANKLIN
CHICAGO, IL 60606
PHONE: (312) 251-3000
FAX: (312) 251-3015
WEB: WWW.EKCORP.COM

RDY-7

05/24/2005 10:58:42 AM