

F.A.I. RTE.	SECTION	COUNTY	TOTAL SHEETS	SHEET NO.
94/90		COOK	556	53
STA.		TO STA.		
FED. ROAD DIST. NO.		ILLINOIS	FED. AID PROJECT	
62300		(1818, ETC, 2324.6-1PR-8		

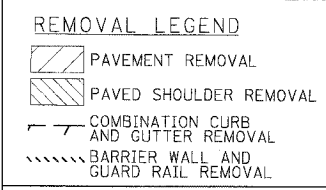

NOTE:
 1. THE LOCATION OF PAVEMENT CONSTRUCTED IN PREVIOUS CONTRACTS IS BASED OFF OF CONTRACT PLAN DRAWINGS. THE CONTRACTOR MUST VERIFY LIMITS OF PREVIOUS CONSTRUCTION IN THE FIELD.

EXISTING CONDITIONS & REMOVALS

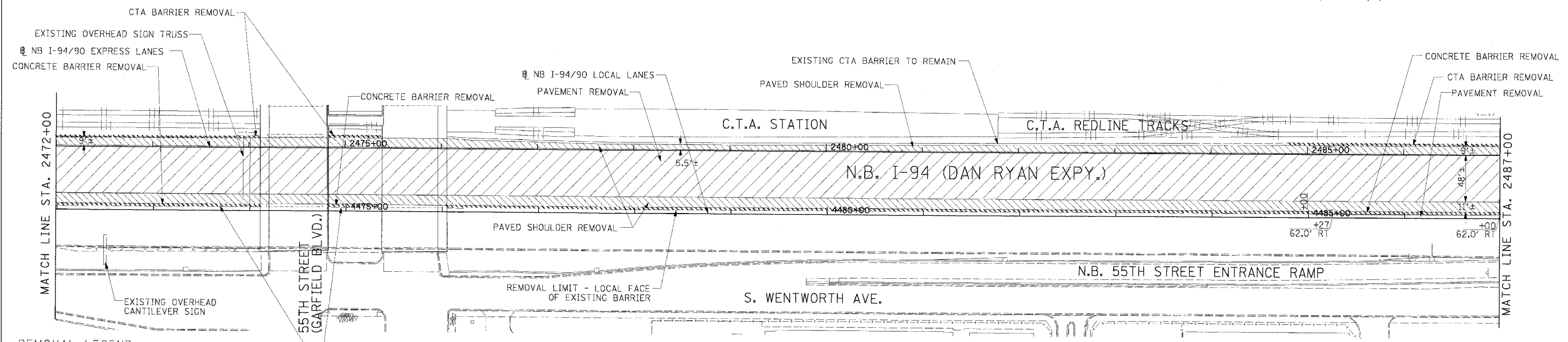
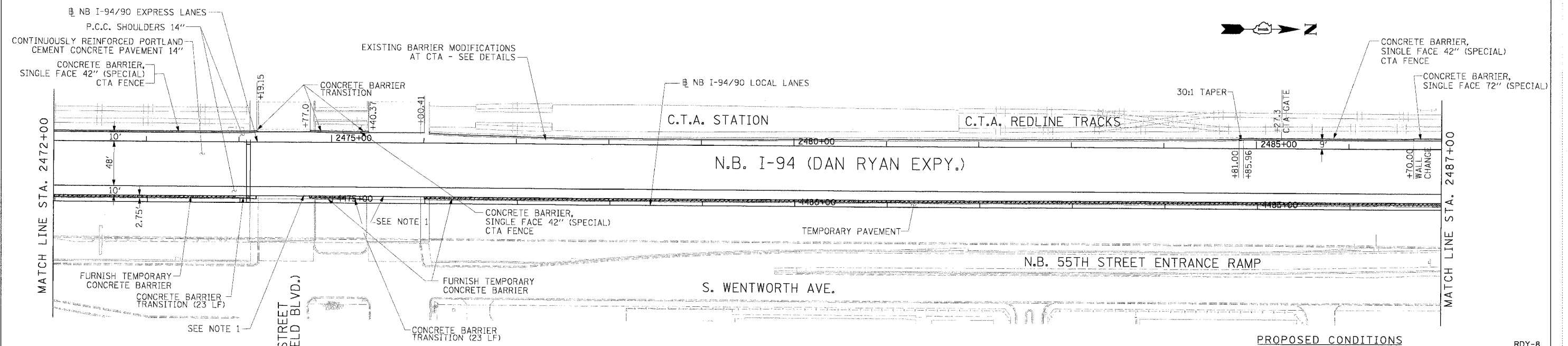

Edwards AND Kelcey
 ONE NORTH FRANKLIN
 CHICAGO, IL 60606
 PHONE: (312) 251-3000
 FAX: (312) 251-3015
 WEB: WWW.EKCORP.COM

NOTE:
 1. BRIDGE OVER EXPRESS LANES OMITTED FOR CLARITY.

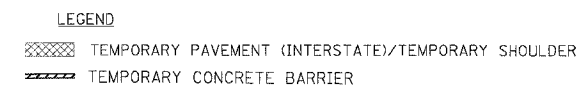

STATIONING
 +###.## STATION PROVIDED FROM THE NB I-90/94 EXPRESS LANES
 (+##.##) STATION PROVIDED FROM THE NB I-90/94 LOCAL LANES
 [###.##] STATION PROVIDED FROM THE SLIP RAMP NB

REVISIONS	
NAME	DATE

ILLINOIS DEPARTMENT OF TRANSPORTATION
 F.A.I. 94/90 (DAN RYAN EXPRESSWAY)
 31ST STREET TO 71ST STREET
 NB EXPRESS LANE RECONSTRUCTION
 EXISTING AND PROPOSED PLAN
 NORTHBOUND STA. 2472+00 TO STA. 2487+00
 SCALE: 1"=50'
 DATE: 7/1/05
 DRAWN BY: TAI
 CHECKED BY: PJM

66/2472005 10/5/05 RDY-8