

|                     |                           |                  |              |           |
|---------------------|---------------------------|------------------|--------------|-----------|
| F.A.I. RTE.         | SECTION                   | COUNTY           | TOTAL SHEETS | SHEET NO. |
| 94/90               |                           | COOK             | 556          | 247       |
| STA.                | TO STA.                   |                  |              |           |
| FED. ROAD DIST. NO. | ILLINOIS                  | FED. AID PROJECT |              |           |
| 62300               | 11818, ETC, 2324.6-1P1R-8 |                  |              |           |

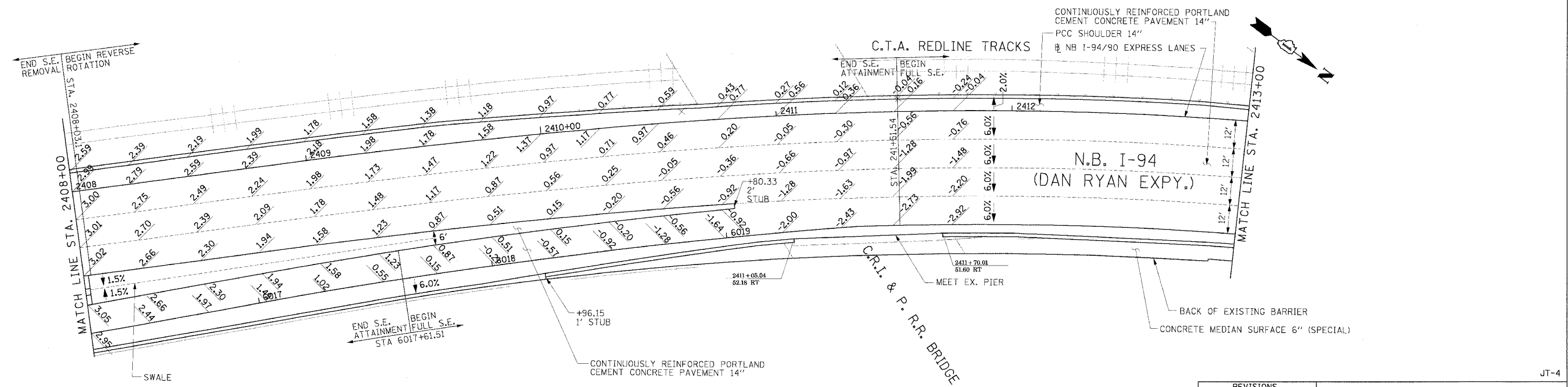
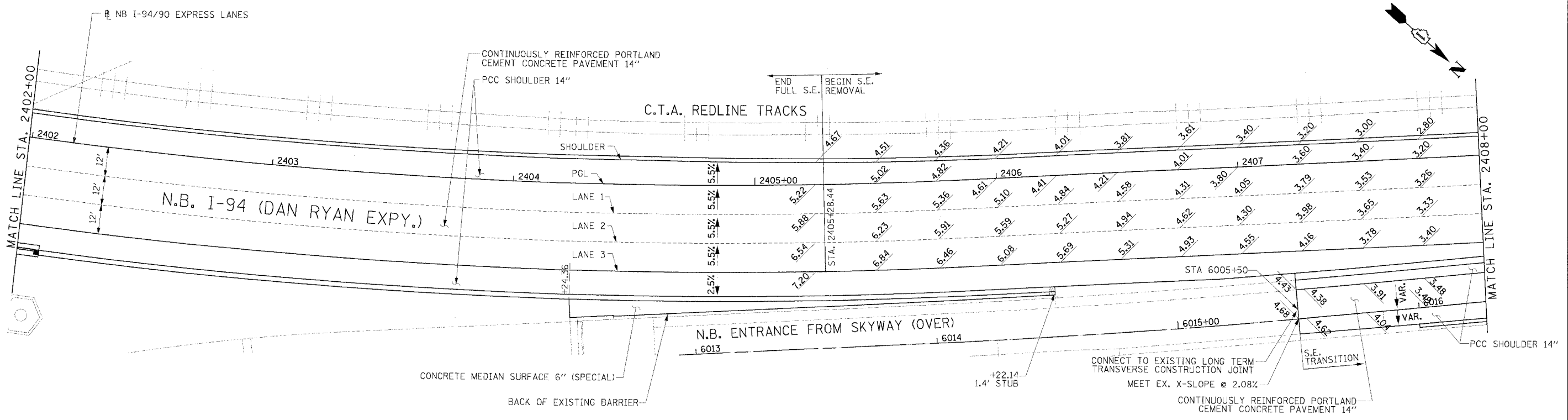

**Edwards AND Kelcey**  
 ONE NORTH FRANKLIN  
 CHICAGO, IL 60606  
 PHONE: (312) 251-3000  
 FAX: (312) 251-3015  
 WEB: WWW.EDWARDSKELCEY.COM

**LEGEND**  
 [\*\*\*] ELEVATION STATIONED OFF OF NB I-94/90 EXPRESS LANES  
 [\*\*]\*\* ELEVATION STATIONED OFF OF SB I-94/90 LOCAL LANES  
 [\*\*\*] ELEVATION STATIONED OFF OF SLIP RAMP ALIGNMENT

**NOTE:**  
 1. PAVEMENT ELEVATIONS ALONG RAMPS, GORES AND IN AREAS OF SUPERELEVATION TRANSITION ARE PROVIDED AT 25' INTERVALS. FOR ALL OTHER ELEVATIONS, REFER TO PROFILE AND TYPICAL SECTIONS.

| REVISIONS |      |
|-----------|------|
| NAME      | DATE |
|           |      |
|           |      |
|           |      |
|           |      |
|           |      |

ILLINOIS DEPARTMENT OF TRANSPORTATION  
 F.A.I. 94/90 (DAN RYAN EXPRESSWAY)  
 31ST STREET TO 71ST STREET  
 NB EXPRESS LANE RECONSTRUCTION  
 PAVEMENT JOINING AND ELEVATION PLAN  
 NORTHBOUND STA. 2402+00 TO STA. 2413+00  
 SCALE: 0' 10' 20' 30' 40'  
 DATE: 7/7/05  
 DRAWN BY: TAI  
 CHECKED BY: PJM

JT-4  
 06/24/2005 12:56:33 PM