

F.A.I. RTE.	SECTION	COUNTY	TOTAL SHEETS	SHEET NO.
94/90		COOK	556	253
STA.	TO STA.			
62300	(1818, ETC, 2324.6-1PIR-8			
FED. ROAD DIST. NO.	ILLINOIS	FED. AID PROJECT		

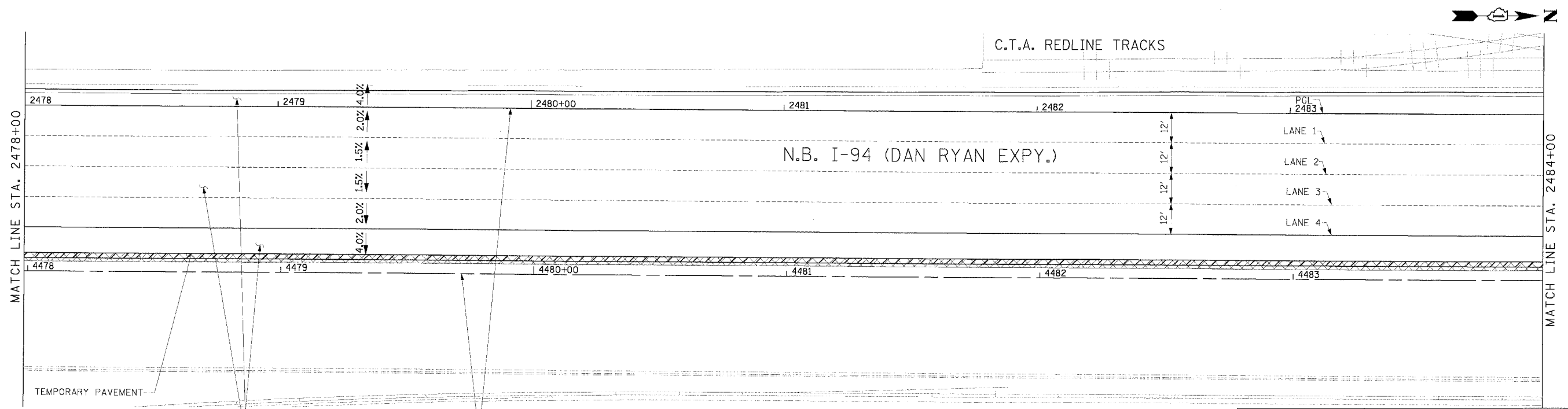
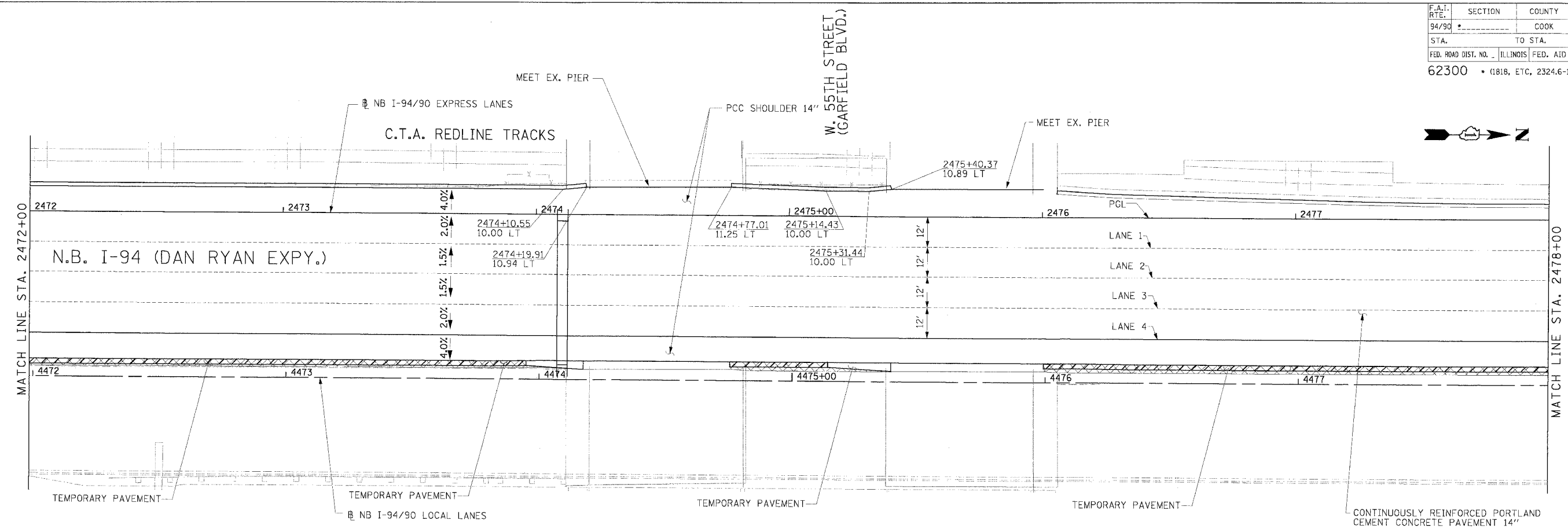

**LEGEND**

- ### ELEVATION STATIONED OFF OF NB I-94/90 EXPRESS LANES
- (#.#) ELEVATION STATIONED OFF OF NB I-94/90 LOCAL LANES
- [#.#] ELEVATION STATIONED OFF OF SLIP RAMP ALIGNMENT

**NOTE:**

1. PAVEMENT ELEVATIONS ALONG RAMPS, CORES AND IN AREAS OF SUPERELEVATION TRANSITION ARE PROVIDED AT 25' INTERVALS. FOR ALL OTHER ELEVATIONS, REFER TO PROFILE AND TYPICAL SECTIONS.

REVISIONS	
NAME	DATE

ILLINOIS DEPARTMENT OF TRANSPORTATION  
 F.A.I. 94/90 (DAN RYAN EXPRESSWAY)  
 31ST STREET TO 71ST STREET  
 NB EXPRESS LANE RECONSTRUCTION  
 PAVEMENT JOINTING AND ELEVATION PLAN  
 NORTHBOUND STA. 2472+00 TO STA. 2484+00  
 SCALE: 0' 10' 20' 30' 40'  
 DATE: 7/7/05  
 DRAWN BY: TAI  
 CHECKED BY: PJM

**Edwards AND Kelcey**  
 ONE NORTH FRANKLIN  
 CHICAGO, IL 60606  
 PHONE: (312) 251-3000  
 FAX: (312) 251-3015  
 WEB: WWW.EDWARDSKELCEY.COM

JT-10

06/24/2005 12:05:02 PM