

F.A.I. RTE.	SECTION	COUNTY	TOTAL SHEETS	SHEET NO.
94/90		COOK	556	323
STA. 1388+00		TO STA. 1398+00		
FED. ROAD DIST. NO.	ILLINOIS	FED. AID PROJECT		
62300		1818, ETC. 2324.6-1P1R-8		

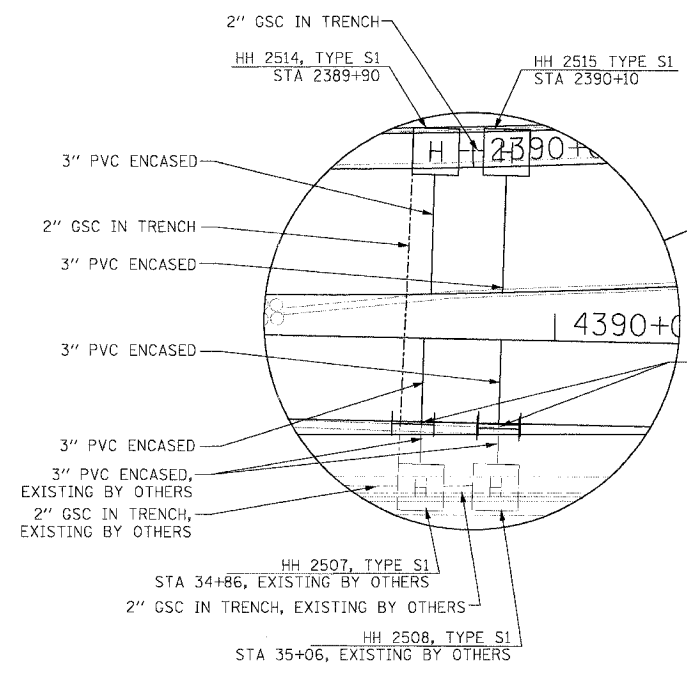

3" PVC CONDUIT SHOWN TO CONNECT TO EXISTING CONDUIT. PROPER INSTALLATION OF CONDUIT FROM HANDHOLE TO CAP TO BE CONFIRMED PER THE SPECIAL PROVISIONS.

REFER TO DRAWING DET-24

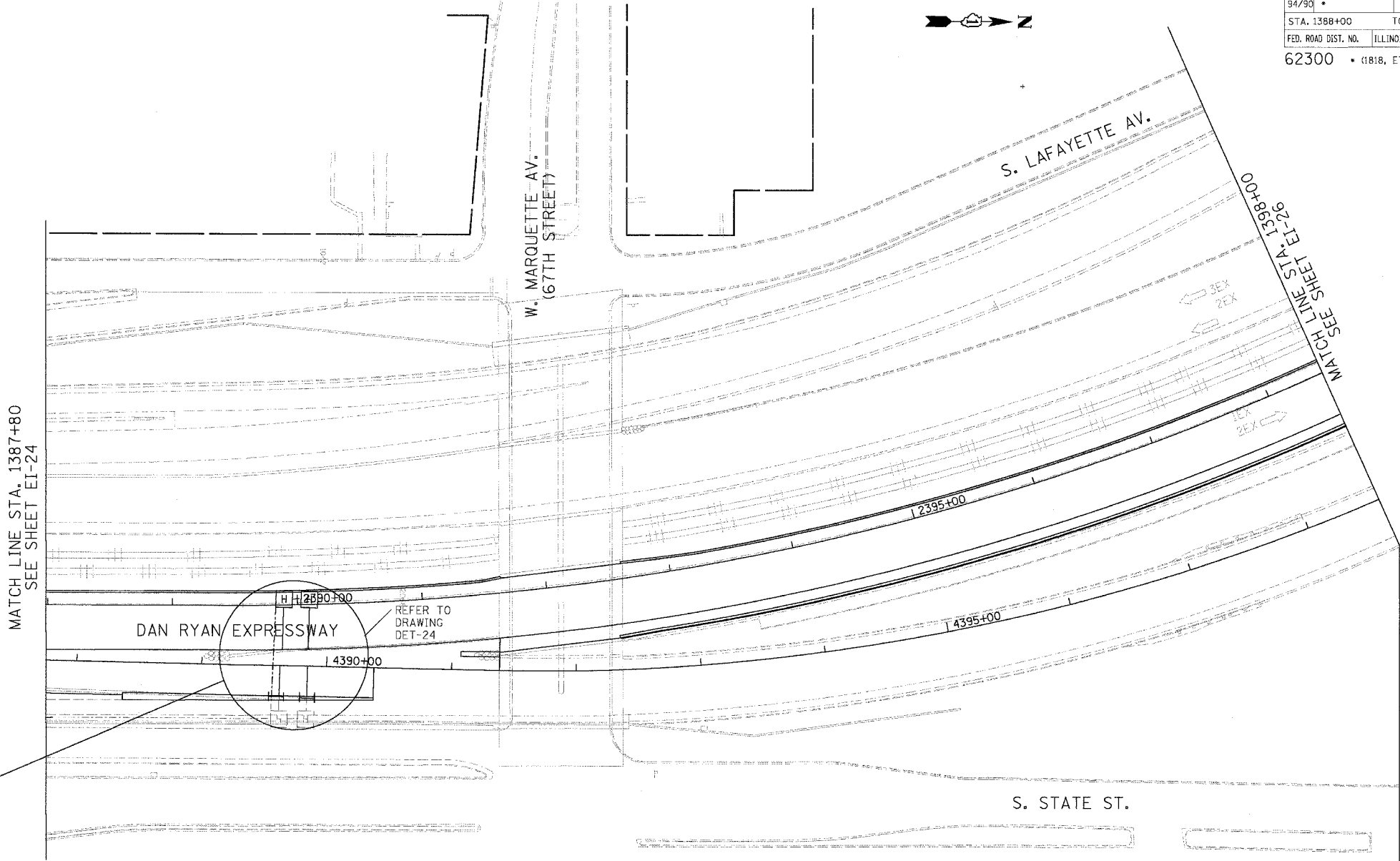
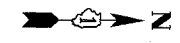
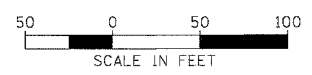

EI-25

- NOTES:
- SEE DRAWING EI-100 AND EI-101 FOR ELECTRICAL SYSTEMS AND ABBREVIATIONS.
  - UNLESS OTHERWISE STATED, ALL NOTED CABLE TO BE FURNISHED AND INSTALLED UNDER ANOTHER CONTRACT.
  - TRENCHED CONDUITS INSTALLED IN PARALLEL ARE TO BE INSTALLED IN COMMON TRENCH.
  - THIS SHEET ONLY DEPICTS INSTALLATION OF DETECTION/RAMP METER ELEMENTS. REFER TO SHEETS FOR OTHER SUBSYSTEMS FOR ADDITIONAL ELEMENTS IN THE AREA SHOWN.
  - DETECTOR LOOPS INSTALLED BY OTHERS.

REVISIONS	
NAME	DATE

ILLINOIS DEPARTMENT OF TRANSPORTATION  
 F.A.I. 94/90 (DAN RYAN EXPRESSWAY)  
 31ST STREET TO 71ST STREET  
 NB EXPRESS LANE RECONSTRUCTION  
 ELECTRICAL INFRASTRUCTURE PLAN  
 NORTHBOUND STA. 1387+80 TO 1398+00

SCALE: 1"=50'  
 DATE: 7/7/05  
 DRAWN BY: CJH  
 CHECKED BY: MJL

**Edwards and Kelcey**  
 ONE NORTH FRANKLIN  
 CHICAGO, IL 60606  
 PHONE: (312) 251-3000  
 FAX: (312) 251-3015  
 WEB: WWW.EKCORP.COM

06/24/2005 04:08:31 PM