

**SECTION E-E**  
(Opposite Wall Typical)

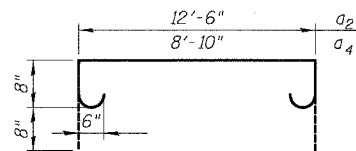

**BARS a<sub>2</sub> and a<sub>4</sub>**

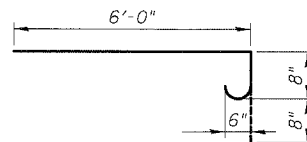

**BAR a<sub>3</sub>**

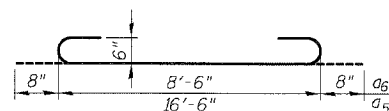

**BARS a<sub>5</sub> and a<sub>6</sub>**

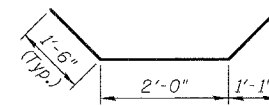

**BAR h<sub>1</sub>**

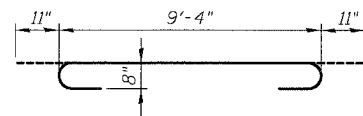

**BAR h<sub>2</sub>**

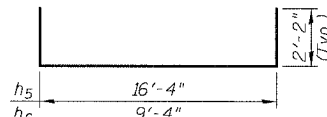

**BARS h<sub>5</sub> and h<sub>6</sub>**

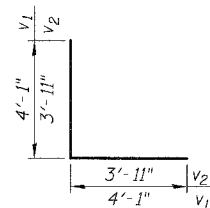

**BARS v<sub>1</sub> and v<sub>2</sub>**

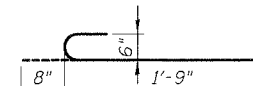

**BAR d**

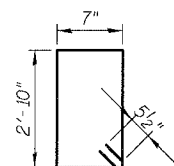

**BAR s<sub>4</sub>**

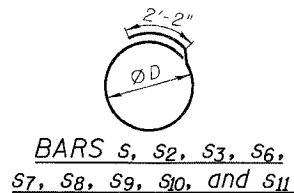

**BARS s<sub>1</sub>, s<sub>2</sub>, s<sub>3</sub>, s<sub>6</sub>, s<sub>7</sub>, s<sub>8</sub>, s<sub>9</sub>, s<sub>10</sub>, and s<sub>11</sub>**

Pipe Sizes	Opening Size	φ	Bar
-	36"	39"	s <sub>1</sub>
15"	20"	23"	s <sub>2</sub>
30"	37"	40"	s <sub>3</sub>
36"	44"	47"	s <sub>6</sub>
42"	51"	54"	s <sub>7</sub>
12"	16"	19"	s <sub>8</sub>
-	24"	27"	s <sub>9</sub>
24"	30"	33"	s <sub>10</sub>
27"	34"	37"	s <sub>11</sub>

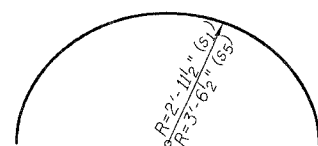

**BARS s<sub>1</sub> and s<sub>5</sub>**

**NOTES:**

- For Pipe Openings and dimensions c and d, see "Table of Junction Chamber Information" on Sheet JC-2.
- All dimensions and elevations shall be field verified prior to construction.
- Concrete pipe sizes shall be coordinated with openings provided into junction chamber before pouring concrete.
- Manhole Frame, Ladder Rungs and any inserts installation shall be coordinated with Drainage Plans.
- Concrete cover for reinforcement steel to be 2" unless otherwise noted.
- v<sub>3</sub> Bars are for pipes 27"φ or larger. v<sub>4</sub> Bars are for 12"φ, 15"φ and 24"φ pipes.
- Any annular space left between the pipes and the Junction Chamber walls shall be filled with an approved non-shrink grout as directed by the Engineer.
- All lap splices marked on the drawings are minimum.
- Cut bars in field to fit pipe openings as necessary.
- The Concrete Structures and Reinforcement Bars quantities shown are for estimating purposes only. Quantity for concrete is calculated based on 3' φ Drop Shaft but without subtracting volume removed due to pipe openings in walls.

**JUNCTION CHAMBER  
BAR SCHEDULE**

Bar	No.	Size	Length	Shape
a	12	#5	16'-6"	—
a <sub>1</sub>	7	#5	9'-10"	—
a <sub>2</sub>	10	#6	15'-2"	U
a <sub>3</sub>	4	#6	7'-4"	U
a <sub>4</sub>	5	#6	11'-6"	U
a <sub>5</sub>	10	#6	17'-10"	U
a <sub>6</sub>	5	#6	9'-10"	U
a <sub>7</sub>	3	#5	8'-6"	—
a <sub>8</sub>	48	#5	5'-11"	—
a <sub>9</sub>	8	#5	6'-0"	—
d	17	#6	2'-5"	U
h	73	#6	9'-4"	—
h <sub>1</sub>	28	#5	5'-0"	U
h <sub>2</sub>	65	#8	11'-2"	U
h <sub>3</sub>	14	#5	9'-4"	—
h <sub>4</sub>	14	#5	16'-4"	—
h <sub>5</sub>	14	#5	20'-8"	U
h <sub>6</sub>	14	#5	13'-8"	U
s	52	#5	12'-4"	O
s <sub>1</sub>	14	#5	9'-3"	O
s <sub>2</sub>	4	#5	7'-0"	O
s <sub>3</sub>	12	#5	11'-7"	O
s <sub>4</sub>	8	#5	7'-9"	O
s <sub>5</sub>	8	#5	11'-2"	O
s <sub>6</sub>	10	#5	13'-4"	O
s <sub>7</sub>	6	#5	15'-3"	O
s <sub>8</sub>	18	#5	6'-1"	O
s <sub>9</sub>	14	#5	8'-2"	O
s <sub>10</sub>	4	#5	9'-9"	O
s <sub>11</sub>	2	#5	10'-9"	O
v	116	#6	7'-0"	—
v <sub>1</sub>	36	#7	8'-2"	L
v <sub>2</sub>	80	#7	7'-10"	L
v <sub>3</sub>	240	#6	8'-0"	—
v <sub>4</sub>	208	#6	4'-3"	—
Concrete Structures			Cu. Yd.	24.3
Reinforcement Bars			Pound	9,330

① Bars indicated are for all Junction Chambers. Use Bar at appropriate opening. Weight of Reinforcement Bars indicated is for JC T2 17-01.

- \* - Cut bars to fit in field.
- E.F. - denotes Each Face
- E.S. - denotes Each Side
- I.F. - denotes Inside Face
- O.F. - denotes Outside Face

REVISIONS	
NAME	DATE

SHEET JC-5 OF JC-22  
ILLINOIS DEPARTMENT OF TRANSPORTATION  
F.A.I. 94/90 (DAN RYAN EXPRESSWAY)  
31ST STREET TO 71ST STREET  
NB EXPRESS LANE RECONSTRUCTION  
JUNCTION CHAMBER, TYPE 2  
REINFORCEMENT DETAILS 3  
SCALE: N.T.S. DRAWN BY: DJM  
DATE: 07/07/05 CHECKED BY: BLU