

STATE OF ILLINOIS
DEPARTMENT OF TRANSPORTATION

F.A.I. RTE.	SECTION	COUNTY	TOTAL SHEETS	SHEET NO.
90/94		COOK	556	447
STA.	TO STA.			
FED. ROAD DIST. NO. 1 ILLINOIS FED. AID PROJECT				
• (1818, ETC, 2324.6-1PIR-8 62300				

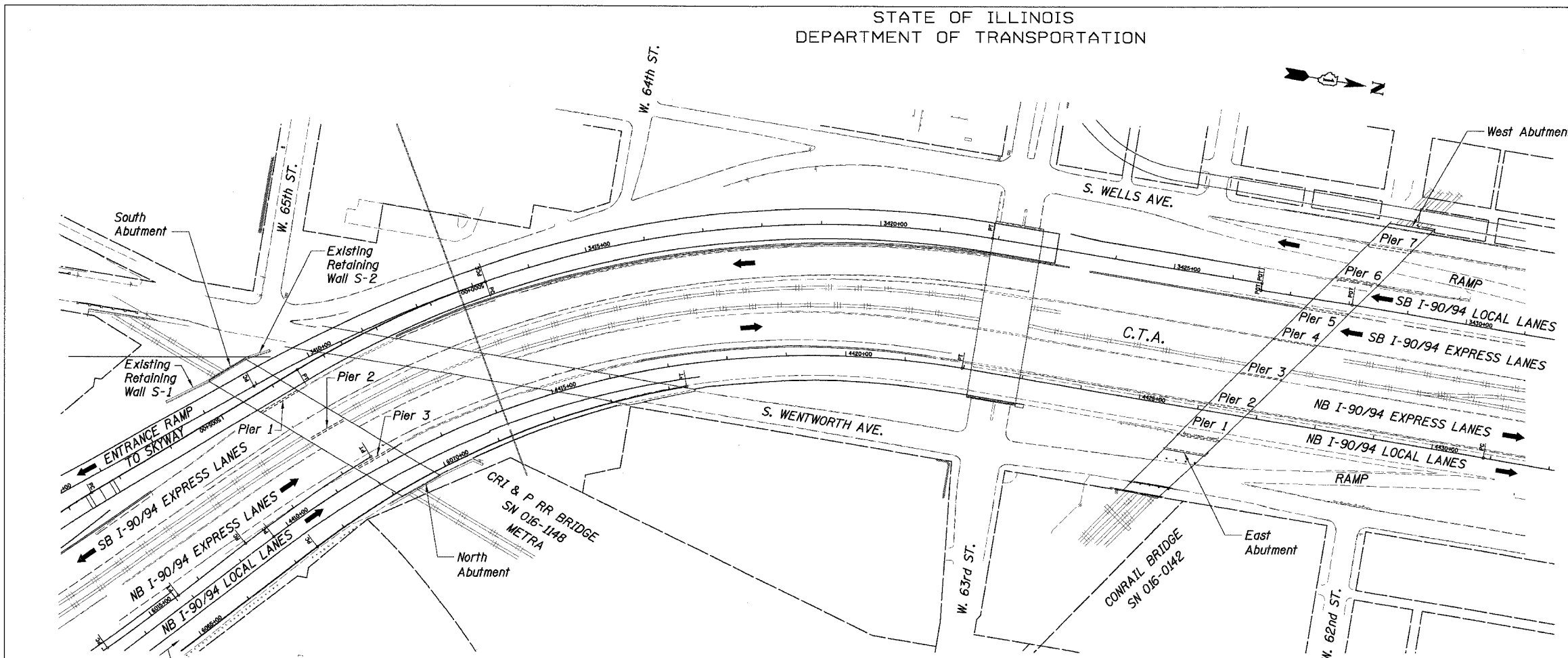

PLAN

Item	Unit	Quantity
Formed Concrete Repair (Depth Equal to or Less Than 5")	Sq Ft	1,219
Formed Concrete Repair (Depth Greater Than 5")	Sq Ft	44
Epoxy Crack Sealing	LF	275
Railroad Protective Liability Insurance	LS	0.2
Protective Coat	Sq Yd	140

S1	General Plan
S2	Pier 2 - Plan and Elevation (SN 016-1148)
S3	Pier 3 - Plan and Elevation (SN 016-1148)
S4	Pier 2 - Plan and Elevation (SN 016-0142)
S5	Piers 3 & 4 - Plan and Elevation (SN 016-0142)

DESIGN SPECIFICATIONS
2002 AASHTO, Standard Specifications for Highway Bridges

DESIGN STRESSES
f'c = 3,500 psi
fy = 60,000 psi (Reinf.)

- SUBSTRUCTURE REPAIR WORK ITEMS**
- Metra Railroad Bridge (SN 016-1148)
 - Pier 2 Repairs (North and South Face)
 - Pier 3 Repairs (South Face)
 - Conrail Railroad Bridge (SN 016-0142)
 - Pier 2 Repairs (West Face)
 - Pier 3 Repairs (East and West Face)
 - Pier 4 Repairs (East Face)

GENERAL NOTES:

- Pier Repair Locations and Quantities are estimated. The necessary adjustments based on current field conditions will be made at time of construction. However, such variations shall not be cause for additional compensation for a change in the Scope of Work; however, the Contractor will be paid for the quantity actually furnished at the Unit Price bid for the Work.
- Delaminated and spalled areas of concrete shall be repaired by utilizing formed concrete repair and described in the Specifications as Formed Concrete Repair.
- Cracks shall be repaired by utilizing the Epoxy Crack Sealing and described in Section 590 of the Standard Specifications as Epoxy Crack Sealing.
- The approximate location of the downspout is shown in the Elevation. If repairs are to be made near the attachments of the downspout, the downspout shall be detached before making the repairs. The Contractor shall reattach the downspout. The cost of the detachment and reattachment of the downspouts to the Piers shall be incidental to the Formed Concrete Repair.
- Existing rustication shall be maintained and re-established in new repair areas.
- The Contractor shall provide Railroad Protective Liability Insurance in accordance with Articles 107.11 and 107.12 of the Standard Specifications for all Railroad Highway Crossings and the Chicago Transit Authority (CTA). The CTA has additional requirements as shown in the "CTA Coordination" provision as shown in the Contract Special Provisions.

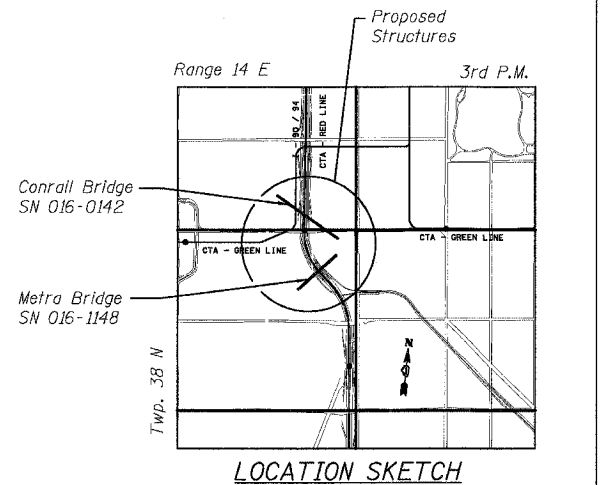

LOCATION SKETCH

Clean and incorporate existing Reinforcement Bars. Reinforcement Bars that have been cut or have lost 25% or more of their original cross sectional area shall be supplemented by new Epoxy Coated Reinforcement Bars.

Apply a protective coat to the exposed surface of all Formed Concrete Repairs in accordance with Article 503.19 of the Standard Specifications

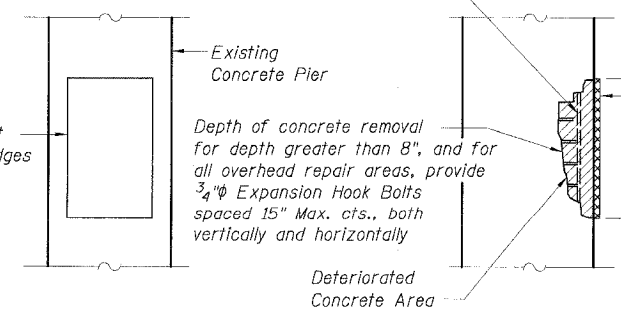

FORMED CONCRETE REPAIR DETAIL

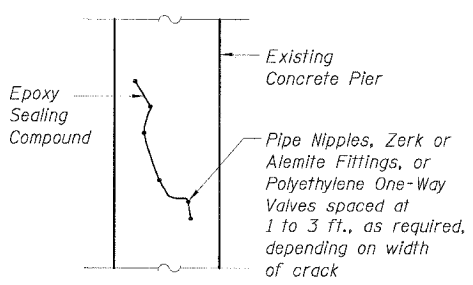

EPOXY CRACK SEALING DETAIL

CTE | AECOM

300 East Madison Drive, Suite 600, Chicago, Illinois 60601-0216
T 312.258.6300 F 312.258.3163 www.cteaecom.com

NAME	DATE

Sheet S1 of 5
ILLINOIS DEPARTMENT OF TRANSPORTATION
F.A.I. 90/94 (DAN RYAN EXPRESSWAY)
**GENERAL PLAN
SUBSTRUCTURE REPAIRS
METRA BRIDGE (SN 016-1148) AND
CONRAIL BRIDGE (SN 016-0142)
COOK COUNTY**
SCALE: None
DATE: JULY 7, 2005
DRAWN BY: CHD
CHECKED BY: MJP

P:\V-40485\Structure & -DWG\CHD - DWG\CHD - 62300-04 - BridgeRepair\VT 050012A-62-001.dwg 6/24/2005 2:20:13 PM