

**REMOVAL LEGEND**

- PAVEMENT REMOVAL
- PAVED SHOULDER REMOVAL
- COMBINATION CURB AND GUTTER REMOVAL
- CONCRETE BARRIER OR GUARD RAIL REMOVAL

**NOTE:**  
1. THE LOCATION OF PAVEMENT CONSTRUCTED IN PREVIOUS CONTRACTS IS BASED OFF OF CONTRACT PLAN DRAWINGS. THE CONTRACTOR MUST VERIFY LIMITS OF PREVIOUS CONSTRUCTION IN THE FIELD.

EXISTING CONDITIONS & REMOVALS

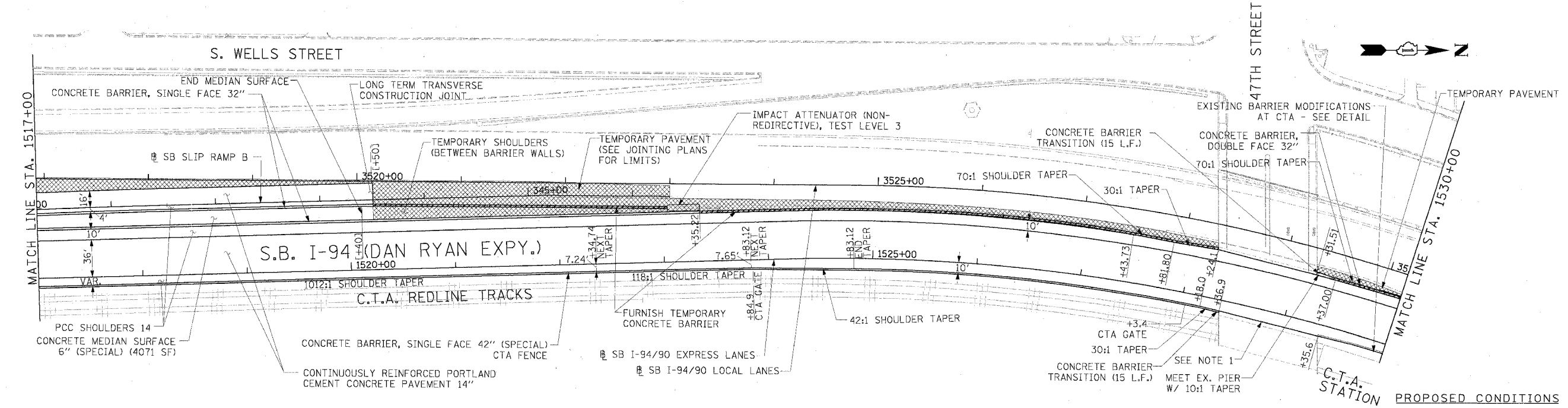

**LEGEND**

- TEMPORARY PAVEMENT (INTERSTATE)/TEMPORARY SHOULDER

**STATIONING**

- [+###.##] STATION PROVIDED FROM THE I-90/94 EXPRESS LANES
- [###.##] STATION PROVIDED FROM THE I-90/94 LOCAL LANES
- [+###.##] STATION PROVIDED FROM THE SLIP RAMP

REVISIONS	
NAME	DATE

ILLINOIS DEPARTMENT OF TRANSPORTATION  
**F.A.I. 94/90 (DAN RYAN EXPRESSWAY)**  
 31ST STREET TO 71ST STREET  
 SB EXPRESS LANE RECONSTRUCTION  
 EXISTING AND PROPOSED PLAN  
 SOUTHBOUND STA. 1517+00 TO STA. 1530+00

SCALE: 1"=50'  
 DATE: 7/7/05 DRAWN BY: TAI  
 CHECKED BY: PJM

**Edwards AND Kelcey**  
 ONE NORTH FRANKLIN  
 CHICAGO, IL 60606  
 PHONE: (312) 251-3000  
 FAX: (312) 251-3015  
 WEB: WWW.EKCORP.COM

**NOTE:**  
1. BRIDGE OVER EXPRESS LANES OMITTED FOR CLARITY.

RDY-11

06/24/2005 09:27:01 AM